



# HARDINGS



Gallys Road  
Offers Over £400,000





A light and well presented end of terrace 2 bedroom townhouse offering flexible living accommodation arranged over 3 floors. Ideally located for access to local amenities, the property further benefits from off street parking for several cars, low maintenance courtyard garden and spacious open plan kitchen/dining room.

Energy Efficiency Rating		
	Current	Potential
<i>Very energy efficient - lower running costs</i>		
(92 plus) <b>A</b>		<b>91</b>
(81-91) <b>B</b>		
(69-80) <b>C</b>	<b>75</b>	
(55-68) <b>D</b>		
(39-54) <b>E</b>		
(21-38) <b>F</b>		
(1-20) <b>G</b>		
<i>Not energy efficient - higher running costs</i>		
<b>England &amp; Wales</b>	EU Directive 2002/91/EC 	

## Features

- 2 Bedroom End of Terrace Townhouse
- Off Street Parking for Several Cars
- Ideally Positioned for Local Amenities
- Spacious Open Plan Kitchen/Dining Room
- Low Maintenance Courtyard Garden
- Light & Well Presented Accommodation

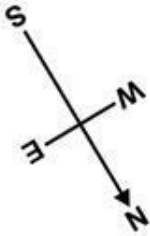

Denotes restricted head height

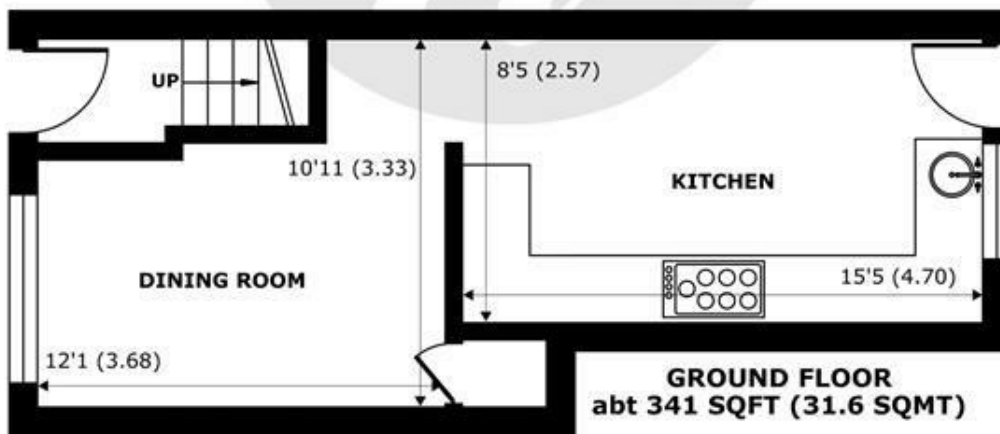
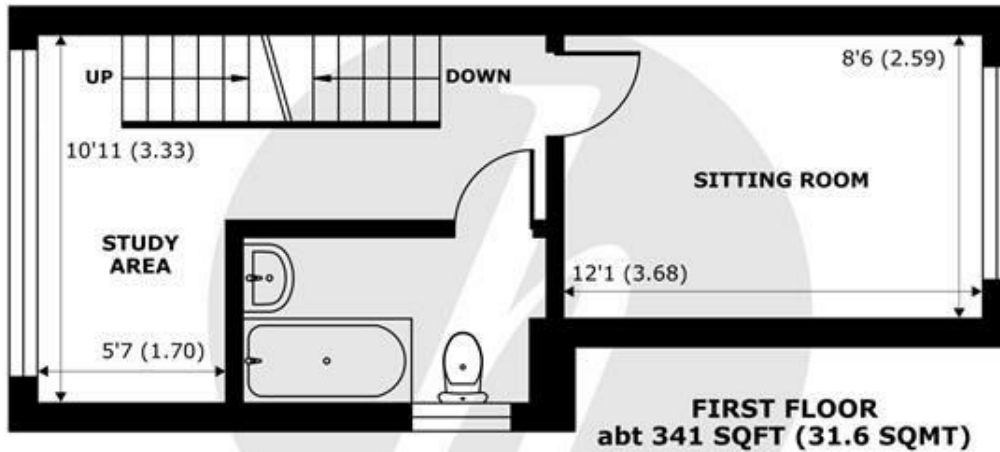
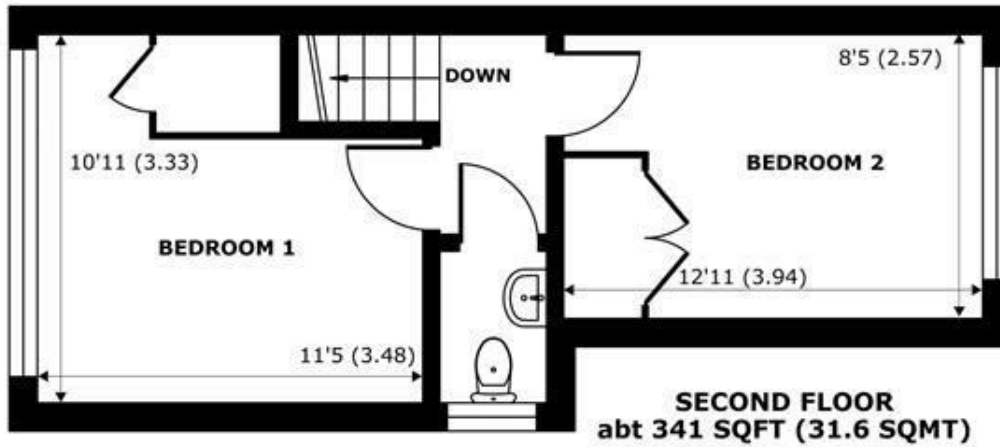

## Gallys Road, Windsor, SL4

Approximate Internal Area = 819 sq ft / 76 sq m  
Approximate External Area = 1023 sq ft / 95 sq m

For identification only - Not to scale



Floor plan produced in accordance with RICS Property Measurement Standards incorporating International Property Measurement Standards (IPMS2 Residential). © nichecom 2023. Produced for Hardings. REF: 957744





11 High Street, Windsor, Berkshire, SL4 1LD,  
T: 01753 833 118 | E: info@hardings.co.uk  
www.hardings.co.uk

