



# HARDINGS



Whistler Mews  
£1,250 Per Month



A recently built, one bedroom ground floor maisonette within walking distance to Windsor town centre. Offered on a unfurnished basis.

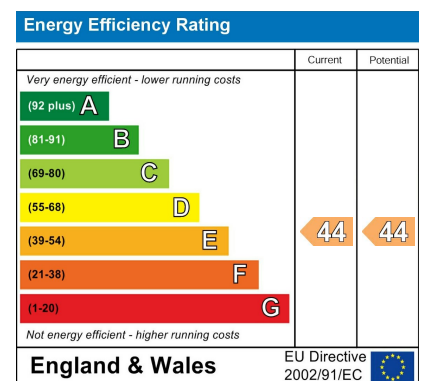

## Features

- New build maisonette
- Contemporary finish
- Unfurnished
- Tax Band C & EPC E
- One bedroom
- Open plan kitchen/diner
- Close to local shops and town centre

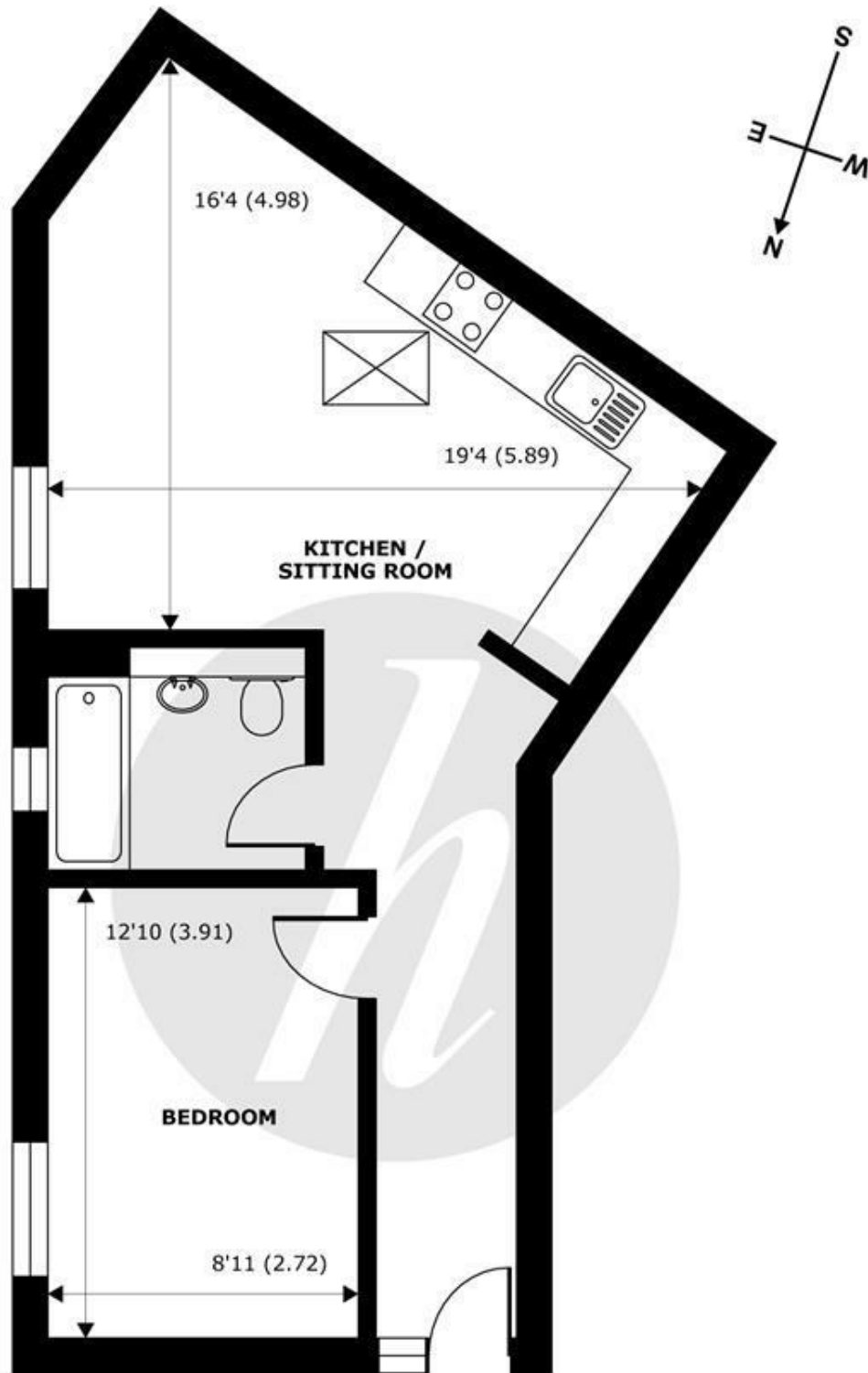

**GROUND FLOOR**  
abt 483 SQFT (44.8 SQMT)

## Whistler Mews Windsor, SL4

Approximate Internal Area = 483 sq ft / 44.8 sq m

Approximate External Area = 586 sq ft / 54.4 sq m

For identification only - Not to scale



Floor plan produced in accordance with RICS Property Measurement Standards incorporating International Property Measurement Standards (IPMS2 Residential). © n\checon 2021. Produced for Hardings. REF: 789451



11 High Street, Windsor, Berkshire, SL4 1LD,  
T: 01753 833 118 | E: [info@hardings.co.uk](mailto:info@hardings.co.uk)  
[www.hardings.co.uk](http://www.hardings.co.uk)

