

HARRISON  
Sales &  
Lettings  
HARDIEN



Beechcraft Road, Upper Rissington



A beautifully well-maintained four bed detached house situated in the popular Cotswold village of Upper Rissington.

The property briefly comprises an entrance hallway with cloakroom and storage cupboards leading on to the kitchen and the lounge/diner. The kitchen is modern with integrated units and the lounge/diner is a very generous sized room suitable for families with double doors which open out to the rear garden. Upstairs there are four bedrooms and a family bathroom, the Principle Bedroom also benefits from an en-suite shower room.

The well-sized garden to the rear is mainly laid to lawn and also has a patio area which is perfect for entertaining. Further back in the garden is a space with raised beds.

The property has gas central heating, double glazing throughout and parking for two cars with a single garage.

EPC: B

Council Tax Band: D

Tenure: Freehold

Upper Rissington occupies an elevated location between the Windrush and Evenlode Valleys and offers easy access to the A424 Stow on the Wold/Burford road as well as Bourton on the Water. Upper Rissington has a fantastic new shop, pharmacy, gym and cafe as well as a brand new village hall. There is also the OUTSTANDING Rissington Primary School. Further facilities and schools can be found in both Bourton on the Water, Stow on the Wold and Burford. A bus service links the village to the local schools at Bourton on the Water, as well as wider destinations.





# Beechcraft Road, Upper Rissington, Cheltenham, GL54

Approximate Area = 1008 sq ft / 93.6 sq m

For identification only - Not to scale

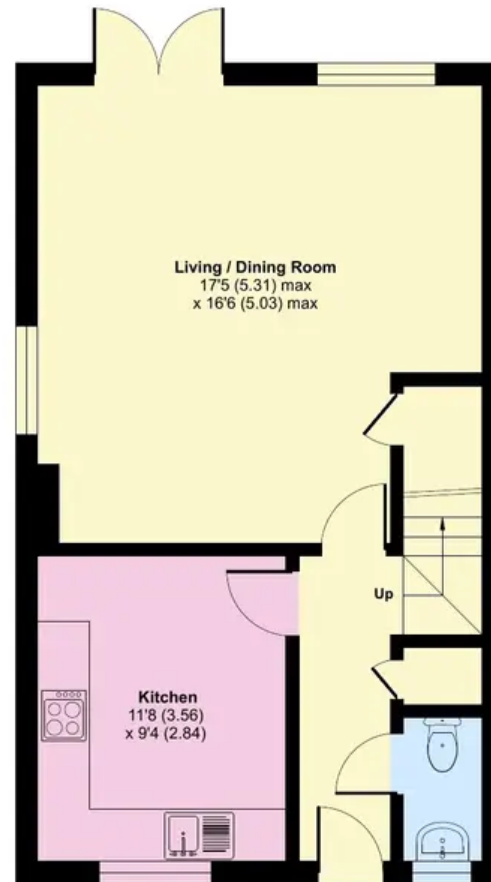

GROUND FLOOR

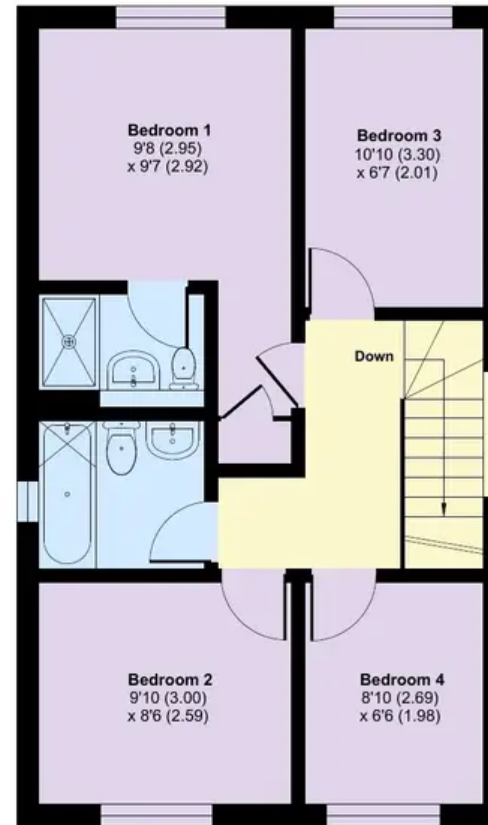

FIRST FLOOR



Floor plan produced in accordance with RICS Property Measurement Standards incorporating International Property Measurement Standards (IPMS2 Residential). © ntxhcom 2024. Produced for Harrison Hardie. REF: 1144915



**Harrison Hardie**

High Street, Bourton-on-the-Water, GL54 2AN

[harrisonhardie.co.uk](http://harrisonhardie.co.uk) 01451 822977