



HARRISON
Sales &
Lettings
HARDIE

Warneford Place, Moreton-In-Marsh

Moreton-In-Marsh



A spacious, light and well-presented south-facing two bedroom semi-detached extended family house situated within walking distance of the town centre. Through the front door on the ground floor you enter the dining room area with wood-burning stove, sitting room with patio doors that open to the large south-facing rear garden, kitchen with pantry, downstairs shower room and utility area. On the first floor there are two double bedrooms, modern bathroom with a deep free standing bath.

Outside the front of the property is a gated driveway with space for ample off-street parking; there is also hardstanding in place for a garage.

To the rear, a very sunny, large, mature garden with access to the allotments.

We understand the property to be Freehold. Potential purchasers should obtain confirmation of this from their solicitor prior to exchange of contracts.

Moreton in Marsh has been a prosperous market town for many years - and the commercial tradition continues today, with weekly Tuesday markets and a thriving high street that provides residents with a wide range of amenities. The town enjoys excellent public transport links including a direct rail link to London Paddington (via Oxford), and amenities include two large supermarkets, two smaller food stores and a variety of tearooms, cafes, shops, and pubs. Moreton in Marsh has a local primary school in the town (St David's Church of England), and is within the catchment area for both Chipping Campden School and The Cotswold School in Bourton on the Water, both secondary schools.





Main House Approx. Gross Internal Area:- 109.88 sq.m. 1183 sq.ft.
Total Approx. Gross Area:- 109.88 sq.m. 1183 sq.ft.



Ground Floor

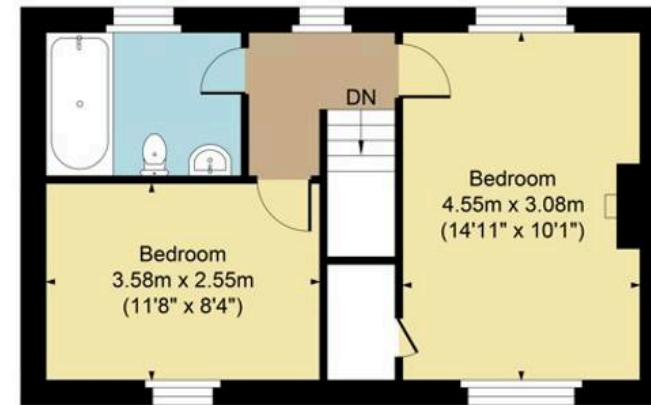

First Floor

FOR ILLUSTRATIVE PURPOSES ONLY-NOT TO SCALE
The position & size of doors, windows, appliances and other features are approximate only.
□ □ □ Denotes restricted head height
www.dmlphotography.co.uk