

HARRISON
Sales &
Lettings
HARDENSON



Stirling Way, Moreton-In-Marsh

Moreton-In-Marsh



A well-presented modern semi-detached property set within the popular development of Moreton Park.

The accommodation has been well maintained over the years and is ideal as a home or as an investment property.

In brief, the property comprises: entrance hall, sitting room, kitchen with utility area, downstairs cloakroom, two bedrooms and bath/shower room.

The property also benefits from off road parking to the side which can accommodate 2-3 cars and a private enclosed garden which has been laid predominantly to lawn with a patio area, shed and raised planter beds.

Tenure: We believe the property to be **Freehold**. Potential purchasers should obtain confirmation of this from their solicitor prior to exchange of contracts.



Moreton in Marsh is a north Cotswold town offering a broad range of local amenities, with library, post office, primary school, North Cotswold Hospital, sports facilities and swimming pool open to the public at the renowned Fire College, pubs, hotels and many specialist shops. Moreton in Marsh is also host of the largest street market in the Cotswolds which runs every Tuesday, is a stones throw away from Batsford Arboretum and Gardens and the Cotswold Falconry Centre, with the award winning Daylesford Organic Farm and Stores just around the corner. Moreton In Marsh also has its train station, with a direct line running regularly between Worcester and London Paddington.



6A Stirling Way, Moreton, GL56 0GS
Main House Approx. Gross Internal Area:- 63.6 sq.m. 685 sq.ft.
Total Approx. Gross Area:- 63.6 sq.m. 685 sq.ft.

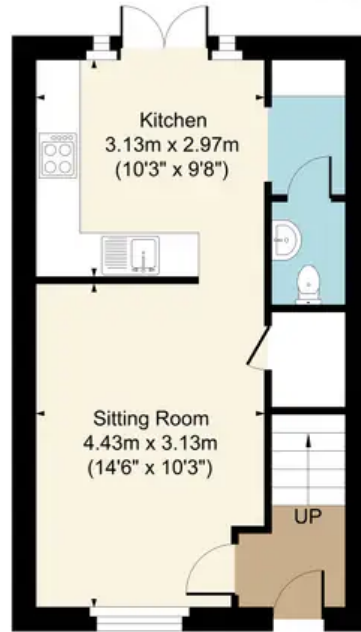

Ground Floor

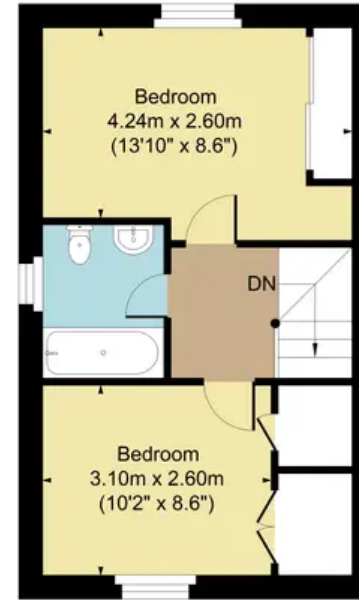

First Floor

FOR ILLUSTRATIVE PURPOSES ONLY-NOT TO SCALE
The position & size of doors, windows, appliances and other features are approximate only.
□ □ Denotes restricted head height
www.dmlphotography.co.uk