



humberstones
homes



5 LEWIS ROAD, OLDBURY, WEST MIDLANDS, B68 0PR

£240,000





THE PROPERTY

VERY WELL PRESENTED 3 BED SEMI DETACHED FAMILY HOME. Explore this property with our 360 degree virtual tour. Situated within this popular location, there are many shops and amenities nearby including large Asda store on Hagley Road West and Tesco Store on Ridgacre Road. There are many buses travelling at regular intervals along Hagley Road West which enables direct access into Birmingham City Centre. The property is set back from the road behind a drive providing off road parking and leads to the following accommodation. On the ground floor is a porch, entrance hall with stairs rising to the first floor and doors off. The spacious through lounge/dining area has a bay window to the front, and sliding patio door to the rear. The fitted kitchen at the rear has base and wall units with work surface area, at the side is a useful side passage/store. First Floor provides 3 bedrooms and re-fitted shower room. Outside to the rear is a good sized pleasant rear garden providing patio, lawn area, pathway and additional garden area at the rear with garage. For Broadband and mobile coverage checker provided by Ofcom (the office of communications) see <https://www.ofcom.org.uk/phones-and-broadband/coverage-and-speeds/ofcom-checker/> Council Tax Band B. EPC rating D..

Council Tax Band B

EPC Rating: D

TITLE

The agents have checked HM land registry and the official copy of register of title shows the property as being Freehold. We recommend buyers verify the status and satisfy themselves as to the tenure.

PROPERTY RELATED SERVICES

Humberstones Homes recommends certain products and services to buyers including mortgage advice, insurance, surveying and conveyancing. We may receive commission for such recommendations and referrals when they proceed to sign up and/or completion. These can vary up to a maximum of £240 per transaction.

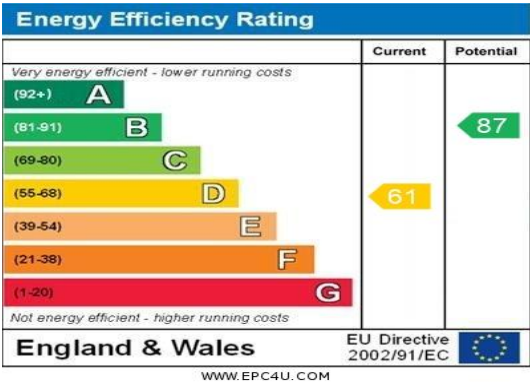

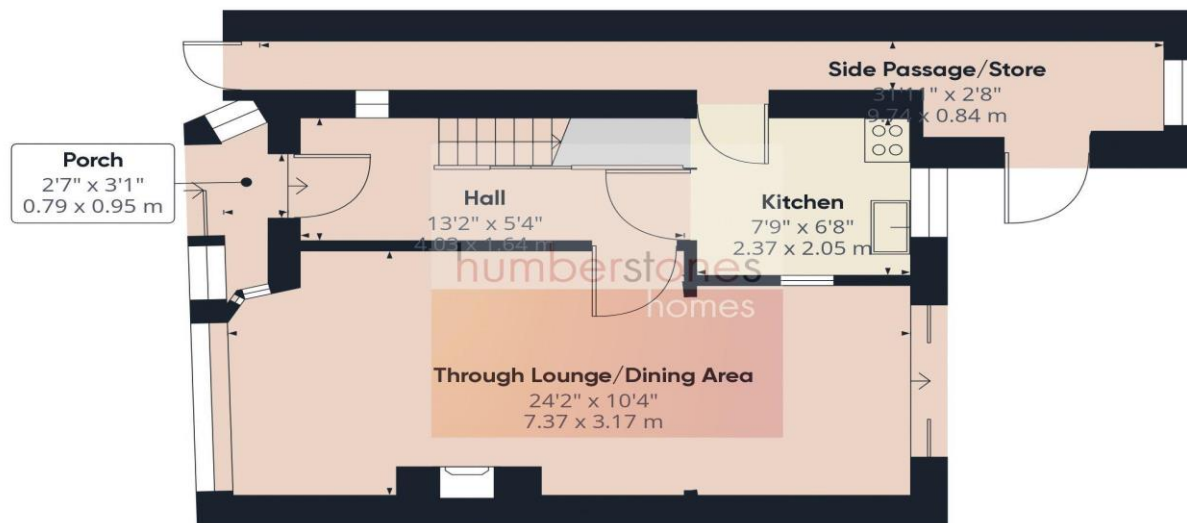

Floor 0

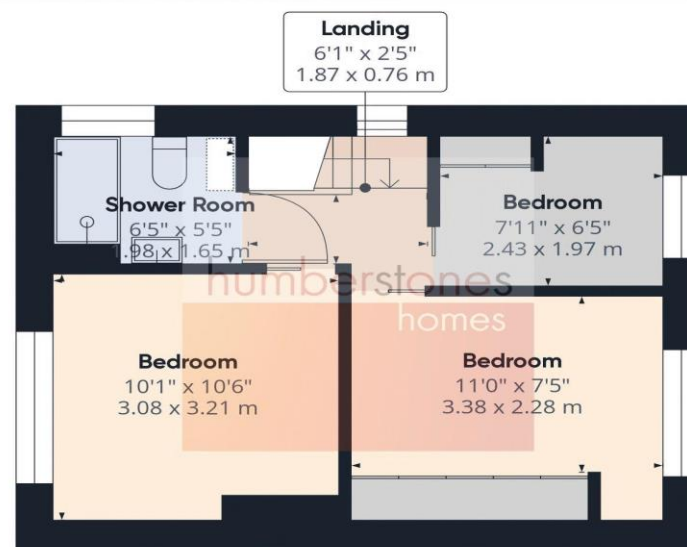

Floor 1



Approximate total area⁽¹⁾

793.41 ft²

73.71 m²

(1) Excluding balconies and terraces

While every attempt has been made to ensure accuracy, all measurements are approximate, not to scale. This floor plan is for illustrative purposes only.

GIRAFFE360

Consumer Protection Regulations 2008: These particulars have been prepared with care & approved by the vendors as correct (TBC) but are only intended as a guide to the property only. The measurements are approximate & usually the maximum size which may include recesses etc and must not rely on them for any purpose. The appearance of an item in any photograph does not mean that it forms part of the property or sale price. Always contact the appropriate Humberstones Homes branch for clarification. Humberstones Homes takes no responsibility for any planning or building regulations being granted or applied for & prospective buyers should always seek clarification from their solicitor or surveyor on these aspects.

Humberstones Homes, 787 Hagley Rd West, B32 1AJ - 0121 422 1188 – sales@humberstoneshomes.co.uk

