

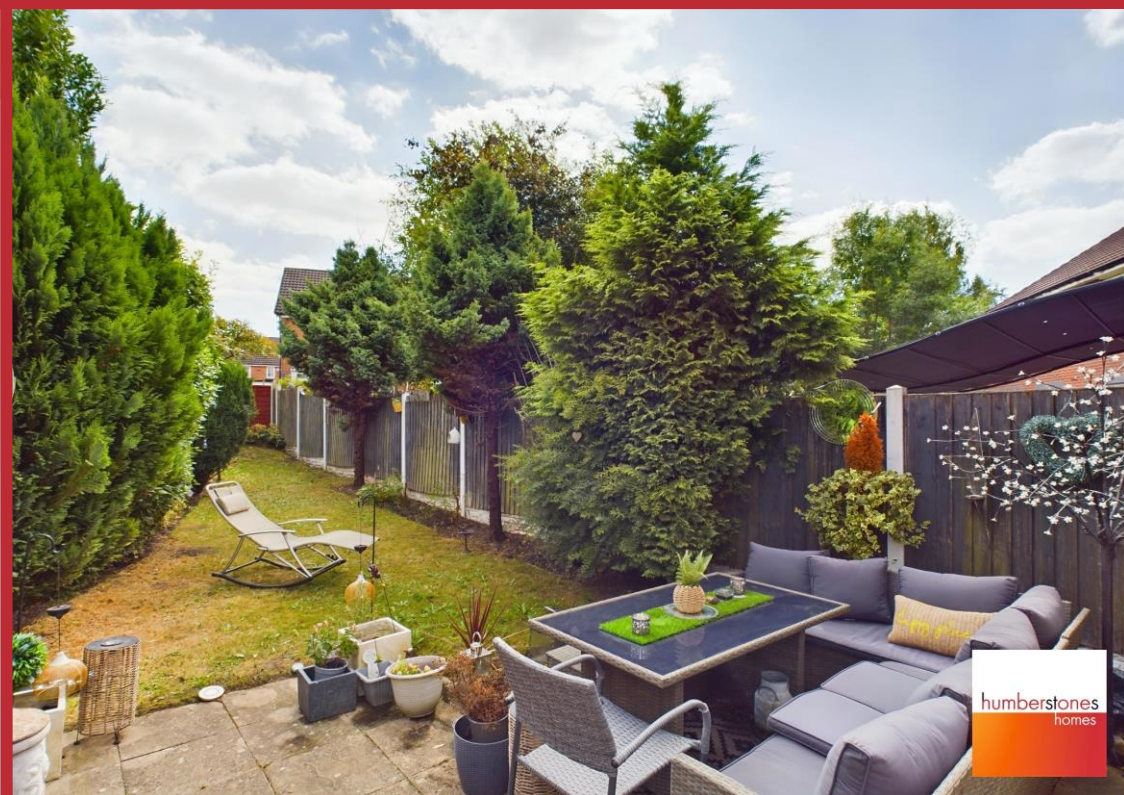

69 VICARAGE STREET, OLDBURY, WEST MIDLANDS, B68 8HE

£220,000





THE PROPERTY

MODERN, VERY WELL PRESENTED 2 BEDROOMED SEMI DETACHED HOME. Explore this property with our 360 degree virtual tour. Situated upon this popular development there are many shops and amenities nearby, and is really handy for Langley Green Train Station, enabling direct access into Birmingham City Centre. The property has a drive providing off road parking and leads to the following accommodation. On the ground floor is a porch which leads into entrance hall having stairs rising to the First Floor. The spacious lounge has a window to the front and the fitted dining kitchen at the rear has base and wall units, work surface area, integrated oven/hob and double doors opening onto the rear garden. First floor offers 2 good sized bedrooms and bathroom. Outside is a pleasant rear garden with patio, lawn area and side access gate to drive. For Broadband and mobile coverage checker provided by Ofcom (the office of communications) see <https://www.ofcom.org.uk/phones-and-broadband/coverage-and-speeds/ofcom-checker/> Council Tax Band B. EPC rating D.

Council Tax Band B

EPC Rating: D

TITLE

The agents have checked HM land registry and the official copy of register of title shows the property as being Freehold. We recommend buyers verify the status and satisfy themselves as to the tenure.

PROPERTY RELATED SERVICES

Humberstones Homes recommends certain products and services to buyers including mortgage advice, insurance, surveying and conveyancing. We may receive commission for such recommendations and referrals when they proceed to sign up and/or completion. These can vary up to a maximum of £240 per transaction.

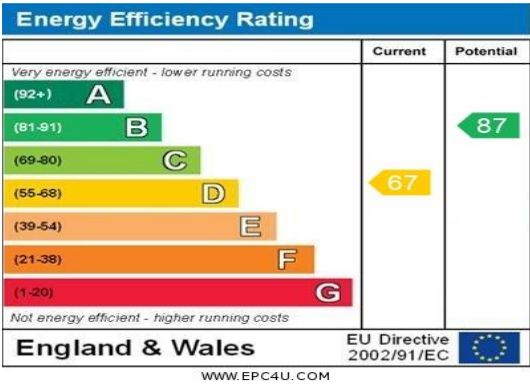

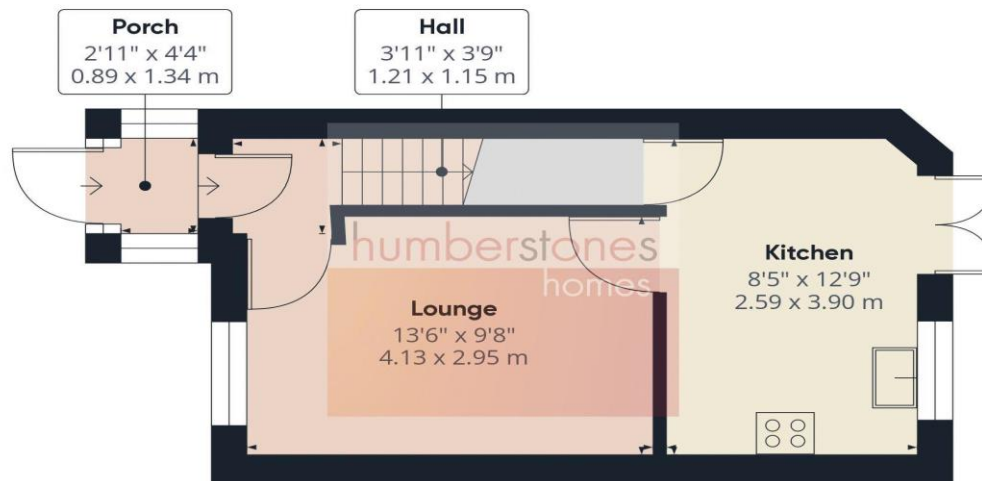

Floor 0

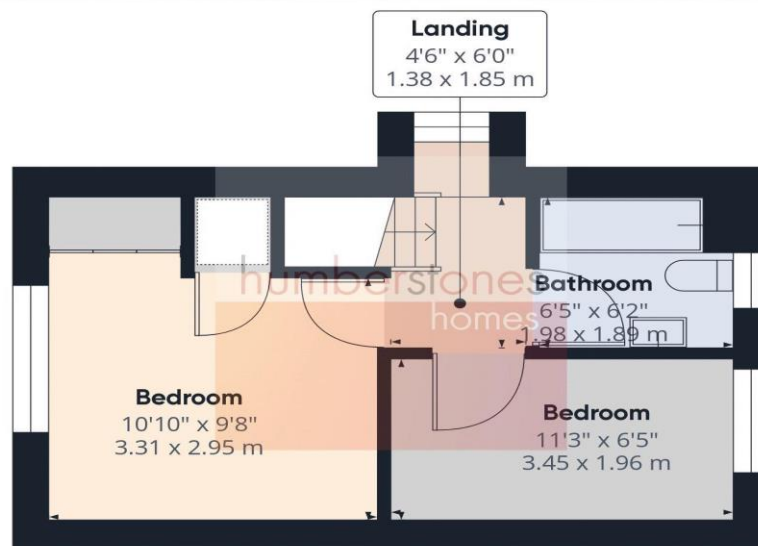

Floor 1



Approximate total area⁽¹⁾
550.14 ft²
51.11 m²

(1) Excluding balconies and terraces

While every attempt has been made to ensure accuracy, all measurements are approximate, not to scale. This floor plan is for illustrative purposes only.

Calculations are based on RICS IPMS 3C standard.

GIRAFFE360

Consumer Protection Regulations 2008: These particulars have been prepared with care & approved by the vendors as correct (TBC) but are only intended as a guide to the property only. The measurements are approximate & usually the maximum size which may include recesses etc and must not rely on them for any purpose. The appearance of an item in any photograph does not mean that it forms part of the property or sale price. Always contact the appropriate Humberstones Homes branch for clarification. Humberstones Homes takes no responsibility for any planning or building regulations being granted or applied for & prospective buyers should always seek clarification from their solicitor or surveyor on these aspects.

Humberstones Homes, 787 Hagley Rd West, B32 1AJ - 0121 422 1188 – sales@humberstoneshomes.co.uk

