



17 Tolsey Mead

Borough Green, Sevenoaks, TN15 8EQ Freehold



4



2



2



D

Price Guide £565,000

This four bedroom detached house is now available for sale located in a quiet cul-de-sac in the popular area of Borough Green. Close to local amenities and station.

Overview

- Detached family home
- Cul de sac location
- Close local shops and station
- Four bedrooms
- Lounge/dining room
- Kitchen
- Family bathroom and en suite shower room
- Cloakroom
- Great size garden with view.
- Garage and parking

Property description

Internally, you will find spacious accommodation on the ground floor with entrance hallway with cloakroom off, separate fitted kitchen, large living room and dining room. Staircase leads to the landing with access to the part boarded loft, airing cupboard and four good size bedrooms (master with en-suite) together with a family bathroom. Externally there is off road parking on the front driveway leading to an integral garage.

The rear garden incorporates a patio area, small lawn and mature flower beds and enjoys pleasant views over the open fields towards the north downs. The property is in need of some updating but offers buyers further scope to extend and change the layout this is of course subject to relevant building and planning consents. The property is double glazed throughout and has gas central heating.



Location

Borough Green village benefits from many local amenities: general convenience stores, small shops, cafes, library and a doctor's medical practice. The village has excellent transportation links with the M20/M25 and M2/A2 motorway networks both within easy reach and Gatwick can be reached in approximately 40 minutes. Borough Green mainline rail station has frequent services to Victoria 50 minutes, London Bridge and Charing Cross 40 and 50 minutes respectively. There are local primary and secondary schools within Borough Green and the neighbouring

villages with grammar schools at nearby Sevenoaks, and a little further afield in Tonbridge. More comprehensive shopping facilities can be found in Sevenoaks, West Malling and Bluewater at Greenhithe (30 minutes).

Viewing arrangements

Viewings are strictly by appointment only via Kings.

Directions

From our office head north on Western Rd/A227. bear left at the top into Wrotham Road. Just after the speed camera turn right into Wye Rd and then sharp first left into Tolsey Mead and the property is found on the left hand side. What3words: ///then.stops.codes

Property information

Mains gas, electric, water and drainage. Council: Tonbridge & Malling, Council Tax Band F. EPC rated D.



Tolsey Mead, TN15

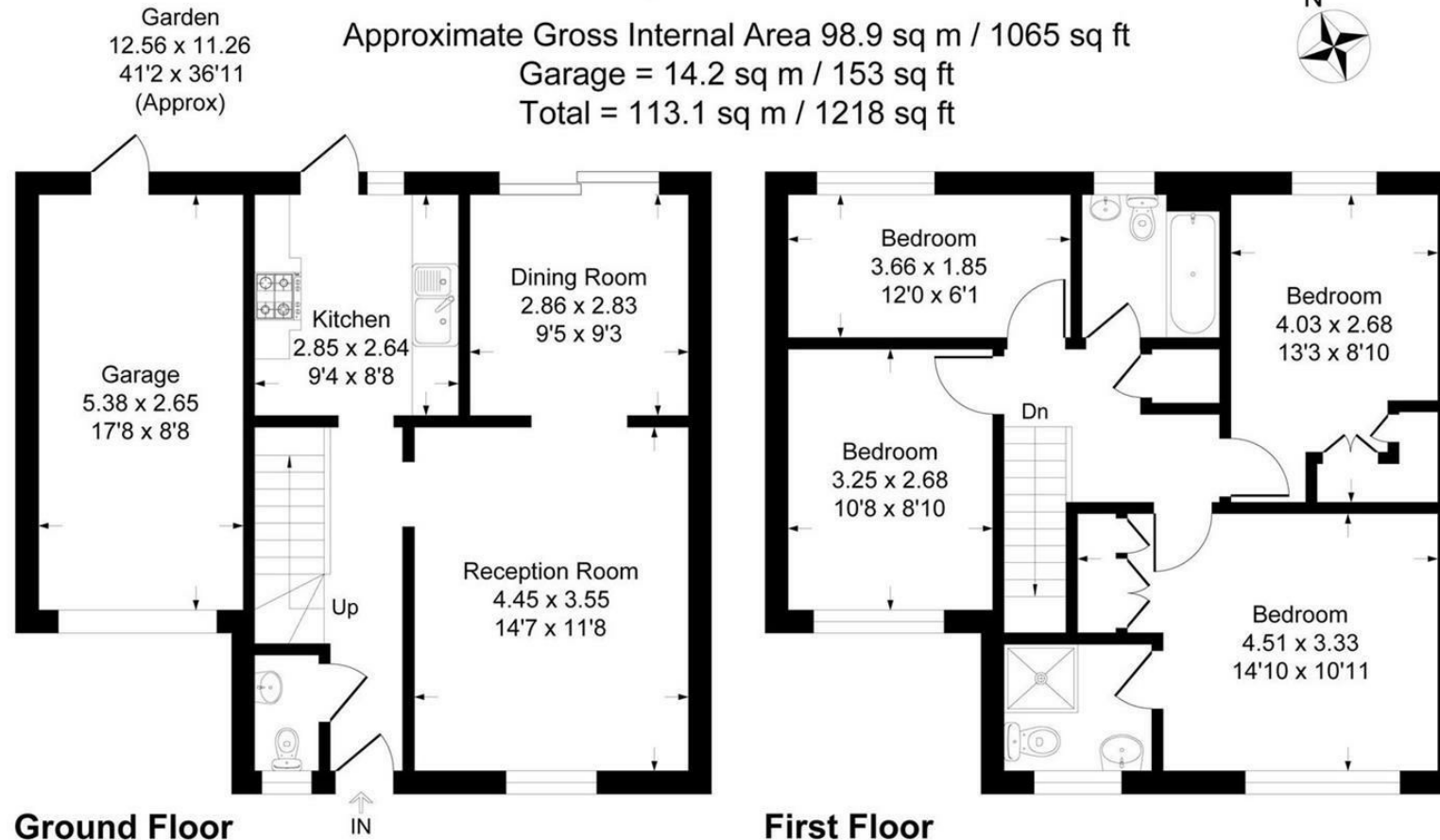

This plan is for layout guidance only. Not drawn to scale unless stated. Windows and door openings are approximate. Whilst every care is taken in the preparation of this plan, please check all dimensions, shapes and compass bearings before making any decisions reliant upon them.

Produced By Planpix

Kings gives notice that: 1 These particulars do not constitute an offer or contract or part of one and must not be relied upon as statements or representations of fact; and we have no authority to make or give any representation or warranties in relation to the property. 2 These particulars have been prepared in good faith and to be used as a general guide. They are not exhaustive and include information provided to us by other parties including the seller, of which may not have been verified. 3 The measurements, areas, distances, orientation and floor plans are approximate and should not be relied on. The text, floor plans and photographs are only for guidance and are not necessarily comprehensive. The photographs may not be current and certain aspects may have changed since the photographs were taken. 4 It should not be assumed that the property has all necessary planning, building regulation or other consents. 5 We have not tested any services, appliances or fittings. 6 Purchasers should satisfy themselves by inspection, searches, enquiries, surveys, and professional advice about all relevant aspects of the property

51 Western Road, Borough Green, Kent, TN15 8AN
T: 01732 885585

boroughgreen@kings-estate-agents.co.uk

kings-estate-agents.co.uk

