

FREEHOLD



House - Terraced (EPC Rating: D)

38 CURLEW ROAD, BOURNEMOUTH,
DORSET, BH8 9QB

£319,950



3 Bedroom House - Terraced located in Bournemouth

This spacious terraced property would make the ideal first home or buy-to-let opportunity. The property has been updated in some areas while others still need slight modernisation. The property comprises of a modern entrance porch leading into the hallway with a rear Upvc door offering direct access to the wonderful conservatory. A well appointed kitchen/diner with floor and wall mounted storage units, gas hob and electric oven and spaces for white goods. The lounge is bright and airy with a large built-in storage cupboard. Upstairs boasts three generous bedrooms, bathroom and large landing area *****THIS IS A NON TRADITIONAL CONSTRUCTION. PLEASE CHECK WITH YOUR LENDER/BROKER BEFORE BOOKING A VIEWING*****

Porch

3'7" x 5'11"

Modern brick built construction with Upvc windows, Upvc door, wood effect flooring, smooth ceiling. Upvc door leading into the main hallway.

Entrance Hall

0'0" x 0'0"

A large entrance hall with doors leading to the ground floor accommodation, cloakroom with half-tiled walls, WC, hand basin, Upvc window to the rear aspect. Storage cupboard, Upvc door leading to the conservatory.

Kitchen

9'10" x 17'5"

A very well appointed kitchen/diner with a full selection of wall and floor mounted units in a wood effect with stone effect worktops, Gas cooker with electric fan oven, tiled splashback, stainless steel sink, spaces for a selection of white goods. Upvc windows to the rear and front aspects.

Lounge

9'10" x 15'1"

A delightful and spacious room with an electric wall heater, large storage cupboard to the rear, Upvc window to the front aspect.

Conservatory

9'6" x 11'6"

A splendid conservatory that adds so much to an already spacious home. Brick-built with Upvc windows, French style doors leading onto the rear garden, wood effect flooring, power and lighting.

Landing

0'0" x 0'0"

A light and bright area with a large storage cupboard housing the modern hot water tank, Upvc window to the rear aspect, loft access, doors leading to accommodation.

Bedroom 1

11'6" x 13'5"

A very spacious master bedroom with built-in wardrobes with mirrored sliding doors and a further storage cupboard over the stairs, electric wall heater, Upvc window to the front aspect.

Bedroom 2

9'10" x 9'10"

A further double bedroom with built-in wardrobes, electric wall heater. Upvc window to the front aspect.

Bedroom 3

5'11" x 9'10"

A generous third bedroom with electric wall heater, built-in storage. Upvc window to the rear aspect,

Bathroom

5'3" x 6'7"

Tiled splashback, sink with vanity storage, bath with shower attachment, electric wall heater. Upvc window to the rear aspect.

Outdoor Space

0'0" x 0'0"

The front of the property is laid to hard standing, with a block paved path leading to the front door and bordered with a three foot fence. The rear garden is accessed via a



service road and would accommodate off road parking. It is laid to hard standing and a selection of mature shrubs and flower beds, with a brick-built storage shed.



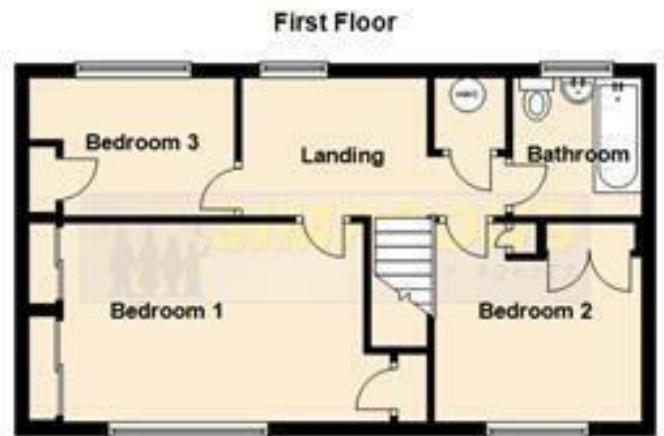

To be used as a guide only
Plan produced using PlanUp

Council Tax Band

C

Energy Performance Graph

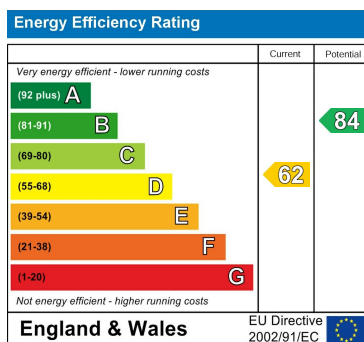

Call us on

01202 532556

sales@simpsonsestateagents.com

www.simpsonsestateagents.com

Agents Note: Whilst every care has been taken to prepare these particulars, they are for guidance purposes only. All measurements are approximate and are for general guidance purposes only and whilst every care has been taken to ensure their accuracy, they should not be relied upon and potential buyers are advised to recheck the measurements.