





Nestled within the serene and established grounds of Woodland Villa in Darlington, this modern purpose-built apartment offers a delightful living experience. With no onward chain, it presents an excellent opportunity for a variety of buyers, whether you are a first-time homeowner, a downsizer, or an astute investor.

The apartment boasts two generously sized double bedrooms, providing ample space for relaxation and rest. The master bedroom features the added convenience of an en-suite bathroom, ensuring privacy and comfort. The main bathroom is well-appointed, catering to the needs of residents and guests alike.

The spacious living room serves as the heart of the home, perfect for entertaining or enjoying quiet evenings. Natural light floods the area, creating a warm and inviting atmosphere, offering flexibility for use as a dining area, study, or lounge space.

For those with vehicles, allocated parking is a valuable feature, ensuring ease of access. While the apartment does require some decoration, this presents a wonderful opportunity for you to personalise the space to your taste and style.







- NO ONWARD CHAIN
- PURPOSE BUILT DEVELOPMENT
- TWO DOUBLE BEDROOMS
- WELL PLACED FOR WALKING DISTANCE TO THE VIBRANT WEST END SHOPPING FACILITIES

- WEST END LOCATION
- SET WITHIN MATURE, ESTABLISHED GROUNDS
- SPACIOUS LIVING ROOM

#### TENURE

The property is leasehold held on a 999 year lease dating from 2004  
Ground Rent: inclusive with the Annual Service Charge  
Annual Service Charge: £1492.80

#### GENERAL INFORMATION



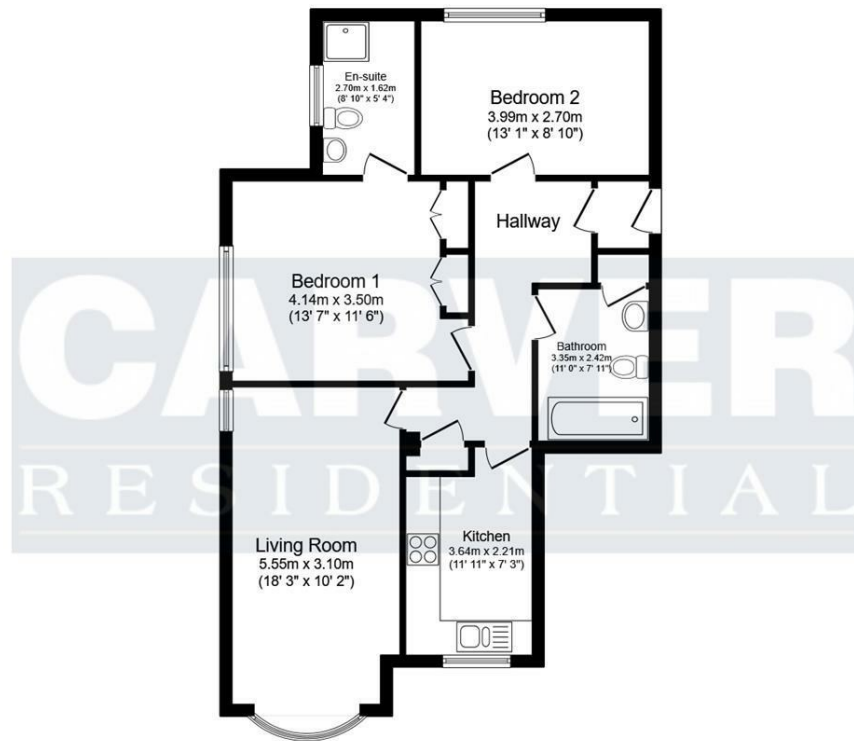

**Floor Plan**

Floor area 71.8 sq.m. (773 sq.ft.)

Total floor area: 71.8 sq.m. (773 sq.ft.)

This floor plan is for illustrative purposes only. It is not drawn to scale. Any measurements, floor areas (including any total floor area), openings and orientations are approximate. No details are guaranteed, they cannot be relied upon for any purpose and do not form any part of any agreement. No liability is taken for any error, omission or misstatement. A party must rely upon its own inspection(s). Powered by [www.Propertybox.io](http://www.Propertybox.io)

Energy Efficiency Rating		
	Current	Potential
Very energy efficient - lower running costs		
(92 plus) <b>A</b>		
(81-91) <b>B</b>		
(69-80) <b>C</b>	74	79
(55-68) <b>D</b>		
(39-54) <b>E</b>		
(21-38) <b>F</b>		
(1-20) <b>G</b>		
Not energy efficient - higher running costs		
<b>England &amp; Wales</b>	EU Directive 2002/91/EC	

**We can search 1,000s of mortgages for you**

It could take just 15 minutes with one of our specialist advisers:  
Call: 01325 380088. Visit: Any of our Offices. Online: [www.mortgageadvicebureau.com/carver](http://www.mortgageadvicebureau.com/carver)



Your home may be repossessed if you do not keep up repayments on your mortgage.  
There will be a fee for mortgage advice. The actual amount you pay will depend upon your circumstances.  
The fee is up to 1% but a typical fee is 0.3% of the amount borrowed

MAB 6202



These particulars do not constitute any part of an offer or contract. None of the statements contained in these particulars are to be relied on as statements or representations of fact and any intending purchaser must satisfy himself by inspection or otherwise to the correctness of each of the statements contained in these particulars. The vendor does not make or give, and neither Nick & Gordon Carver Residential or Commercial, Nick & Gordon Carver, nor any person in their employment has any authority to make or give any representation or warranty whatever in relation to this property



**14 Duke Street, Darlington**  
**Co Durham, DL3 7AA**  
**01325 357807**  
**[sales@carvergroup.co.uk](mailto:sales@carvergroup.co.uk)**

**63 Dalton Way, Newton Aycliffe**  
**Co Durham DL5 4NB**  
**01325 320676**  
**[aycliffe@carvergroup.co.uk](mailto:aycliffe@carvergroup.co.uk)**

**41 Market Place, Richmond**  
**North Yorkshire, DL10 4QL**  
**01748 825317**  
**[richmond@carvergroup.co.uk](mailto:richmond@carvergroup.co.uk)**

**219 High Street, Northallerton**  
**North Yorkshire DL7 8LW**  
**01609 777710**  
**[northallerton@carvergroup.co.uk](mailto:northallerton@carvergroup.co.uk)**