



**CARVER**  
RESIDENTIAL  
Sales · Lettings · Property Management

Bolam, Darlington, DL2 2UP

**Price £245,000**

Cottage  
3 Bedroom/s  
1 Bathroom/s

Nestled in the charming village of Bolam within 15 minutes from Darlington, this lovely cottage offers a quintessential British countryside living experience. Boasting two reception rooms, three cosy bedrooms, and a quaint bathroom, this property exudes warmth and character. Situated amidst picturesque countryside, this cottage provides a tranquil retreat from the hustle and bustle of daily life. The village's pub offers a friendly atmosphere for social gatherings and a taste of local community life. One of the highlights of this property is its large garden to the south, perfect for enjoying sunny afternoons or hosting outdoor gatherings with friends and family. The lush greenery surrounding the cottage adds to its idyllic charm, creating a peaceful and serene environment. Whether you're looking for a weekend getaway or a permanent residence, this cottage in Bolam is sure to capture your heart with its traditional British allure and peaceful surroundings. Don't miss the opportunity to own a piece of countryside paradise in this beautiful village.

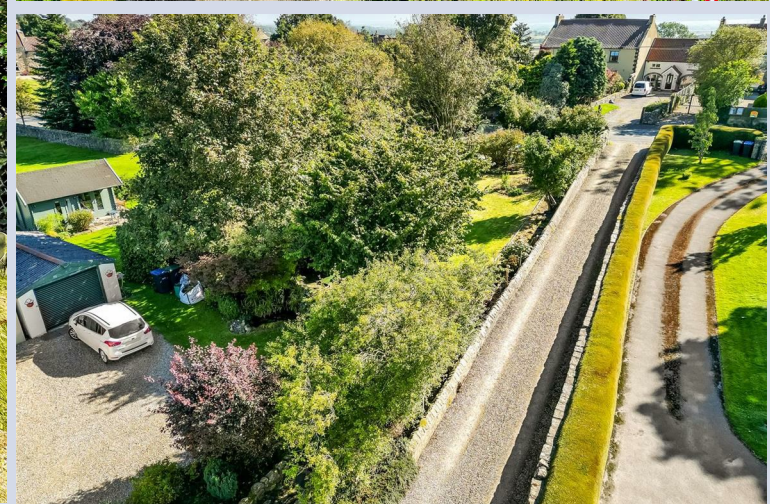



- VILLAGE LOCATION
- VILLAGE PUB NEARBY
- LARGE GARDEN TO THE SOUTH

- STUNNING ADJOINING COUNTRYSIDE
- ONLY 15 MINUTES TO DARLINGTON

#### **GENERAL INFORMATION**

Tenure: Freehold

Services: Oil central heating, mains electric, water and drainage.

Double glazing

Local Authority: Durham County Council (Tax Banding D)









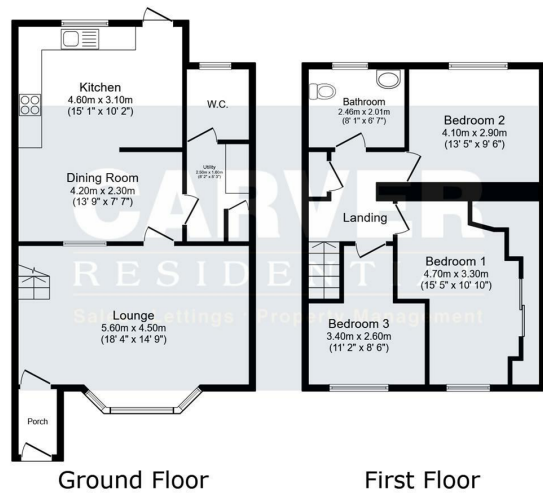

This floor plan is for illustrative purposes only. It is not drawn to scale. Any measurements, floor areas (including any total floor area), openings and orientations are approximate. No details are guaranteed, they cannot be relied upon for any purpose and do not form any part of any agreement. No liability is taken for any error, omission or misstatement. A party must rely upon its own inspection(s). Powered by www.Propertybox.io



Energy Efficiency Rating	
Band	Score
A	92-100
B	81-91
C	69-80
D	55-68
E	39-54
F	13-38
G	1-12

**We can search 1,000s of mortgages for you**

It could take just 15 minutes with one of our specialist advisers:  
 Call: 01325 380088. Visit: Any of our Offices. Online: [www.mortgageadvicebureau.com/carver](http://www.mortgageadvicebureau.com/carver)



Your home may be repossessed if you do not keep up repayments on your mortgage. There will be a fee for mortgage advice. The actual amount you pay will depend upon your circumstances. The fee is up to 1% but a typical fee is 0.3% of the amount borrowed

MAB 6202



These particulars do not constitute any part of an offer or contract. None of the statements contained in these particulars are to be relied on as statements or representations of fact and any intending purchaser must satisfy himself by inspection or otherwise to the correctness of each of the statements contained in these particulars. The vendor does not make or give, and neither Nick & Gordon Carver Residential or Commercial, Nick & Gordon Carver, nor any person in their employment has any authority to make or give any representation or warranty whatever in relation to this property



14 Duke Street, Darlington  
 County Durham, DL3 7AA  
 Tel: 01325 357807  
[sales@carvergroup.co.uk](mailto:sales@carvergroup.co.uk)

26 Market Place, Richmond  
 North Yorkshire, DL10 4QG  
 Tel: 01748 825317  
[richmond@carvergroup.co.uk](mailto:richmond@carvergroup.co.uk)

43 Dalton Way, Newton Aycliffe  
 County Durham, DL5 4DJ  
 Tel: 01325 320676  
[aycliffe@carvergroup.co.uk](mailto:aycliffe@carvergroup.co.uk)

219 High Street, Northallerton  
 North Yorkshire, DL7 8LW  
 Tel: 01609 777710  
[northallerton@carvergroup.co.uk](mailto:northallerton@carvergroup.co.uk)