



**CARVER**  
RESIDENTIAL  
Sales · Lettings · Property Management

Redworth Road,  
Heighington Village, Newton Aycliffe, DL5 6PR  
**Price £370,000**

House - Detached  
4 Bedroom/s  
2 Bathroom/s



Welcome to this charming period property located on Redworth Road in the popular and picturesque Village of Heighington. This stunning detached stone built home, built around 1835, boasts not only a rich history but also modern amenities that make it a perfect blend of old-world charm and contemporary comfort.

Renovated and extended over the years, with two spacious reception rooms that offer ample space for the family. With three bedrooms, the master having a stunning en-suite. there is also a further 4th bedroom currently used as a home office and two bathrooms, plenty of room for everyone.

One of the highlights of this property is the low maintenance courtyard and then up the spiral staircase to the garden roof terrace, where you can unwind and enjoy the beautiful sunsets and the privacy. There is also secure garage parking with electric roller door ensuring your vehicle is safe and sound, giving you peace of mind.

What sets this property apart is its character - from the historic exposed stone fireplace and the unique features, this house is truly oozing with charm, this house is sure to capture your heart.

Don't miss the opportunity to make this delightful property your new home. Contact us today to arrange a viewing and experience the magic of Redworth Road for yourself.







- Popular Village Location
- Roof Top Garden
- Courtyard Garden also

- Character Property
- Secure parking

**GENERAL INFORMATION:**

Tenure: Freehold

Services: Gas central heating, mains electric, water and drainage.  
Double glazing

Local Authority: Darlington Borough Council (Tax Banding D)











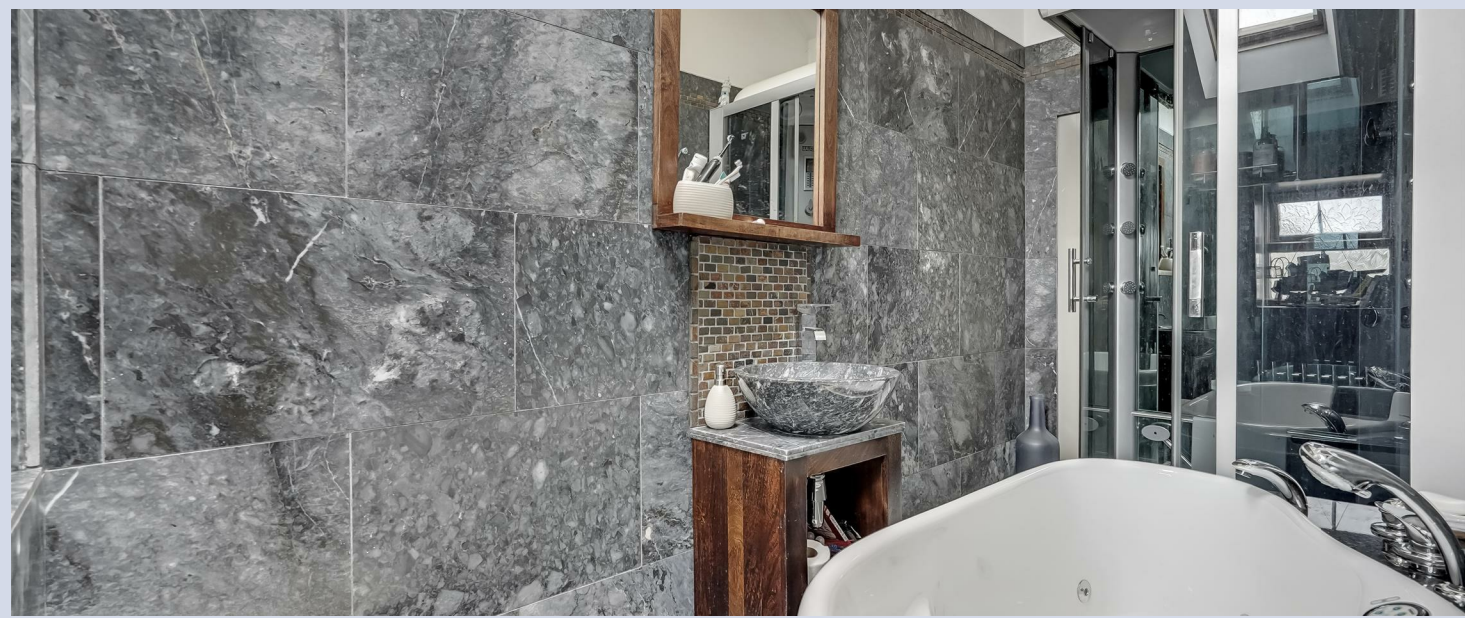







Energy Efficiency Rating		Current	Potential
Very energy efficient - lower running costs			
92-100	A		
81-91	B		
69-80	C		
55-68	D		
39-54	E		
21-38	F		
1-20	G		
Not energy efficient - higher running costs			
England & Wales		EU Directive 2002/91/EC	

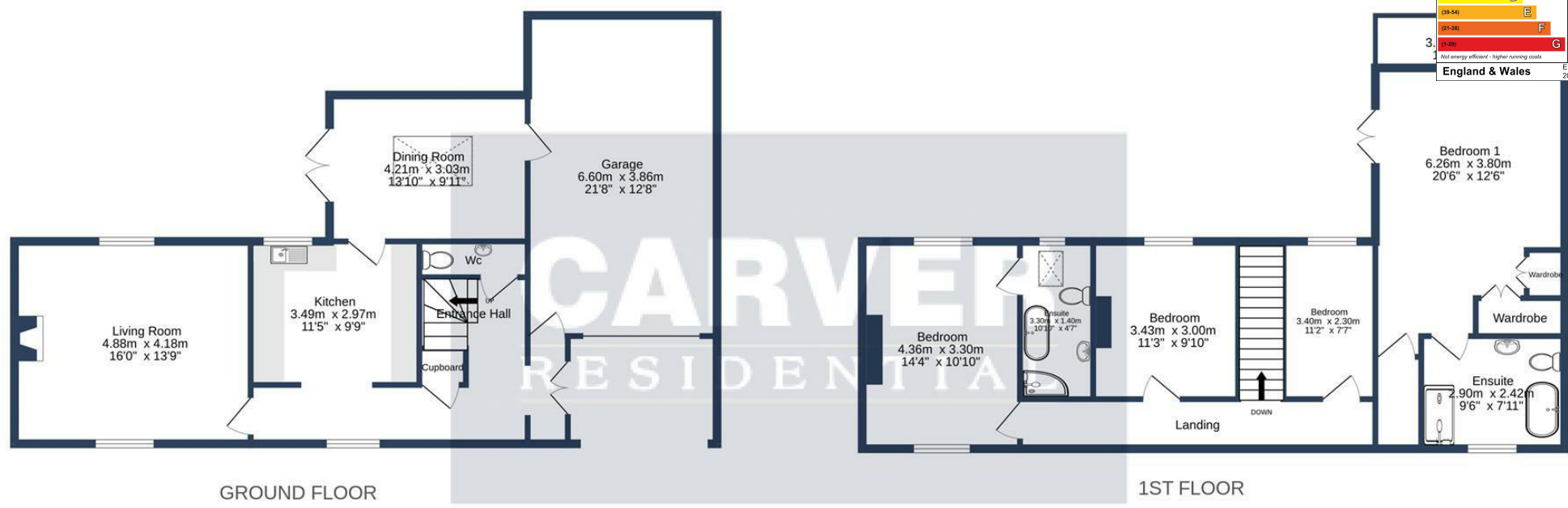

REDWORTH ROAD, HEIGHINGTON. DL5 6PR.

Whilst every attempt has been made to ensure the accuracy of the floorplan contained here, measurements of doors, windows, rooms and any other items are approximate and no responsibility is taken for any error, omission or mis-statement. This plan is for illustrative purposes only and should be used as such by any prospective purchaser. The services, systems and appliances shown have not been tested and no guarantee as to their operability or efficiency can be given.  
Made with Metropix ©2024

**We can search 1,000s of mortgages for you**

It could take just 15 minutes with one of our specialist advisers:  
Call: 01325 380088. Visit: Any of our Offices. Online: [www.mortgageadvicebureau.com/carver](http://www.mortgageadvicebureau.com/carver)



Your home may be repossessed if you do not keep up repayments on your mortgage. There will be a fee for mortgage advice. The actual amount you pay will depend upon your circumstances. The fee is up to 1% but a typical fee is 0.3% of the amount borrowed

MAB 6202



These particulars do not constitute any part of an offer or contract. None of the statements contained in these particulars are to be relied on as statements or representations of fact and any intending purchaser must satisfy himself by inspection or otherwise to the correctness of each of the statements contained in these particulars. The vendor does not make or give, and neither Nick & Gordon Carver Residential or Commercial, Nick & Gordon Carver, nor any person in their employment has any authority to make or give any representation or warranty whatever in relation to this property



**14 Duke Street, Darlington**  
Co Durham, DL3 7AA  
01325 357807  
[sales@carvergroup.co.uk](mailto:sales@carvergroup.co.uk)

**43 Dalton Way, Newton Aycliffe**  
Co Durham DL5 4DJ  
01325 320676  
[aycliffe@carvergroup.co.uk](mailto:aycliffe@carvergroup.co.uk)

**41 Market Place, Richmond**  
North Yorkshire, DL10 4QL  
01748 825317  
[richmond@carvergroup.co.uk](mailto:richmond@carvergroup.co.uk)

**219 High Street, Northallerton**  
North Yorkshire DL7 8LW  
01609 777710  
[northallerton@carvergroup.co.uk](mailto:northallerton@carvergroup.co.uk)