



**CARVER**  
RESIDENTIAL  
Sales · Lettings · Property Management

Spa Road  
Gainford, Darlington, DL2 3EB

**Offers in the region of £190,000**

House - Semi-Detached  
2 Bedroom/s  
1 Bathroom/s

**Charming and characterful cottage with two double bedrooms plus attic room currently used as a study, south facing rear courtyard and single garage.**

**\*\* GARAGE \*\* WITH ELECTRIC DOOR.** Superb opportunity to purchase this stone built cottage in a village location, retaining many period features all adding to the charm and character of this delightful home. Entrance hall with stairs giving access to the first floor, light and airy living room with feature oak fire surround together with multi-fuel stove, useful understairs storage cupboard and feature shelving to alcove, kitchen diner is an ideal area to entertain, the kitchen having Belfast sink together with quality units, feature tiled flooring and stable door giving access to south facing rear courtyard. To the first floor there is a landing area, bathroom/WC with contemporary white suite with overhead shower and feature tiling, two sizeable double bedrooms. To bedroom one there is a fixed staircase giving access to an attic room with Velux windows and storage into the eaves. Enclosed south facing courtyard and good sized single garage with electric door, power, lighting, water, storage cupboards and useful handy utility area with plumbing and space for washing machine.





- Charming country cottage
- Two double bedrooms
- Rear courtyard
- Ready to move into
- Forecourt to front
- Retaining many period features including internal doors
- Attic room
- Garage with electric door
- Picturesque village location

#### **GENERAL INFORMATION**

Tenure: Freehold

Services: Gas central heating, mains electric, water and drainage.

Double Glazing

Local Authority: Darlington Borough Council (Tax Banding C)

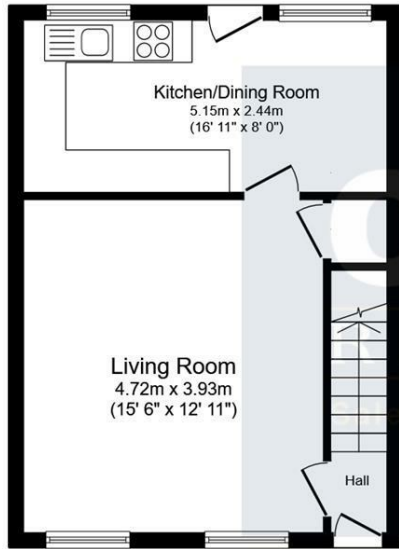

Ground Floor

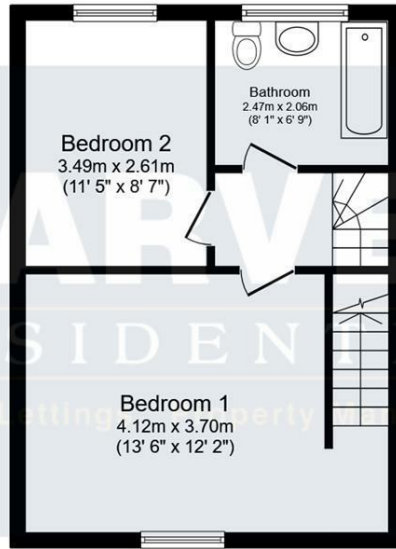

First Floor

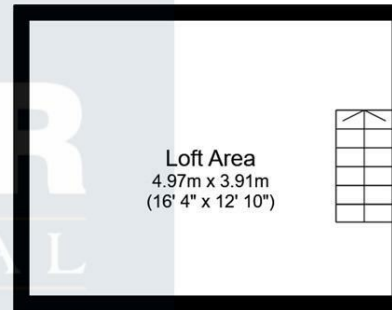

Second Floor

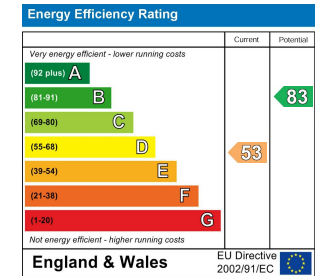

This floor plan is for illustrative purposes only. It is not drawn to scale. Any measurements, floor areas (including any total floor area), openings and orientations are approximate. No details are guaranteed, they cannot be relied upon for any purpose and do not form any part of any agreement. No liability is taken for any error, omission or misstatement. A party must rely upon its own inspection(s). Powered by www.Propertybox.io

We can search 1,000s of mortgages for you

It could take just 15 minutes with one of our specialist advisers:  
Call: 01325 380088. Visit: Any of our Offices. Online: [www.mortgageadvicebureau.com/carver](http://www.mortgageadvicebureau.com/carver)



Your home may be repossessed if you do not keep up repayments on your mortgage. There will be a fee for mortgage advice. The actual amount you pay will depend upon your circumstances. The fee is up to 1% but a typical fee is 0.3% of the amount borrowed

MAB 6202



These particulars do not constitute any part of an offer or contract. None of the statements contained in these particulars are to be relied on as statements or representations of fact and any intending purchaser must satisfy himself by inspection or otherwise to the correctness of each of the statements contained in these particulars. The vendor does not make or give, and neither Nick & Gordon Carver Residential or Commercial, Nick & Gordon Carver, nor any person in their employment has any authority to make or give any representation or warranty whatever in relation to this property



14 Duke Street, Darlington  
Co Durham, DL3 7AA  
01325 357807  
[sales@carvergroup.co.uk](mailto:sales@carvergroup.co.uk)

43 Dalton Way, Newton Aycliffe  
Co Durham DL5 4DJ  
01325 320676  
[aycliffe@carvergroup.co.uk](mailto:aycliffe@carvergroup.co.uk)

41 Market Place, Richmond  
North Yorkshire, DL10 4QL  
01748 825317  
[richmond@carvergroup.co.uk](mailto:richmond@carvergroup.co.uk)

219 High Street, Northallerton  
North Yorkshire DL7 8LW  
01609 777710  
[northallerton@carvergroup.co.uk](mailto:northallerton@carvergroup.co.uk)