



CARVER
RESIDENTIAL
Sales · Lettings · Property Management

Fawn Lea, Winston Road,
Staindrop, Darlington, DL2 3NN
Offers over £550,000

House - Detached
6 Bedroom/s
4 Bathroom/s

PART EXCHANGE CONSIDERED. Nestled in the charming village of Staindrop, Darlington, this detached house on Winston Road is a true gem waiting to be discovered. This property offers a spacious and flexible living experience that is sure to impress. One of the standout features of this unique property is the attached holiday cottage, which not only adds character but also provides a generous income opportunity for the new owner. Imagine the possibilities - hosting guests from near and far, or perhaps using it as a private retreat for friends and family.

With parking for several vehicles including a triple garage, parking will never be an issue for you or your guests. The stunning village location adds to the appeal of this property, offering a peaceful and picturesque setting for you to call home. Whether you're looking to enjoy the tranquillity of village life or explore the nearby countryside, this property provides the perfect base for both.

Don't miss out on this fantastic opportunity to own a truly special property that combines traditional charm with modern convenience.





- UNIQUE INDIVIDUAL PROPERTY OFFERING FLEXIBLE LIVING ACCOMMODATION
- CLOSE TO COUNTRYSIDE & AMENITIES
- ALSO HAVING AN ATTACHED COTTAGE PROVIDING A HOLIDAY LET WITH INCOME
- TRIPLE GARAGE WITH ADDITIONAL PARKING.
- DECEPTIVELY SPACIOUS HOUSE AND HOLIDAY COTTAGE.
- SET WITHIN THE PICTURESQUE VILLAGE OF STAINDROP
- UPGRADED THROUGHOUT WITH QUALITY FIXTURES & FITTINGS
- WILL APPEAL TO A VARIETY OF BUYERS
- PART EXCHANGE CONSIDERED

GENERAL INFORMATION

Tenure: Freehold
 Services: Gas central heating, mains electric, water and drainage.
 Double glazing
 Local Authority: Durham County Council(Tax Banding E)









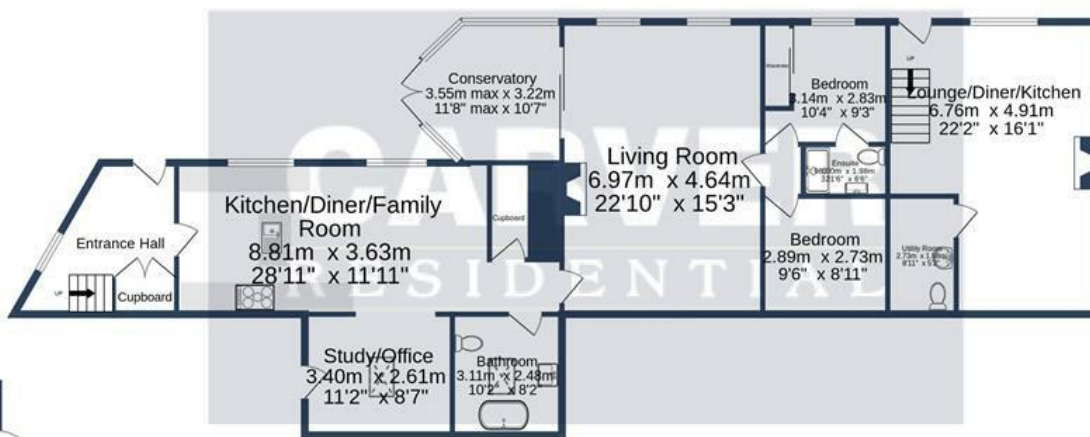
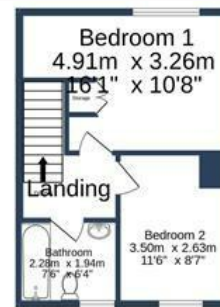

GROUND FLOOR

WINSTON ROAD, STAINDROP. DL2 3NN.

Whilst every attempt has been made to ensure the accuracy of the floorplan contained here, measurements of doors, windows, rooms and any other items are approximate and no responsibility is taken for any error, omission or mis-statement. This plan is for illustrative purposes only and should be used as such by any prospective purchaser. The services, systems and appliances shown have not been tested and no guarantee as to their operability or efficiency can be given.

Made with Metropix ©2024

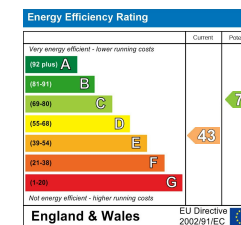

24 Duke Street, Darlington
County Durham, DL3 7AA
Tel: 01325 357807
sales@carvergroup.co.uk

26 Market Place, Richmond
North Yorkshire, DL10 4QG
Tel: 01748 825317
richmond@carvergroup.co.uk

43 Dalton Way, Newton Aycliffe
County Durham, DL5 4DJ
Tel: 01325 320676
aycliffe@carvergroup.co.uk

219 High Street, Northallerton
North Yorkshire, DL7 8LW
Tel: 01609 777710
northallerton@carvergroup.co.uk