



country properties  
village properties  
town homes  
barn conversions  
building plots

Jasmine Cottage, South Terrace,  
Croft On Tees, DL2 2TE

**Offers over £575,000**

**NICK & GORDON**  
**CARVER**  
RESIDENTIAL

A beautiful, Georgian residence located within the extremely sought after village of Croft on Tees, located close to Darlington and within 20 minutes to Northallerton. Croft on Tees benefits from primary school, nearby shops and pubs and is within walking distance from Rockliffe Hall Hotel, with golf course and spa. Jasmine Cottage occupies an impressive, elevated position set back from the roadside behind beautiful landscaped gardens and driveway. To the rear of the property is a private patio area for outdoor entertainment which then leads to a lawned garden area with summer house and garden shed both with power and lighting. Internally, the property briefly comprises welcoming entrance hallway which leads into the large open plan kitchen/dining/family space. There are two large reception rooms with impressive fireplaces and useful separate study area. To the first floor there are four spacious bedrooms, with bedrooms one and two both overlooking the front garden and views beyond. Bedroom three has a useful shower cubicle and vanity wash basin. The spacious bathroom has roll top bath and a separate shower. In addition to the main accommodation is a versatile studio attached to the side of the property with power lighting and timber flooring. Parking is well catered for having an extensive paved drive and a double detached garage with boarded loft for additional storage.





- BEAUTIFUL GEORGIAN RESIDENCE
- LARGE DRIVEWAY AND DOUBLE GARAGE
- ABUNDANCE OF CHARACTER THROUGHOUT

- PRIVATE REAR GARDEN
- VERSATILE STUDIO/OFFICE SPACE
- NEWLY FITTED WINDOWS TO THE FRONT ELEVATION

**GENERAL INFORMATION:**

Tenure: Freehold

Services: Gas central heating, mains electric, water and drainage.

Double glazing

Local Authority: Richmondshire (Tax Banding F)









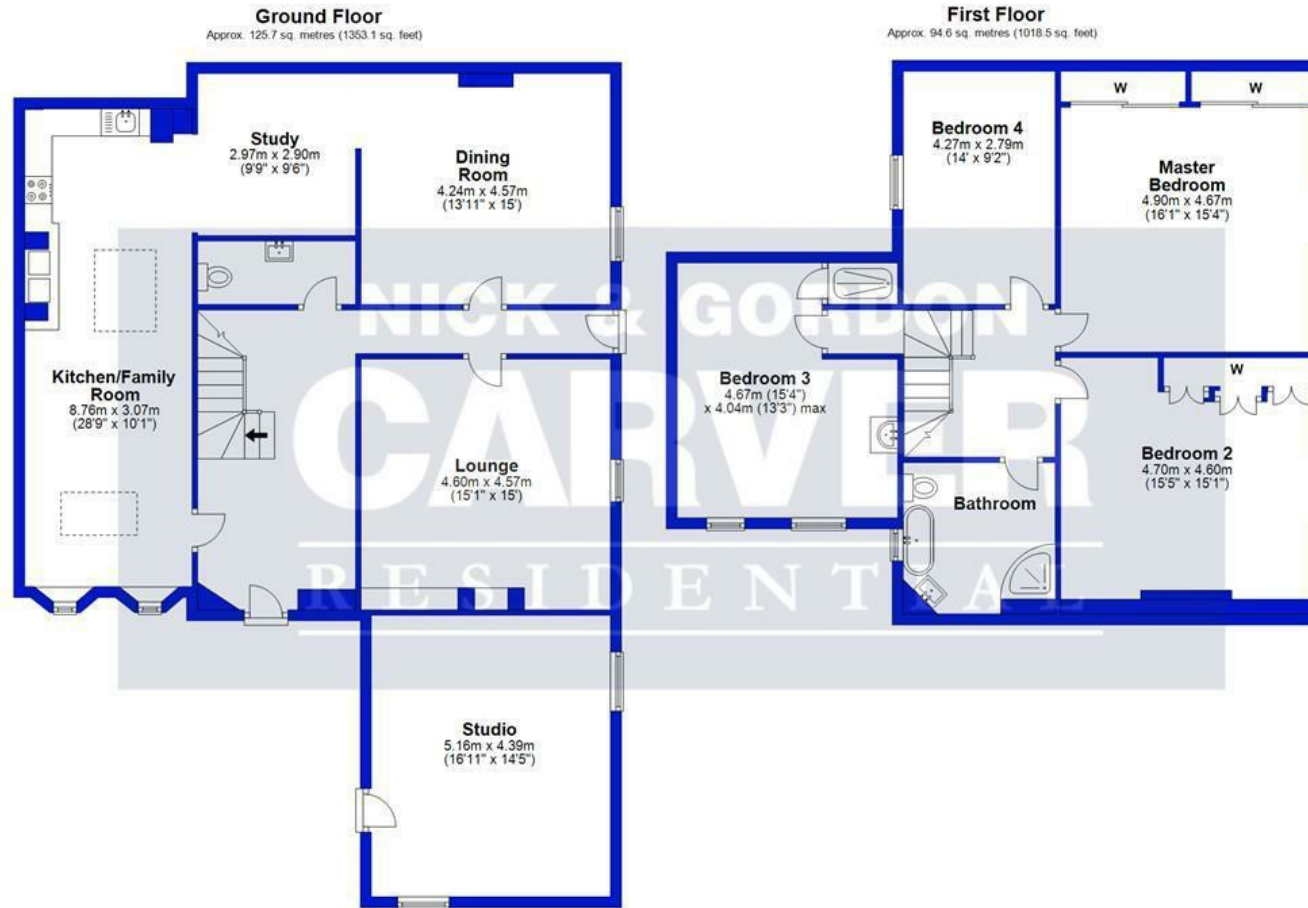

Energy Efficiency Rating		Environmental Impact (CO <sub>2</sub> ) Rating	
Current	Target	Current	Target
Energy Efficiency Rating: A (70) / B (53)		Environmental Impact (CO <sub>2</sub> ) Rating: B (68) / C (102)	
<small>EU Directive 2002/91/EC</small>		<small>EU Directive 2002/91/EC</small>	

Total area: approx. 220.3 sq. metres (2371.6 sq. feet)

Sketch Plan. Not To Scale. For Illustrative Purposes Only. Created by HJ Cadplan Ltd. Plan produced using PlanIt.

**We can search 1,000s of mortgages for you**

It could take just 15 minutes with one of our specialist advisers:  
 Call: 01325 380088. Visit: Any of our Offices. Online: [www.mortgageadvicebureau.com/carver](http://www.mortgageadvicebureau.com/carver)



Your home may be repossessed if you do not keep up repayments on your mortgage. There will be a fee for mortgage advice. The actual amount you pay will depend upon your circumstances. The fee is up to 1% but a typical fee is 0.3% of the amount borrowed

MAB 6202



These particulars do not constitute any part of an offer or contract. None of the statements contained in these particulars are to be relied on as statements or representations of fact and any intending purchaser must satisfy himself by inspection or otherwise to the correctness of each of the statements contained in these particulars. The vendor does not make or give, and neither Nick & Gordon Carver Residential or Commercial, Nick & Gordon Carver, nor any person in their employment has any authority to make or give any representation or warranty whatever in relation to this property

80 High Street  
 Yarm, TS15 9AH  
 Tel: 01642 420090  
[yarm@carvergroup.co.uk](mailto:yarm@carvergroup.co.uk)

14 Duke Street, Darlington  
 County Durham, DL3 7AA  
 Tel: 01325 357807  
[sales@carvergroup.co.uk](mailto:sales@carvergroup.co.uk)

26 Market Place, Richmond  
 North Yorkshire, DL10 4QG  
 Tel: 01748 825317  
[richmond@carvergroup.co.uk](mailto:richmond@carvergroup.co.uk)

43 Dalton Way, Newton Aycliffe  
 County Durham, DL5 4DJ  
 Tel: 01325 320676  
[aycliffe@carvergroup.co.uk](mailto:aycliffe@carvergroup.co.uk)

219 High Street, Northallerton  
 North Yorkshire, DL7 8LW  
 Tel: 01609 777710  
[northallerton@carvergroup.co.uk](mailto:northallerton@carvergroup.co.uk)