



**CARVER**  
RESIDENTIAL  
Sales · Lettings · Property Management

Linwood Grove,  
Darlington, DL3 8DP

**Offers in the region of £550,000**

House - Detached  
5 Bedroom/s  
2 Bathroom/s

Tucked away within this highly desirable WEST END cul-de-sac location, we are delighted to offer for sale this impressive DETACHED family home, situated on a sizeable plot this is a home for all the family to enjoy, having a large private enclosed rear garden, a perfect place to enjoy and entertain family and friends.

Once inside the welcoming hallway, you will notice the well proportioned rooms, two formal reception rooms, a large kitchen/breakfast room, with integrated appliances, and granite working surfaces, also having French doors opening to bring the outside in. To the first floor is a landing area, master bedroom with en-suite with walk-in shower, four further bedrooms and family bathroom/WC. Externally having a DOUBLE block paved driveway allowing off road parking and large garage. The rear garden is certainly an added feature, with patio and summerhouse.

Linwood Grove is located within the heart of the WEST END, and is within easy access of transport links and well regarded schools.





- IMPRESSIVE FAMILY HOME
- GENEROUS PROPORTIONS
- CUL-DE-SAC LOCATION
- FIVE BEDROOMS MASTER WITH EN-SUITE
- PRIME WEST END LOCATION
- WALKING DISTANCE TO EXCELLENT SCHOOLING
- EXTENSIVE DRIVEWAY AND GARAGE
- EARLY VIEWING WILL IMPRESS THE DISCERNING BUYER.

**GENERAL INFORMATION:**

Tenure: Freehold

Services: Gas central heating, mains electric, water and drainage.

Double glazing

Local Authority: Darlington Borough Council (Tax Banding F)









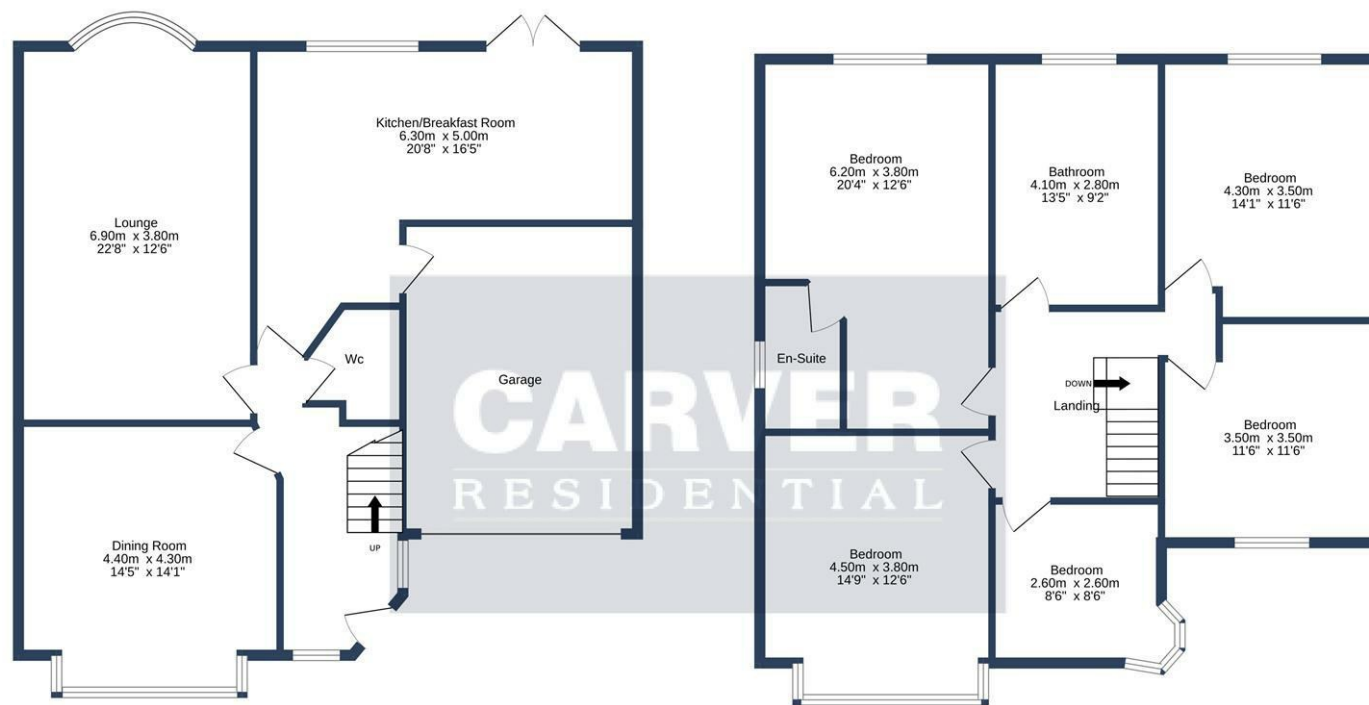

GROUND FLOOR  
94.1 sq.m. (1013 sq.ft.) approx.

1ST FLOOR  
94.3 sq.m. (1015 sq.ft.) approx.

LINWOOD GROVE, DARLINGTON, DL3 8DP.

TOTAL FLOOR AREA : 188.4 sq.m. (2028 sq.ft.) approx.

Whilst every attempt has been made to ensure the accuracy of the floorplan contained here, measurements of doors, windows, rooms and any other items are approximate and no responsibility is taken for any error, omission or mis-statement. This plan is for illustrative purposes only and should be used as such by any prospective purchaser. The services, systems and appliances shown have not been tested and no guarantee as to their operability or efficiency can be given.  
Made with Metropix ©2024

Energy Efficiency Rating		
	Current	Potential
Very energy efficient - lower running costs		
(92 plus) <b>A</b>		
(81-91) <b>B</b>		
(69-80) <b>C</b>		
(55-64) <b>D</b>		
(39-54) <b>E</b>		
(21-38) <b>F</b>		
(1-20) <b>G</b>		
Not energy efficient - higher running costs		
		<b>75</b>
		<b>56</b>
England & Wales		EU Directive 2002/91/EC

We can search 1,000s of mortgages for you

It could take just 15 minutes with one of our specialist advisers:  
Call: 01325 380088. Visit: Any of our Offices. Online: [www.mortgageadvicebureau.com/carver](http://www.mortgageadvicebureau.com/carver)



Your home may be repossessed if you do not keep up repayments on your mortgage. There will be a fee for mortgage advice. The actual amount you pay will depend upon your circumstances. The fee is up to 1% but a typical fee is 0.3% of the amount borrowed

MAB 6202



These particulars do not constitute any part of an offer or contract. None of the statements contained in these particulars are to be relied on as statements or representations of fact and any intending purchaser must satisfy himself by inspection or otherwise to the correctness of each of the statements contained in these particulars. The vendor does not make or give, and neither Nick & Gordon Carver Residential or Commercial, Nick & Gordon Carver, nor any person in their employment has any authority to make or give any representation or warranty whatever in relation to this property

naea  
propertymark

PROTECTED



14 Duke Street, Darlington  
County Durham, DL3 7AA  
Tel: 01325 357807  
sales@carvergroup.co.uk

26 Market Place, Richmond  
North Yorkshire, DL10 4QG  
Tel: 01748 825317  
richmond@carvergroup.co.uk

43 Dalton Way, Newton Aycliffe  
County Durham, DL5 4DJ  
Tel: 01325 320676  
aycliffe@carvergroup.co.uk

219 High Street, Northallerton  
North Yorkshire, DL7 8LW  
Tel: 01609 777710  
northallerton@carvergroup.co.uk