



**CARVER**  
RESIDENTIAL  
Sales · Lettings · Property Management

Burnbeck Place,  
Heighington Village, Newton Aycliffe, DL5 6RW  
**Offers in the region of £300,000**



An, extended home located at the head of a cul-de-sac in a popular village location which benefits from a highly sought after primary school, two local pubs/restaurants, village shop and takeaway. Heighington is situated amongst beautiful countryside and is within 15 minutes drive to Darlington train station. This superb family home briefly comprises entrance hallway, living room with open plan dining area with double doors leading out to the stunning rear garden. The kitchen is adjacent to the dining area. To the first floor there are five bedrooms and modern family shower room. Externally, there is off street parking to the front which leads to a single garage and to the rear a superb, lawned garden and patio area.







- LARGE REAR GARDEN
- HEAD OF CUL-DE-SAC
- GARAGE AND PARKING

- VILLAGE LOCATION
- EXTENDED HOME

**GENERAL INFORMATION:**

Tenure: Freehold

Services: Gas central heating, mains electric, water and drainage.

Double glazing

Local Authority: Darlington Borough Council (Tax Banding D)



















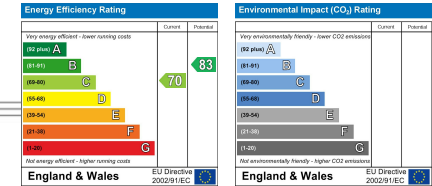
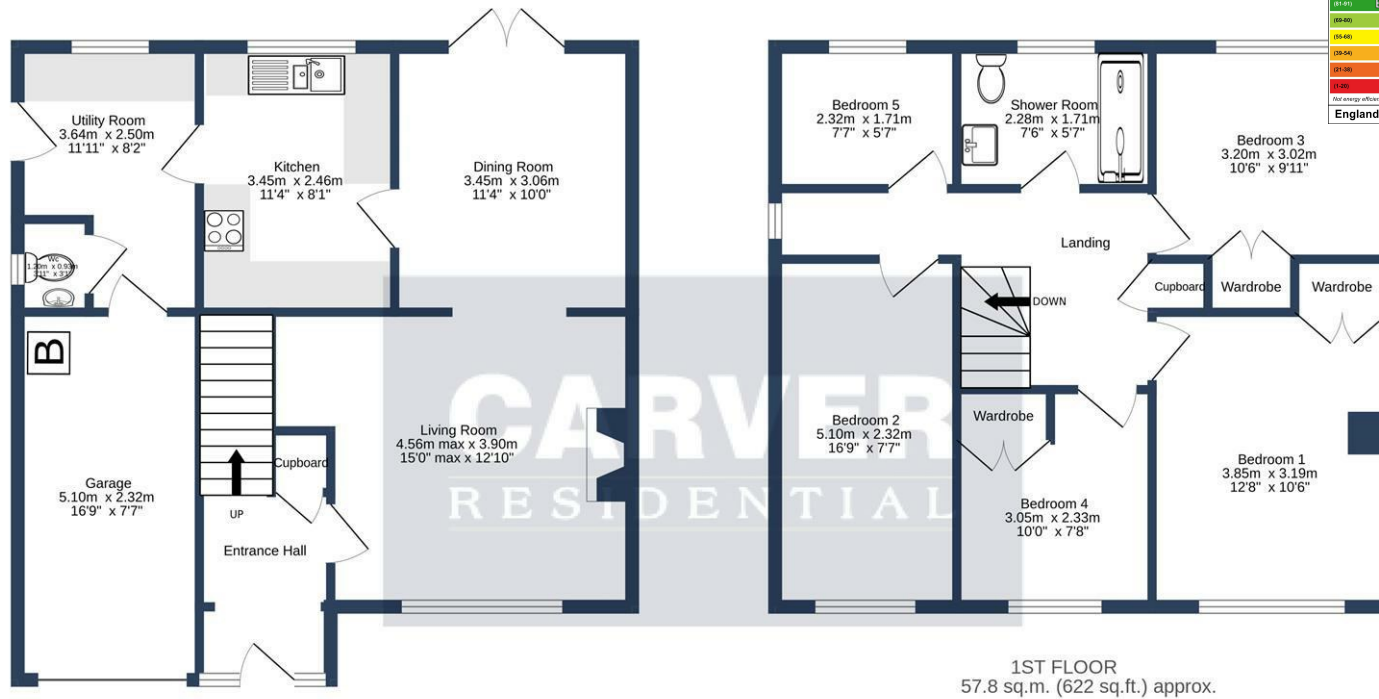

BURNBECK CLOSE, HEIGHINGTON VILLAGE, DL5 6RW.

TOTAL FLOOR AREA : 119.0 sq.m. (1281 sq.ft.) approx.

Whilst every attempt has been made to ensure the accuracy of the floorplan contained here, measurements of doors, windows, rooms and any other items are approximate and no responsibility is taken for any error, omission or mis-statement. This plan is for illustrative purposes only and should be used as such by any prospective purchaser. The services, systems and appliances shown have not been tested and no guarantee as to their operability or efficiency can be given.  
Made with Metropix ©2023

**We can search 1,000s of mortgages for you**

It could take just 15 minutes with one of our specialist advisers:  
Call: 01325 380088. Visit: Any of our Offices. Online: [www.mortgageadvicebureau.com/carver](http://www.mortgageadvicebureau.com/carver)



Your home may be repossessed if you do not keep up repayments on your mortgage. There will be a fee for mortgage advice. The actual amount you pay will depend upon your circumstances. The fee is up to 1% but a typical fee is 0.3% of the amount borrowed

MAB 6202



These particulars do not constitute any part of an offer or contract. None of the statements contained in these particulars are to be relied on as statements or representations of fact and any intending purchaser must satisfy himself by inspection or otherwise to the correctness of each of the statements contained in these particulars. The vendor does not make or give, and neither Nick & Gordon Carver Residential or Commercial, Nick & Gordon Carver, nor any person in their employment has any authority to make or give any representation or warranty whatever in relation to this property

80 High Street  
Yarm, TS15 9AH  
Tel: 01642 420090  
[yarm@carvergroup.co.uk](mailto:yarm@carvergroup.co.uk)

14 Duke Street, Darlington  
County Durham, DL3 7AA  
Tel: 01325 357807  
[sales@carvergroup.co.uk](mailto:sales@carvergroup.co.uk)

26 Market Place, Richmond  
North Yorkshire, DL10 4QG  
Tel: 01748 825317  
[richmond@carvergroup.co.uk](mailto:richmond@carvergroup.co.uk)

43 Dalton Way, Newton Aycliffe  
County Durham, DL5 4DJ  
Tel: 01325 320676  
[aycliffe@carvergroup.co.uk](mailto:aycliffe@carvergroup.co.uk)

219 High Street, Northallerton  
North Yorkshire, DL7 8LW  
Tel: 01609 777710  
[northallerton@carvergroup.co.uk](mailto:northallerton@carvergroup.co.uk)