



**CARVER**  
RESIDENTIAL  
Sales · Lettings · Property Management

Woodland Road  
Darlington, DL3 7PZ

**Offers in the region of £425,000**

House - Semi-Detached  
4 Bedroom/s  
2 Bathroom/s

Occupying a pleasing position, within the choicest of locations, with views to Holy Trinity Church to the front, and within easy walking distance of the town Centre.

This impressive double fronted semi-detached home retains many period features throughout all adding to the charm and character this family home has to offer. As soon as you enter the stunning hallway you will notice the return staircase, feature herringbone parquet flooring, and you will know that this is no ordinary home, offering two reception rooms, recently refitted kitchen with stunning granite work surfaces together with quality units and range oven, a handy utility room and cloaks/WC. To the first floor there are FOUR good sized bedrooms and family bathroom with Villeroy and Boch suite together with separate WC.

Externally the property is approached via an extensive DRIVEWAY, allowing off road parking for several vehicles, and GARAGE. Mature established well maintained gardens to both the front and rear, the large rear garden is perfect for all the family to enjoy.





- RETAINING MANY PERIOD FEATURES
- WALKING DISTANCE TO THE TOWN CENTRE
- REFITTED QUALITY KITCHEN
- HANDY UTILITY & CLOAKS/WC
- MATURE ESTABLISHED LARGE REAR GARDEN

- EXPANSIVE LIVING SPACE
- ACCESS TO ALL MAJOR ROADS, RAIL AND TRANSPORT LINKS
- TWO LARGE RECEPTION ROOMS
- FOUR SIZEABLE BEDROOMS
- EARLY VIEWING WILL IMPRESS

#### **GENERAL INFORMATION:**

Tenure: Freehold

Services: Gas central heating, mains electric, water and drainage.

Local Authority: Darlington Borough Council (Tax Banding D)

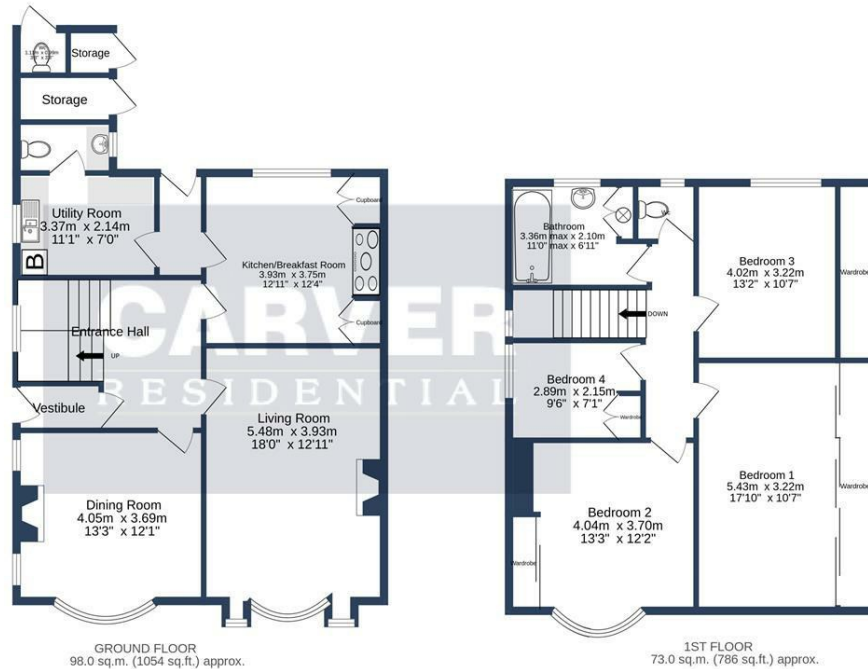

GROUND FLOOR 98.0 sq.m. (1054 sq.ft.) approx.  
1ST FLOOR 73.0 sq.m. (786 sq.ft.) approx.

WOODLAND ROAD, DARLINGTON. DL3 7PZ.

TOTAL FLOOR AREA : 171.0 sq.m. (1840 sq.ft.) approx.

Whilst every attempt has been made to ensure the accuracy of the floorplan contained here, measurements of doors, windows, rooms and any other items are approximate and no responsibility is taken for any error, omission or mis-statement. This plan is for illustrative purposes only and should be used as such by any prospective purchaser. The services, systems and appliances shown have not been tested and no guarantee as to their operability or efficiency can be given.  
Made with Metropix ©2023

Energy Efficiency Rating		Current	Potential
Very energy efficient - lower running costs			
(92 plus) <b>A</b>			<b>84</b>
(81-91) <b>B</b>			
(69-80) <b>C</b>			
(55-68) <b>D</b>		<b>58</b>	
(39-54) <b>E</b>			
(21-38) <b>F</b>			
(1-20) <b>G</b>			
Not energy efficient - higher running costs			
<b>England &amp; Wales</b>		EU Directive 2002/91/EC	

We can search 1,000s of mortgages for you

It could take just 15 minutes with one of our specialist advisers:  
Call: 01325 380088. Visit: Any of our Offices. Online: [www.mortgageadvicebureau.com/carver](http://www.mortgageadvicebureau.com/carver)



Your home may be repossessed if you do not keep up repayments on your mortgage. There will be a fee for mortgage advice. The actual amount you pay will depend upon your circumstances. The fee is up to 1% but a typical fee is 0.3% of the amount borrowed

MAB 6202



These particulars do not constitute any part of an offer or contract. None of the statements contained in these particulars are to be relied on as statements or representations of fact and any intending purchaser must satisfy himself by inspection or otherwise to the correctness of each of the statements contained in these particulars. The vendor does not make or give, and neither Nick & Gordon Carver Residential or Commercial, Nick & Gordon Carver, nor any person in their employment has any authority to make or give any representation or warranty whatever in relation to this property



14 Duke Street, Darlington  
Co Durham, DL3 7AA  
01325 357807  
[sales@carvergroup.co.uk](mailto:sales@carvergroup.co.uk)

43 Dalton Way, Newton Aycliffe  
Co Durham DL5 4DJ  
01325 320676  
[aycliffe@carvergroup.co.uk](mailto:aycliffe@carvergroup.co.uk)

41 Market Place, Richmond  
North Yorkshire, DL10 4QL  
01748 825317  
[richmond@carvergroup.co.uk](mailto:richmond@carvergroup.co.uk)

219 High Street, Northallerton  
North Yorkshire DL7 8LW  
01609 777710  
[northallerton@carvergroup.co.uk](mailto:northallerton@carvergroup.co.uk)