

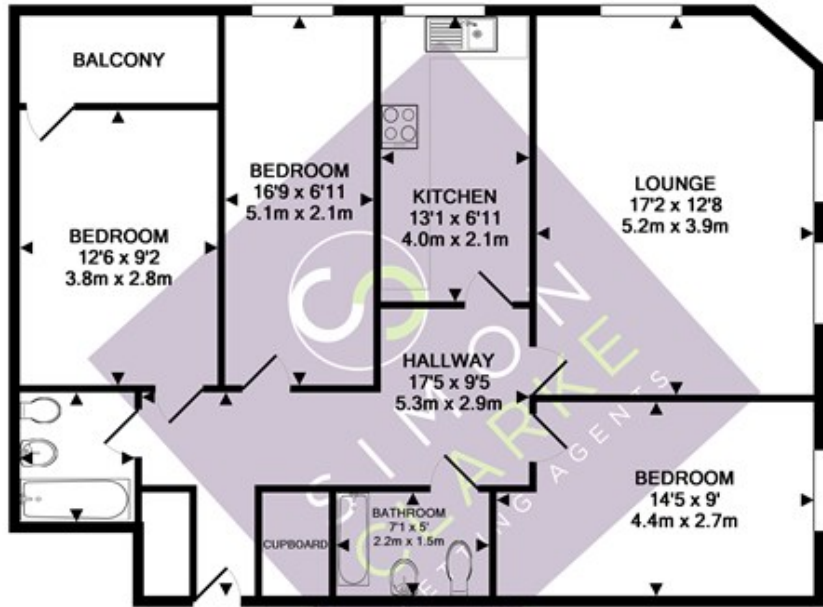

6 Naoroji Street, London, WC1X 0GD

£2,850 PCM

- 3 Double bedroom 2 bathroom apartment
- Attractive communal areas
- Large fitted kitchen with integral appliances
- Available NOW
- NEWLY DECORATED THROUGHOUT
- Spacious lounge with Juliet balcony
- Underfloor heating
- Concierge available
- Master bedroom with en-suite and balcony
- Lift serviced



TOTAL APPROX. FLOOR AREA 910 SQ.FT. (84.6 SQ.M.)

Whilst every attempt has been made to ensure the accuracy of the floor plan contained here, measurements of doors, windows, rooms and any other items are approximate and no responsibility is taken for any error, omission or mis-statement. This plan is for illustrative purposes only and should be used as such by any prospective tenant. The services, systems and appliances shown have not been tested and no guarantee as to their operability or efficiency can be given. Simon Clarke Letting Agents
Made with Metropix ©2018

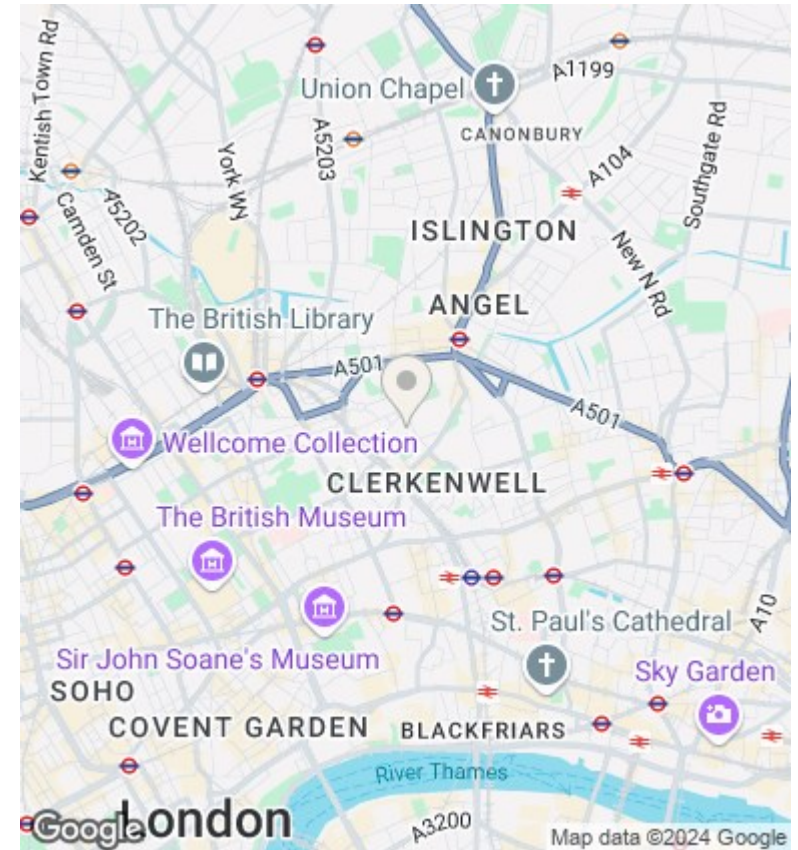

Directions

Viewings

Viewings by arrangement only. Call 02083499000 to make an appointment.

Council Tax Band

D

EPC Rating:

B

Energy Efficiency Rating		
	Current	Potential
Very energy efficient - lower running costs		
(92 plus) A		
(81-91) B	82	83
(69-80) C		
(55-68) D		
(39-54) E		
(21-38) F		
(1-20) G		
Not energy efficient - higher running costs		
England & Wales	EU Directive 2002/91/EC	