

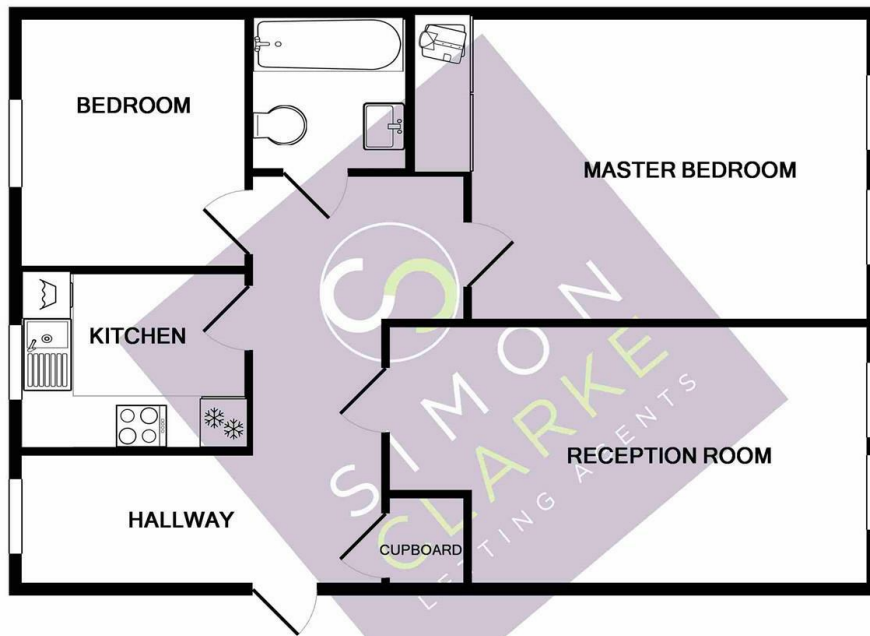

Lyonsdown Road, EN5 1SX

£1,650 PCM

- First floor two bedroom flat
- Fitted bathroom suite with shower over bath
- Available on long term tenancy (initial 12 months)
- Available from 12th November 2024
- Modern fitted kitchen with appliances
- Walking distance to New Barnet BR Station
- Council Tax band C - £1,727.32 per annum
- Allocated off street parking
- Electric heating / Video entry phone
- Unfurnished



Whilst every attempt has been made to ensure the accuracy of the floor plan contained here, measurements of doors, windows, rooms and any other items are approximate and no responsibility is taken for any error, omission or mis-statement. This plan is for illustrative purposes only and should be used as such by any prospective tenant. The services, systems and appliances shown have not been tested and no guarantee as to their operability or efficiency can be given. Simon Clarke Letting Agents.
Made with Metropix ©2019

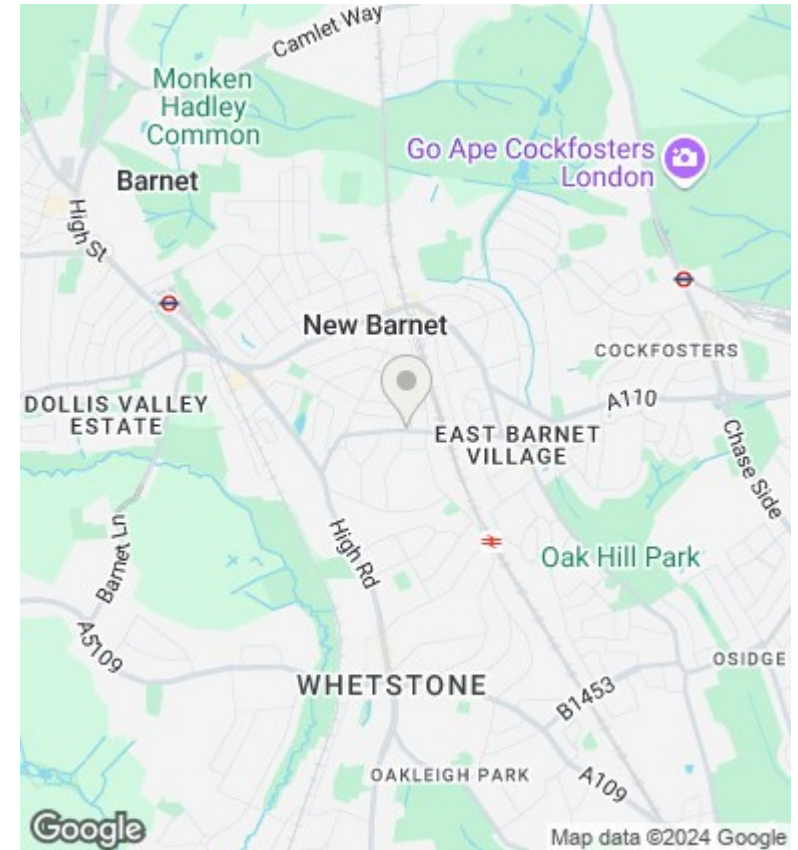

Directions

Viewings

Viewings by arrangement only. Call 02083499000 to make an appointment.

Council Tax Band

C

EPC Rating:

C

Energy Efficiency Rating		
	Current	Potential
<i>Very energy efficient - lower running costs</i>		
(92 plus) A		
(81-91) B		
(69-80) C	76	84
(55-68) D		
(39-54) E		
(21-38) F		
(1-20) G		
<i>Not energy efficient - higher running costs</i>		
England & Wales	EU Directive 2002/91/EC	