

## Woburn Place, WC1H

### £300,000

A newly renovated studio apartment located within an iconic red-brick mansion block in central Bloomsbury. The property has been re-wired and includes a new separate kitchen, family bathroom and rear facing studio room.

Russell Court is a purpose-built mansion building moments from Russell Square and The Brunswick shopping centre which contains many well-known high street shops and restaurants.

### Features

- Newly Refurbished
- Share Of Freehold
- Separate Kitchen
- 24 Hour Concierge
- Lift Access
- No Onward Chain

# Woburn Place, London, WC1H

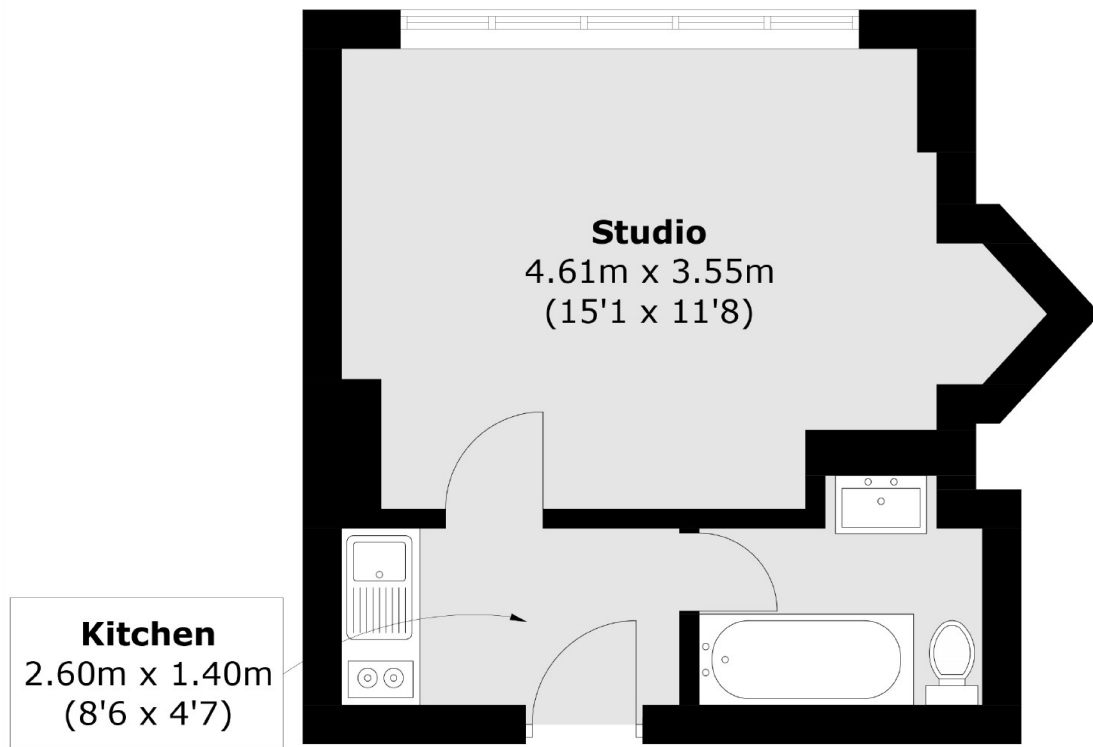

## Second Floor

Total area (approx.): 24.4 sq. m (262.6 sq. ft)