

## Boswell Street, WC1N

£600 Per week

This split level two double bedroom flat is perfectly located for LSE and UCL students. It has an open plan living area, equal sized bedrooms and walk in shower.

The flat is on the top floor of a purpose built building on Boswell Street, just off Queen Square with easy access to Holborn and Russell Square underground stations. UCL and LSE are both a short walk away.

### Features

Two Bedroom  
Duplex Apartment  
Russell Square Nearby  
Holborn Station  
Ideal For Sharers  
Open Plan Reception

# Boswell Street, London, WC1N



4th Floor

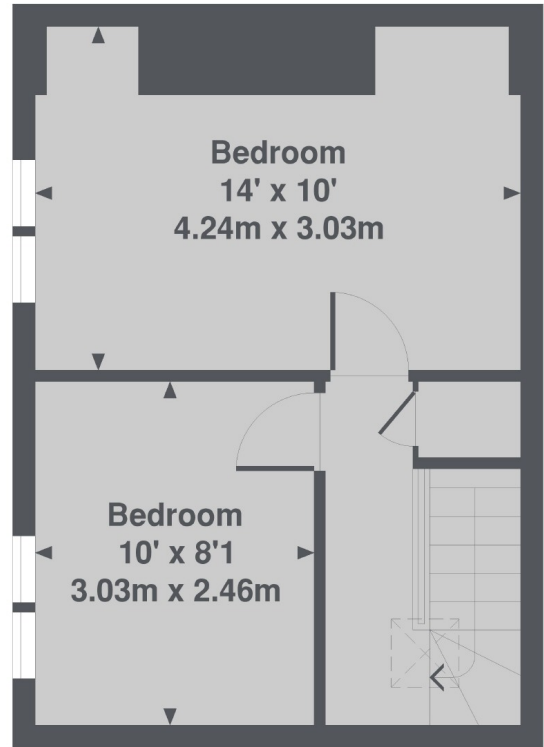

5th Floor

Bevan House, Boswell Street, WC1N  
Total Approx. Floor area 532 Sq. Ft. (49.4 Sq. M.)

## Dexters

Bloomsbury  
55-56 Coram Street  
London  
WC1N 1HB  
Lettings  
020 7833 4488

Energy Rating: D. We aim to make our particulars both accurate and reliable. However they are not guaranteed; nor do they form part of an offer or contract. If you require clarification on any points then please contact us, especially if you're traveling some distance to view. Please note that appliances and heating systems have not been tested and therefore no warranties can be given as to their good working order.



[dexters.co.uk](https://www.dexters.co.uk)