



## Woburn Place, WC1H

£450 Per week

A well presented studio flat with a separate kitchen available to move in from September 2023. The flat has wooden floors, good storage and a double pull down bed. 24 hour porter. Heating, hot water and water included in the rent.

Russell Court is situated in Russell Square a few minutes walk from the station and square. It is also situated conveniently for UCL, Brunswick centre and for all of what Bloomsbury has to offer.

### Features

Studio Flat  
Separate Kitchen  
Wooden Floors  
24 Hour Porter  
Russell Square Tube  
Heating & Hot Water Inc

Woburn Place,  
London, WC1H

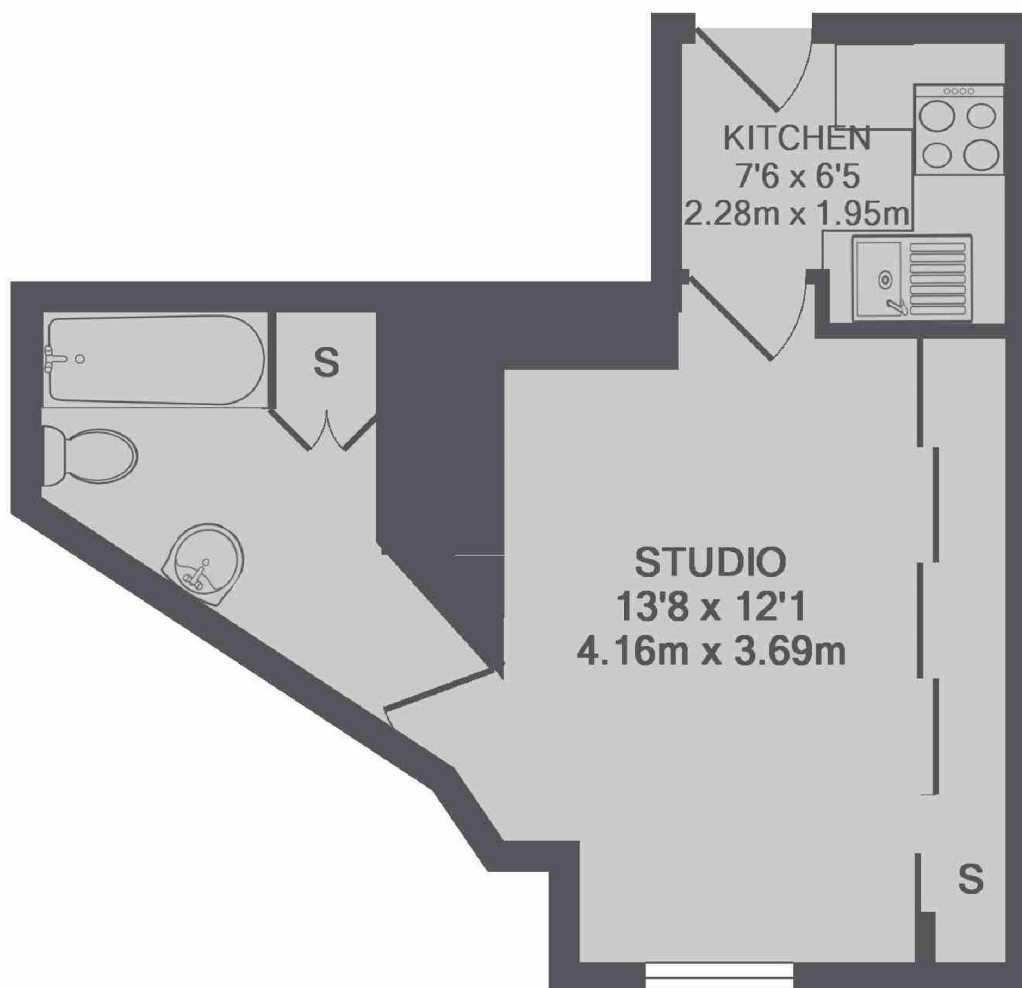

TOTAL APPROX. FLOOR AREA 274 SQ.FT. (25.5 SQ.M.)

**Dexters**

Bloomsbury  
55-56 Coram Street  
London  
WC1N 1HB  
Lettings  
020 7833 4488

Energy Rating: C. We aim to make our particulars both accurate and reliable. However they are not guaranteed; nor do they form part of an offer or contract. If you require clarification on any points then please contact us, especially if you're traveling some distance to view. Please note that appliances and heating systems have not been tested and therefore no warranties can be given as to their good working order.

 **RICS** | Regulated  
Estate Agent  
and Letting Agent

[dexters.co.uk](https://www.dexters.co.uk)