

## Upper St. Martin's Lane, WC2H

### £695,000

A well-presented one-bedroom apartment ideally positioned in the heart of Covent Garden. Set within a purpose-built development with lift access, this second-floor residence is moments from the Covent Garden Piazza and West End theatres. The property features secondary glazed windows throughout, a spacious reception room, a modern fully fitted kitchen, a generous double bedroom with built-in wardrobes, and a contemporary tiled bathroom.

Located on Upper St. Martin's Lane, Meridian Place is just 0.1 miles from Leicester Square Underground Station, with easy access to Piccadilly Circus and a range of transport links nearby.

### Features

- One Double Bedroom
- Lift Access
- Excellent Central Location
- Great Condition
- Gated Private Parking
- No Onward Chain

# Upper St. Martin's Lane, London, WC2H

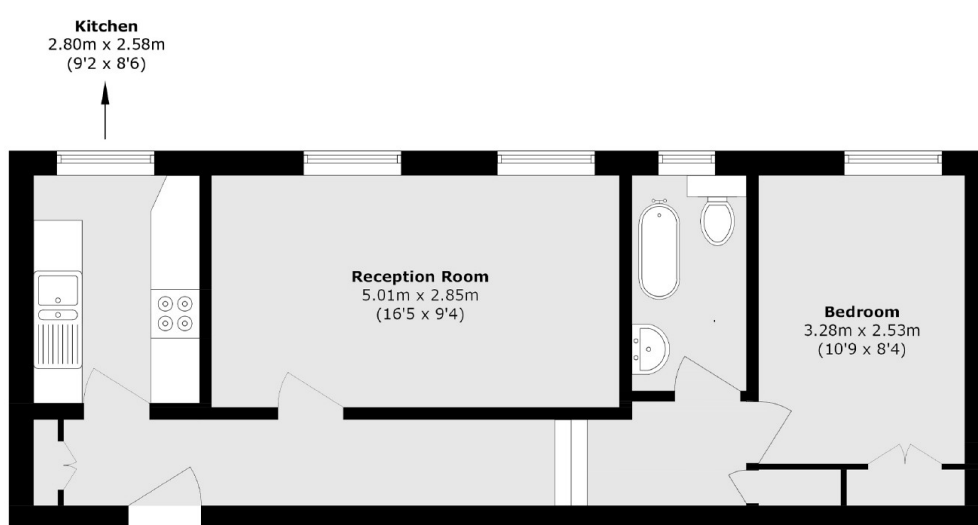

Total area (approx.): 46.4 sq. m (499.4 sq. ft)