



Judd Street, WC1H

£525 Per week

A modern one bedroom apartment on the fourth floor of this well kept mansion building on Judd Street. It has a separate reception room, double bedroom, modern kitchen and contemporary bathroom. It is neutrally decorated with carpets throughout.

Jessel House is located a short walk away from Russell Square tube station and the Brunswick Shopping Centre making the flat ideal for those who want to be centrally located with lots of shops, bars, restaurants and transport on their doorstep.

Features

- One Bedroom
- Modern
- Brunswick Centre Nearby
- UCL Nearby
- Bike Storage
- Lift

Judd Street, London, WC1H

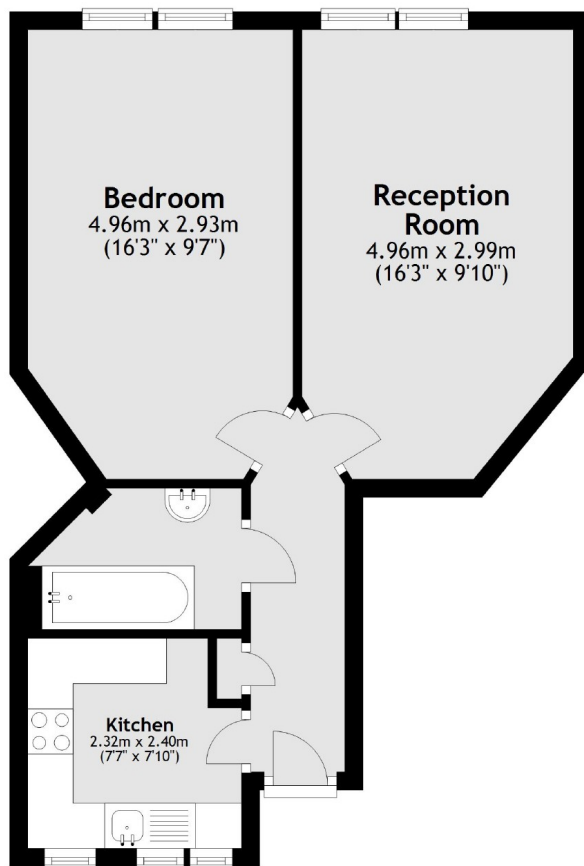

Total area: approx. 41.4 sq. metres (446.1 sq. feet)