



Rodney Street, N1

£995 Per week

A spacious, modern and well-presented two double bedroom, two bathroom apartment with a large balcony in this highly acclaimed and sought after development. Residents also have the benefit of direct access to the buildings private gym, pool and spa.

Fitzgerald Court is a new build next to King's Cross and St Pancras Station, giving easy access to anywhere in London. The property is nearby an array of shops, bars and restaurants, including the newly developed Coal Drops Yard.

Features

- 24 hour Concierge
- Gym & Pool
- Large Balcony
- Easy Access to Kings Cross
- New Build
- Underfloor Heating

Rodney Street,
London, N1

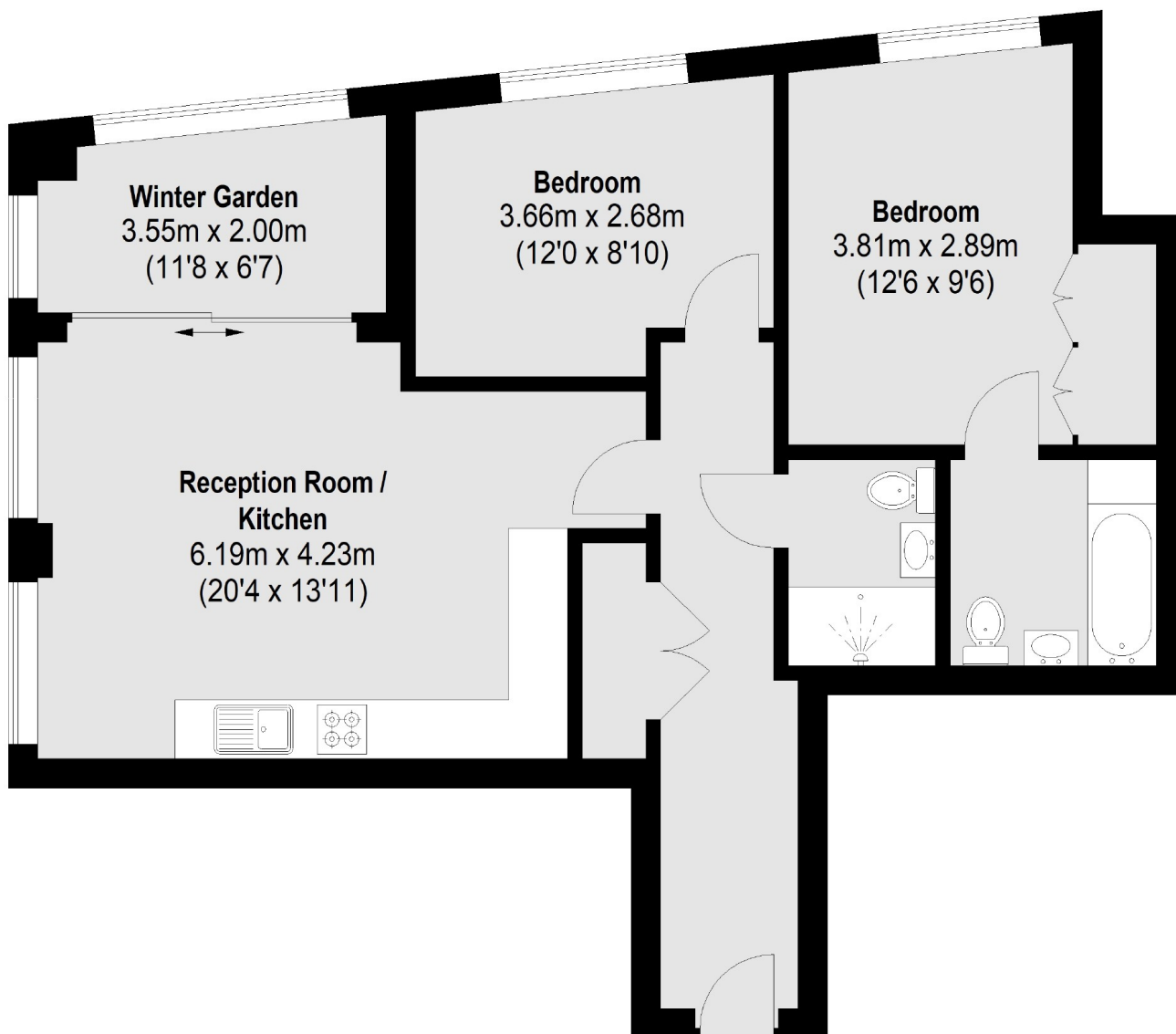

First Floor

Total area (approx.): 68.25 sq. m (735 Sq. ft)
Winter Garden: 6.51 sq. m (70 Sq. ft)

Dexters

Bloomsbury
55-56 Coram Street
London
WC1N 1HB
Lettings
020 7833 4488

Energy Rating: B. We aim to make our particulars both accurate and reliable. However they are not guaranteed; nor do they form part of an offer or contract. If you require clarification on any points then please contact us, especially if you're traveling some distance to view. Please note that appliances and heating systems have not been tested and therefore no warranties can be given as to their good working order.

 **RICS** | Regulated
Estate Agent
and Letting Agent

dexters.co.uk