



Coram Street, WC1N

£715 Per week

A well presented apartment on the first floor of this sought after and centrally located Portered building, The apartment has two bedrooms, a spacious lounge with wood flooring, eat-in kitchen diner and modern bathroom suite.

Witley Court is located just 400 ft from the Brunswick Centre which offers a good range of high street shops and restaurants. It is also convenient for UCL, UCLH, Euston and Kings Cross.

Features

- Two Bedrooms
- Modern Apartment
- Hot Water Included
- Heating Included
- Separate Kitchen
- Portered Building

Coram Street,
London, WC1N

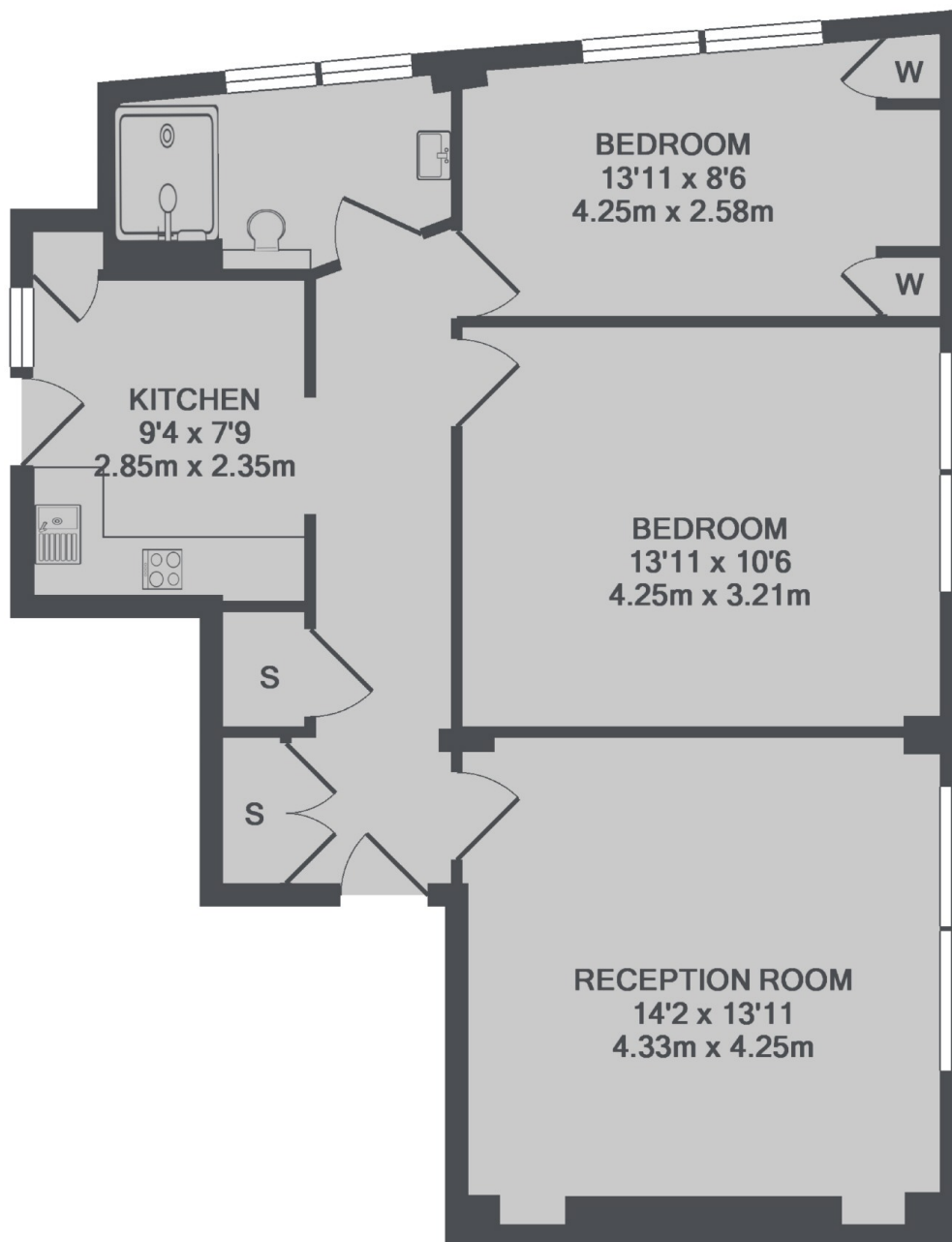

TOTAL APPROX. FLOOR AREA 700 SQ.FT. (65.0 SQ.M.)

Dexters

Bloomsbury
55-56 Coram Street
London
WC1N 1HB
Lettings
020 7833 4488

Energy Rating: D. We aim to make our particulars both accurate and reliable. However they are not guaranteed; nor do they form part of an offer or contract. If you require clarification on any points then please contact us, especially if you're traveling some distance to view. Please note that appliances and heating systems have not been tested and therefore no warranties can be given as to their good working order.

 **RICS** | Regulated
Estate Agent
and Letting Agent

[dexters.co.uk](https://www.dexters.co.uk)