



## Regent Square, WC1H

£530 Per week

This charming one-bedroom flat in Regent Square offers a bright and airy living space with beautiful wooden flooring throughout. The spacious bedroom includes a fitted wardrobe, providing excellent storage solutions. Large windows fill the flat with natural light and offer a picturesque view of Regent Square Garden.

Regent Square is located a short walk from Russell Square Underground station to the South and King's Cross station to the North. There is a wide array of shops, bars and restaurants locally in Bloomsbury as well as the Brunswick shopping centre.

### Features

- Prime Location
- Spacious Bedroom
- Fitted Wardrobe
- Natural Light
- Garden Views
- Excellent Storage

# Regent Square, London, WC1H

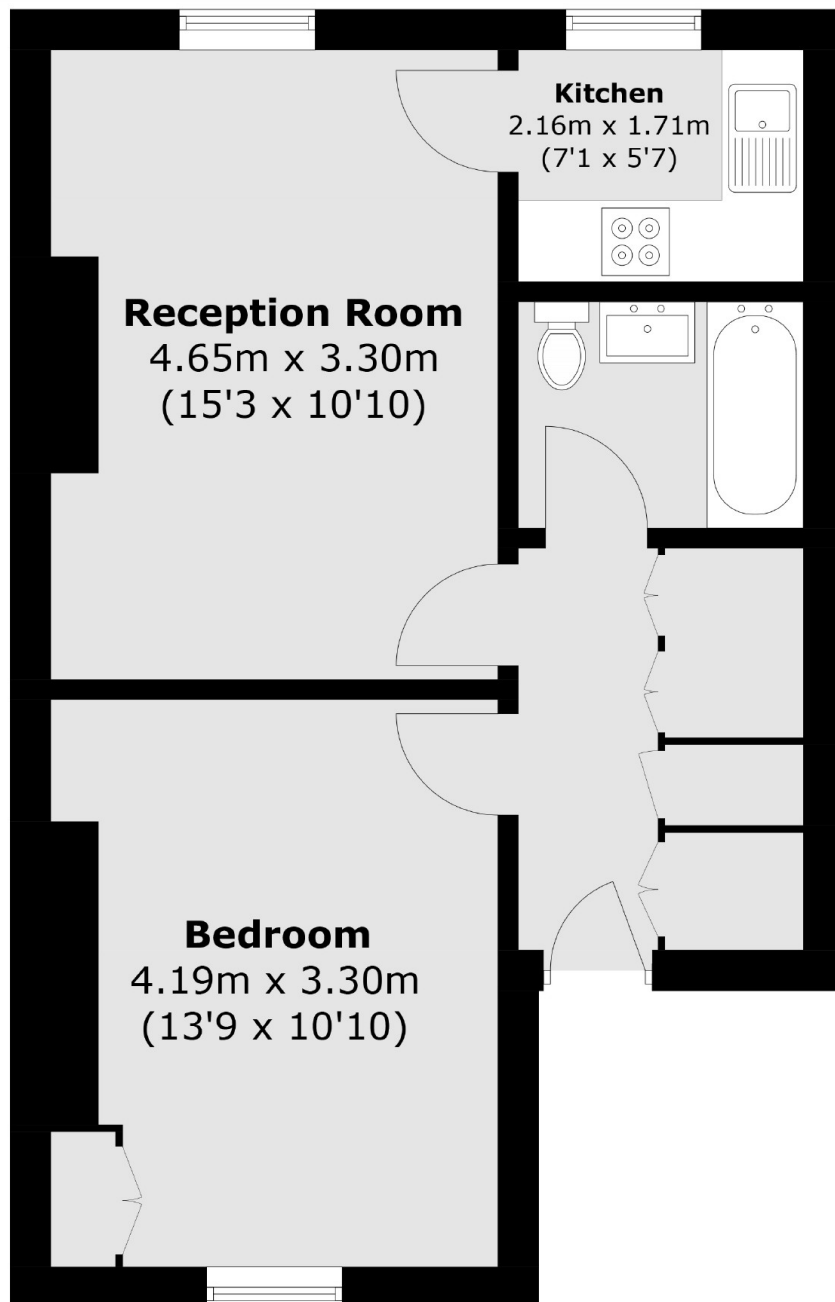

Total area (approx.): 44.7 sq. m (481.1 sq. ft)