



## John Adam Street, WC2N

### £850,000

This elegant two-bedroom apartment is located on the second floor of The Little Adelphi. It offers refined city living within a prestigious, secure development in the heart of London's West End. The apartment features a light-filled reception room, a separate kitchen and two double bedrooms with custom-fitted wardrobes. Additional benefits include a 24-hour porter service and a dedicated underground parking space, providing both convenience and peace of mind in the heart of London.

The Little Adelphi is situated just south of the Strand, within walking distance of the serene Embankment Gardens, the River Thames, and the vibrant Covent Garden Piazza, known for its boutique shops, designer stores, bars, and restaurants. Covent Garden, Charing Cross, and Embankment stations are also nearby, offering excellent transport links throughout the city.

### Features

- Two Bedrooms
- Separate Kitchen
- Lift
- 24hour Concierge
- Secure Underground Parking
- No Onward Chain

# John Adam Street, London, WC2N

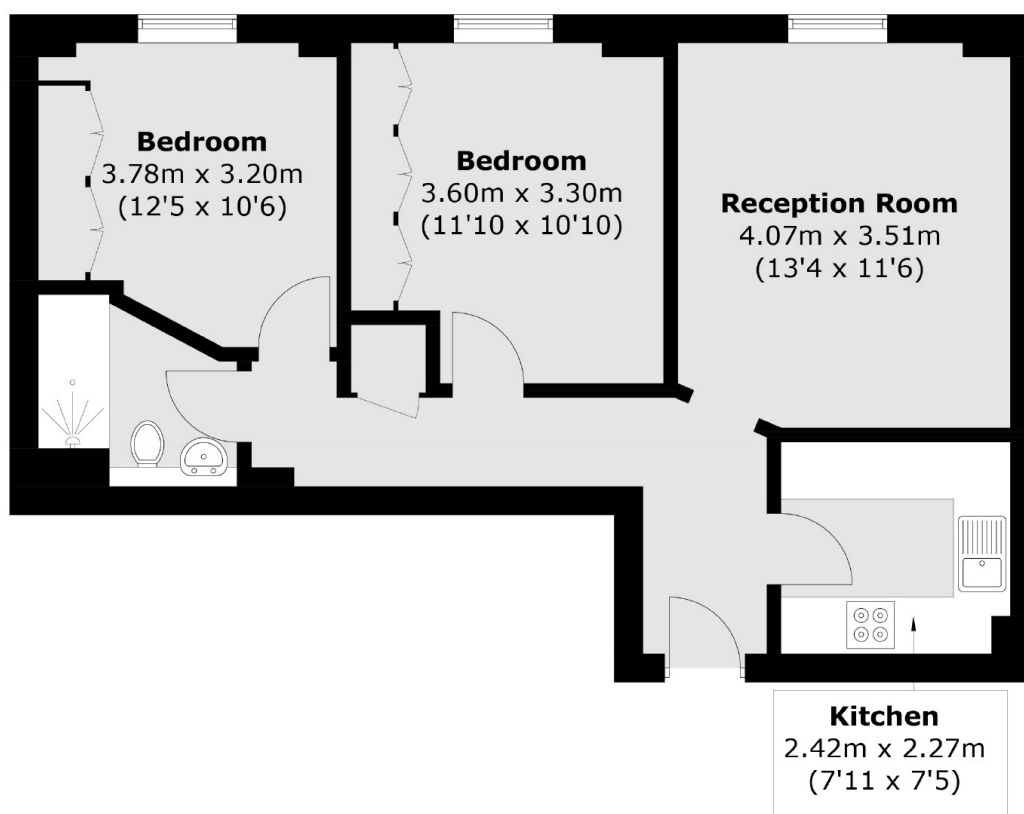

Total area (approx.): 55.1 sq. m (593.1 sq. ft)