

Flaxman Terrace, WC1H

£300 Per week

A well presented one double bedroom flat on the top floor of a secure building in Bloomsbury. The property has a spacious lounge, separate kitchen and a modern shower room and wooden floors throughout.

Flaxman Terrace is a red brick building situated near to Kings Cross and Russell Square. It has secure access and a lift to all floors. It is also very convenient for UCL, Brunswick Centre and SOAS.

Features

- One Bedroom
- Separate Kitchen
- Wooden Floorboards
- Kings Cross Nearby
- Secure Building
- Top Floor

Flaxman Terrace, London, WC1H

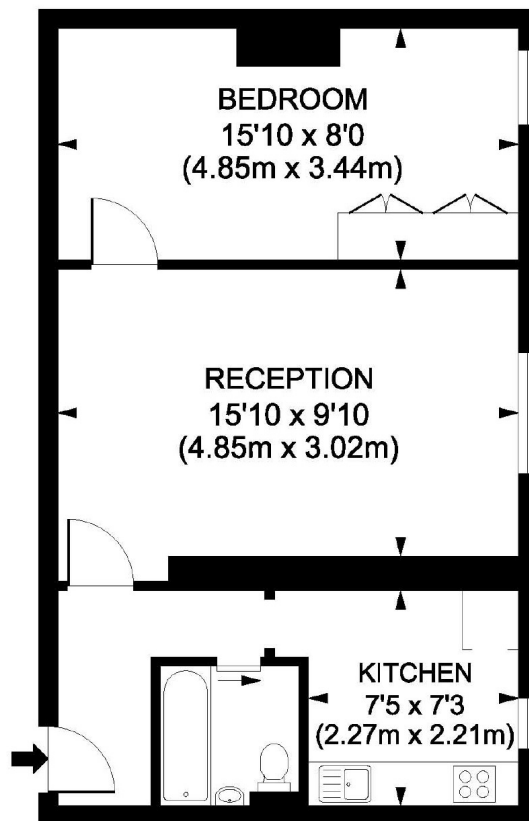

FIFTH FLOOR

Flaxman Court, London, WC1
Gross internal area 430 sq ft/40 sq metres

Whilst every attempt has been made to ensure the accuracy of the floorplan shown, all measurements, positioning fixtures, fittings and any other data shown are an approximate interpretation for illustrative purposes only and are not to scale. No responsibility is taken for any error, omission, miss-statement or use of data shown.

Contact

To arrange a viewing call our office on the number below or visit our website.



Energy Rating: D. We aim to make our particulars both accurate and reliable. However they are not guaranteed; nor do they form part of an offer or contract. If you require clarification on any points then please contact us, especially if you're traveling some distance to view. Please note that appliances and heating systems have not been tested and therefore no warranties can be given as to their good working order.