



## Kenton Street, WC1N

### £850,000

A well-presented two-bedroom apartment located on the second floor of a red brick mansion block in the heart of Bloomsbury. The property features two double bedrooms with fitted wardrobes, a modern eat-in kitchen equipped with NEFF and Bosch appliances, and a contemporary bathroom with marble flooring.

Aberdeen Mansions is set within central Bloomsbury close to The Brunswick Centre, Russell Square underground and numerous shops, bars and restaurants.

### Features

- Two Double Bedrooms
- Excellent Condition
- High Ceilings
- Danish Oak Flooring
- Central Bloomsbury
- Attractive Bay Window

# Kenton Street, London, WC1N

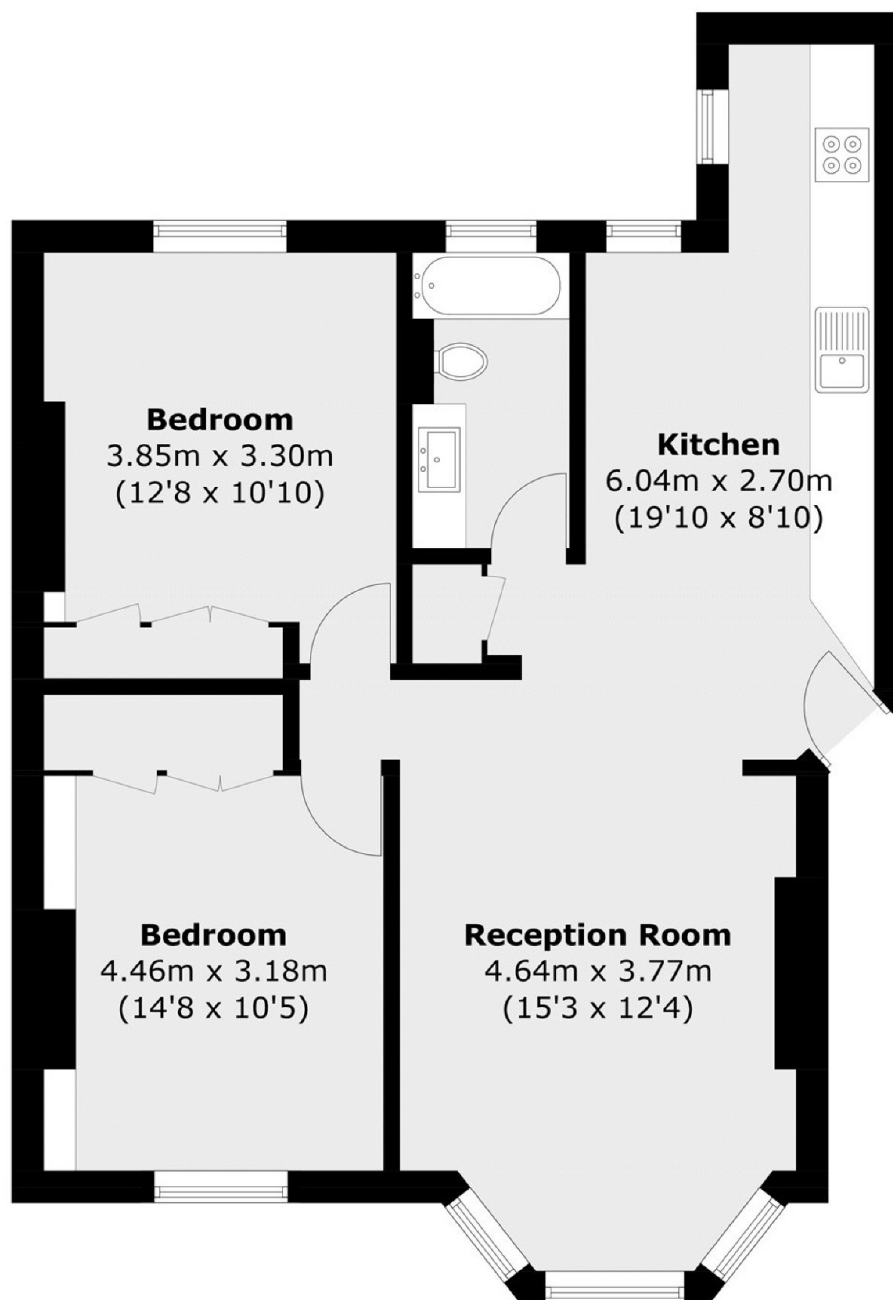

Total area (approx.): 68.6 sq. m (738.4 sq. ft)

## Dexters

Bloomsbury  
55-56 Coram Street  
London  
WC1N 1HB  
Sales  
020 7833 4466

Energy Rating: C. We aim to make our particulars both accurate and reliable. However they are not guaranteed; nor do they form part of an offer or contract. If you require clarification on any points then please contact us, especially if you're traveling some distance to view. Please note that appliances and heating systems have not been tested and therefore no warranties can be given as to their good working order.

 **RICS** | Regulated  
Estate Agent  
and Letting Agent

[dexters.co.uk](https://www.dexters.co.uk)