



Flaxman Terrace, WC1H

£500,000

A well appointed one double bedroom home set within a red brick mansion block close to transport and excellent amenities. The building has undergone major refurbishment including new windows and is available with no onward chain.

Located within central Bloomsbury on a secluded side road, Flaxman Terrace is a well managed mansion block within close proximity to an array of amenities including London's Euston and St Pancras.

Features

- One Double Bedroom
- Over 450 Sq Ft
- Lift Access
- Parking Available
- Communal Garden
- No Onward Chain

Flaxman Terrace, London, WC1H

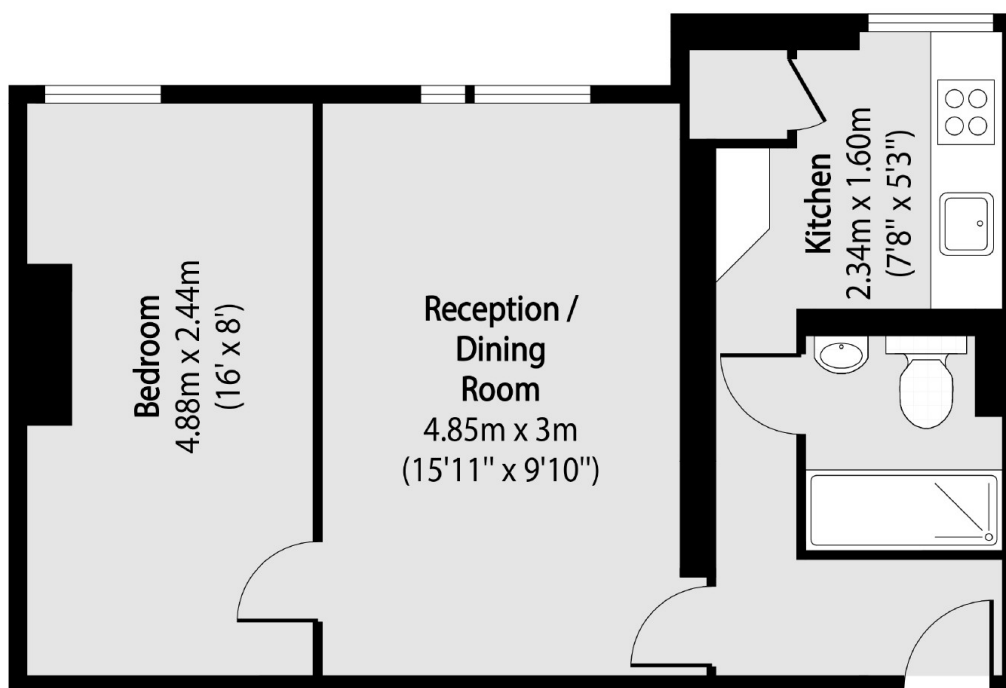

Total area (approx): 41.89 sq m (451 sq. ft)