



Birkenhead Street, WC1H

£480,000

A well-appointed two-bedroom home located in a purpose-built block with lift access, a private balcony and separate kitchen. The property being sold with a tenant in situ until September 2025 paying £2,816 per month.

Riverside is located on Birkenhead Street which is opposite King's Cross St Pancras including all the conveniences at the newly developed Coal Drops Yard.

Features

- Two Bedrooms
- Lift Access
- Private Balcony
- Close to Transport
- Excellent Rental Yield
- No Onward Chain

Birkenhead Street, London, WC1H

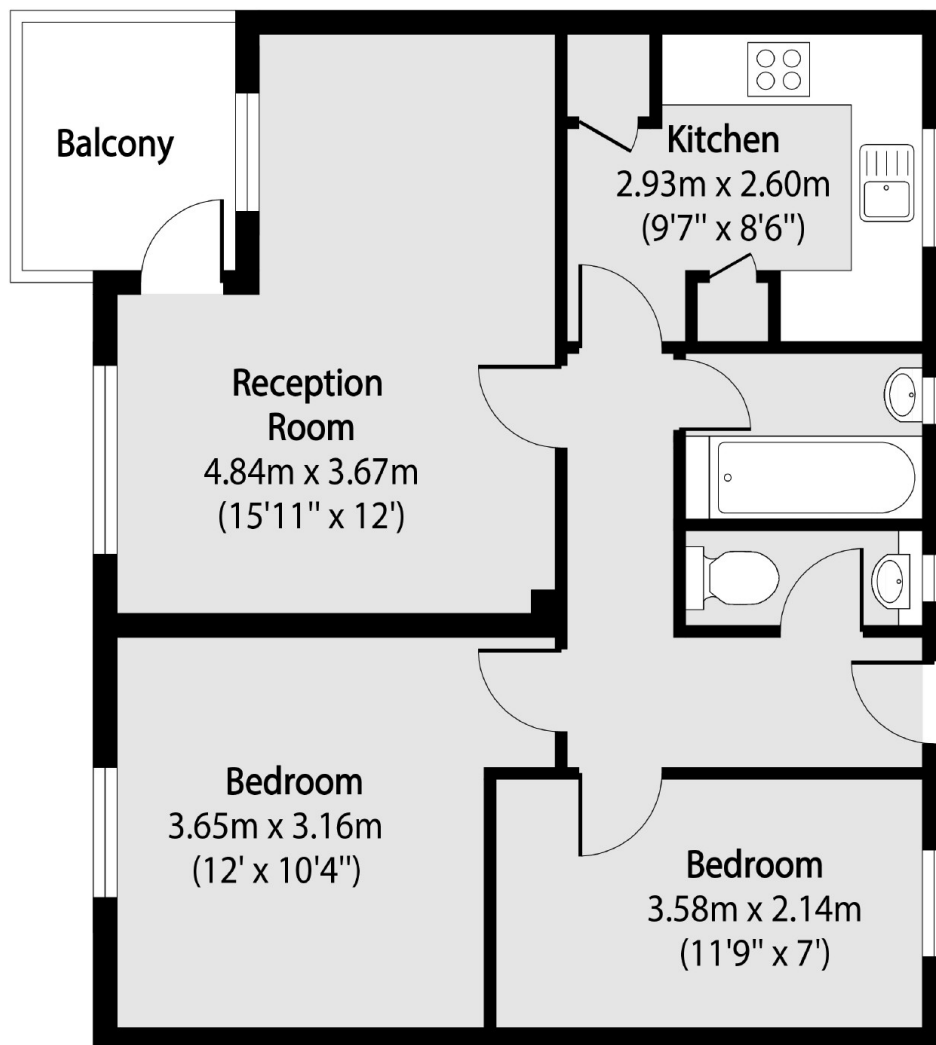

Total area (approx): 54.48 sq m (586 sq. ft)

Balcony total area (approx): 3.78 sq m (41 sq. ft)