



Woburn Place, WC1H

£280,000

This studio flat is located on the top floor of this 1930s mansion block. The flat has a West facing aspect and comprises entrance hallway with fitted cupboards, separate kitchen, bathroom and studio room.

Russell Court is located around the corner from Russell Square tube station and a very short walk from UCL university and the Brunswick Centre for shopping, restaurants, cafés and bars.

Features

- Ninth (Top Floor)
- Studio
- West Facing
- 24 Hour Concierge
- Share of Freehold
- Russell Square Tube

Woburn Place, London, WC1H

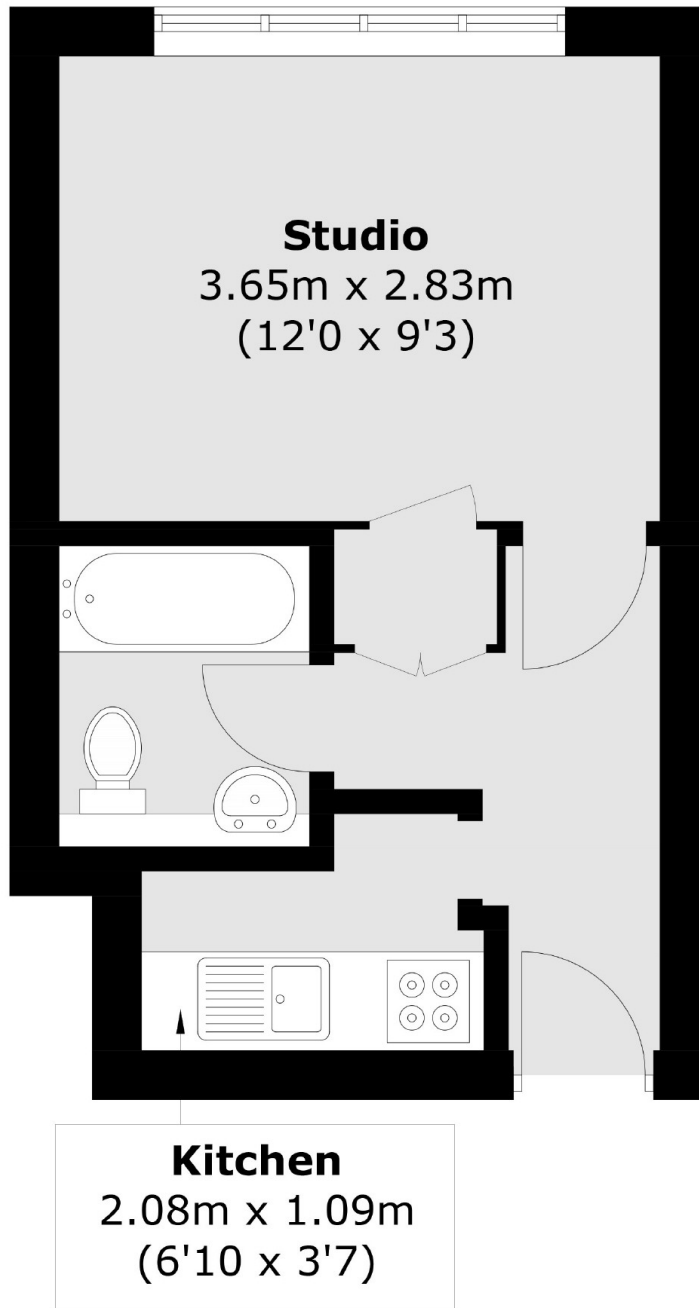

Total area (approx.): 21.6 sq. m (232.5 sq. ft)