

Wharfdale Road, N1

£625 Per week

Features

Wharfdale Road,
London, N1

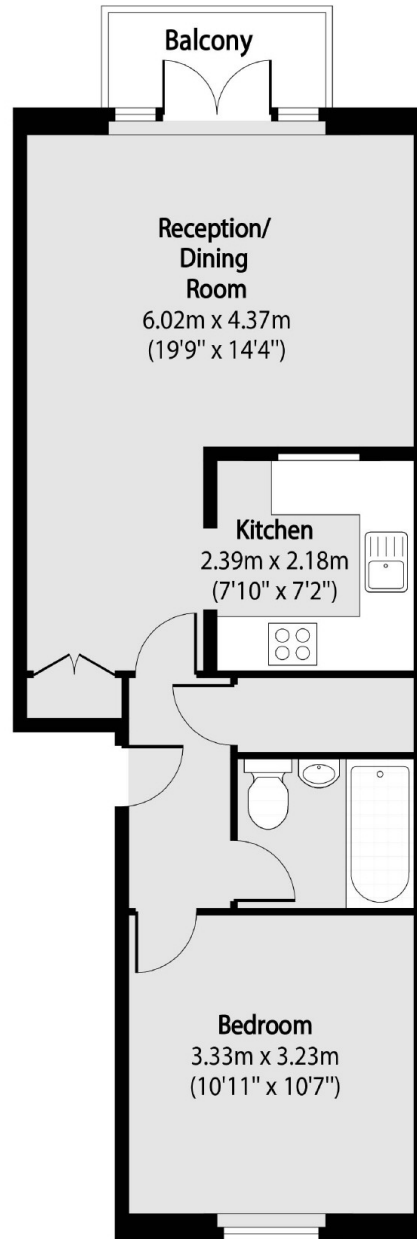

Total area (approx): 46.27 sq m (498 sq. ft)

Balcony total area (approx): 2.60 sq m (28 sq. ft)

Dexters

Bloomsbury
55-56 Coram Street
London
WC1N 1HB

Lettings
020 7833 4488

Energy Rating: C. We aim to make our particulars both accurate and reliable. However they are not guaranteed; nor do they form part of an offer or contract. If you require clarification on any points then please contact us, especially if you're traveling some distance to view. Please note that appliances and heating systems have not been tested and therefore no warranties can be given as to their good working order.

 **RICS** | Regulated
Estate Agent
and Letting Agent

dexters.co.uk