



## Judd Street, WC1H

£612 Per week

Two double bedroom flat with a spacious living room. It has a daytime time porter at the reception at the entrance to the building. It has three separate rooms and a separate kitchen. Lift access and shower over bath.

Clare Court is a listed art deco block situated but set back from Judd Street in central Bloomsbury. The tube station of Russell Square and Kings Cross are both convenient and nearby. Perfect location for students at UCL, LSE or SOAS.

### Features

- Two Bedroom Flat
- Reception Room
- Secure Block
- Separate Kitchen
- Porter
- Close to UCL & SOAS

Judd Street,  
London, WC1H

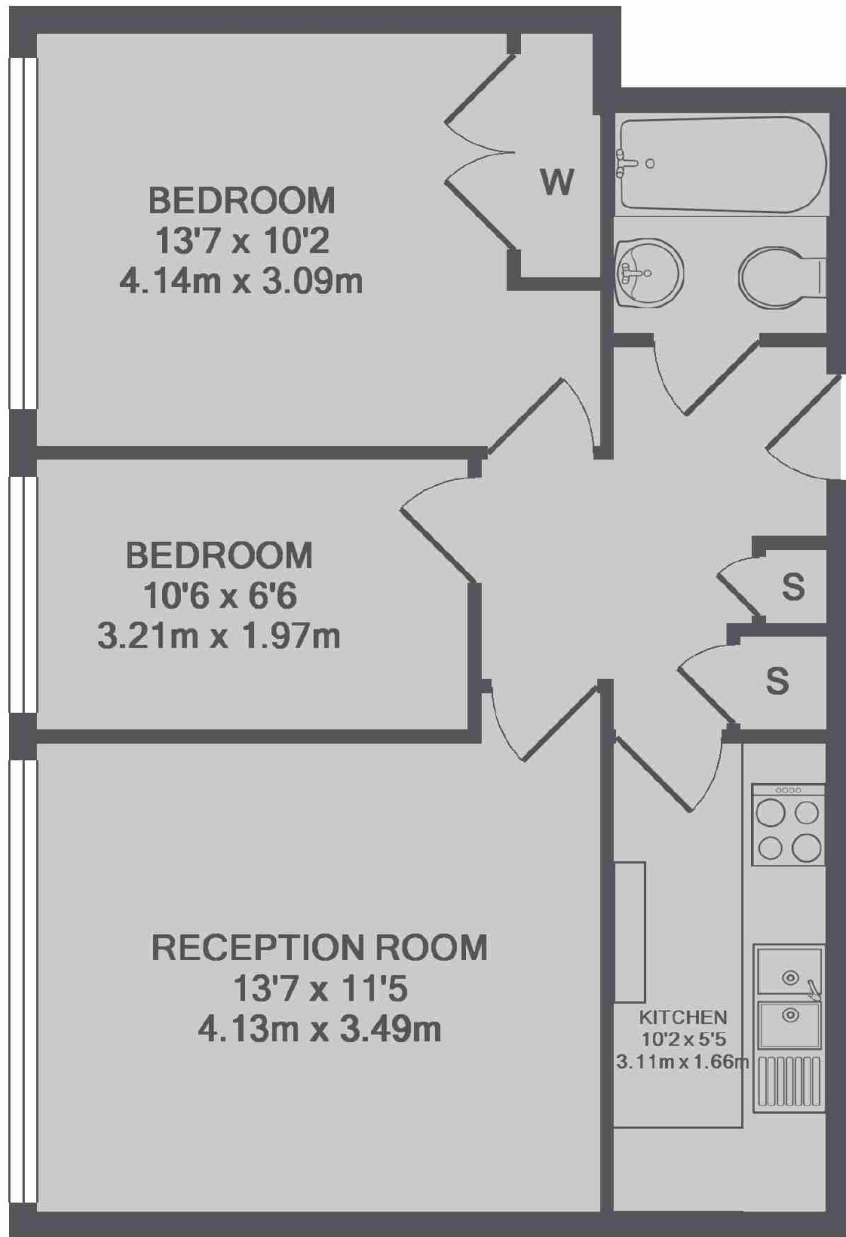

TOTAL APPROX. FLOOR AREA 539 SQ.FT. (50.1 SQ.M.)