



## Balfe Street, N1

£650 Per week

A well presented two bedroom split level apartment on the first floor of this Georgian conversion. The apartment has a spacious reception with separate kitchen, two double bedrooms and modern bathroom suite.

Balfe Street is a stones throw from Kings Cross/St Pancras station. It is very conveniently located for all links for central London and beyond. It is a quiet street with residents parking and is well located for UCL, SOAS and Central Saint Martins.

### Features

- Georgian Property
- Two Double Bedrooms
- Split Level
- Modern Kitchen
- Wooden Floors
- Great Location

# Balfe Street, London, N1

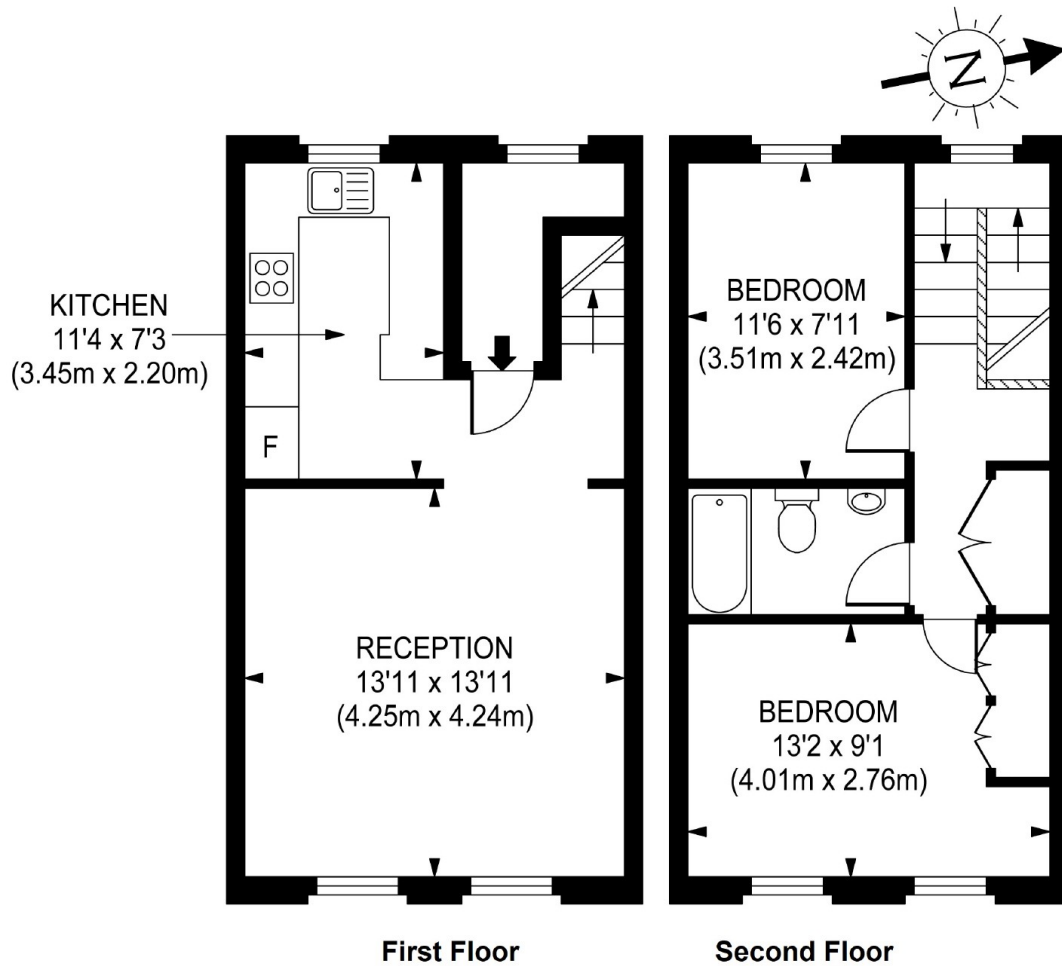

Gross Internal Area 700 sq ft/ 65 sq meters

Whilst every attempt had been made to ensure the accuracy of the floorplan shown, all the measurements, positioning fixtures, fittings and any other data shown are an approximate interpretation for illustrative purposes only and are not for scale. No responsibility is taken for any error, omission, miss-statement or use of data shown.