



Woburn Place, WC1H

£310,000

A well appointed studio apartment in the heart of Bloomsbury with a separate kitchen and has been recently renovated to a high standard throughout. This studio will suit any first time buyer or second home owner wanting excellent security.

Russell Court occupies a prominent position within central London which offers excellent transport links and good access to top restaurants, bars, shopping and Universities.

Features

- Studio Apartment
- Re-furnished Throughout
- Lift Access
- 24 Hr Porter
- Share of Freehold
- Offers in Excess of £325,000

Woburn Place, London, WC1H

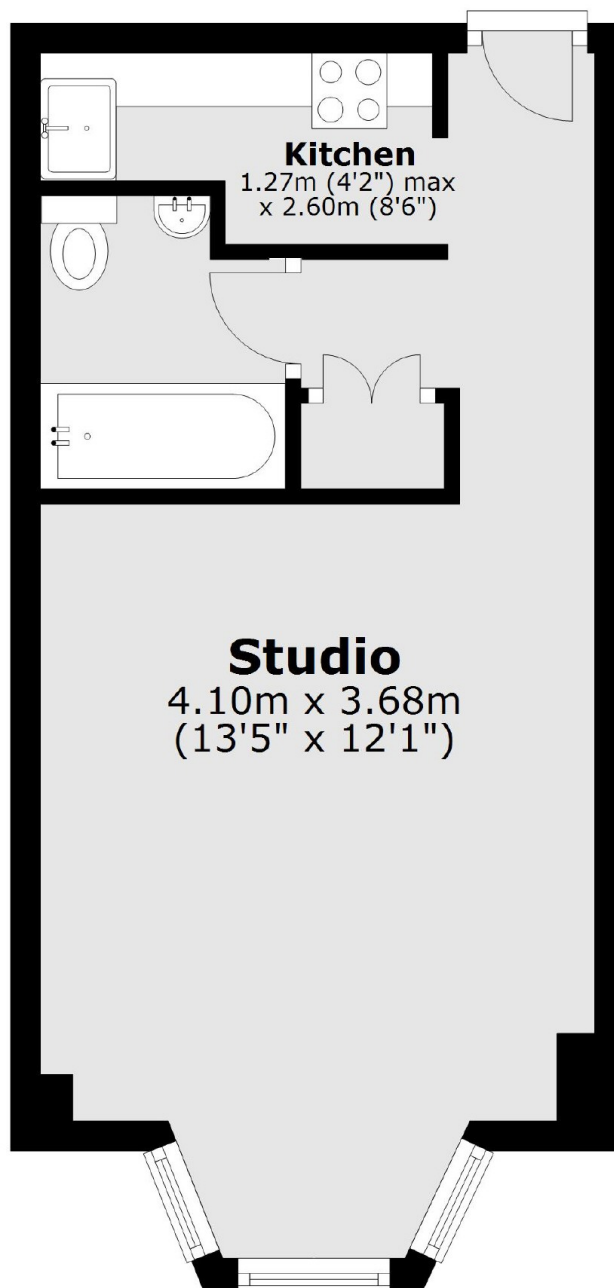

Total area: approx. 27.5 sq. metres (296.5 sq. feet)

Dexters

Bloomsbury
55-56 Coram Street
London
WC1N 1HB
Sales
020 7833 4466

Energy Rating: C. We aim to make our particulars both accurate and reliable. However they are not guaranteed; nor do they form part of an offer or contract. If you require clarification on any points then please contact us, especially if you're traveling some distance to view. Please note that appliances and heating systems have not been tested and therefore no warranties can be given as to their good working order.

 **RICS** | Regulated
Estate Agent
and Letting Agent

[dexters.co.uk](https://www.dexters.co.uk)