

Woburn Place, WC1H

£325,000

A well appointed studio apartment in the heart of Bloomsbury with a separate kitchen and has been recently renovated to a high standard throughout. This studio will suit any first time buyer or second home owner wanting excellent security.

Russell Court occupies a prominent position within central London which offers excellent transport links and good access to top restaurants, bars, shopping and Universities.

Features

- Studio Apartment
- Re-furnished Throughout
- Lift Access
- 24 Hr Porter
- Share of Freehold
- Offers in Excess of £325,000

Woburn Place, London, WC1H

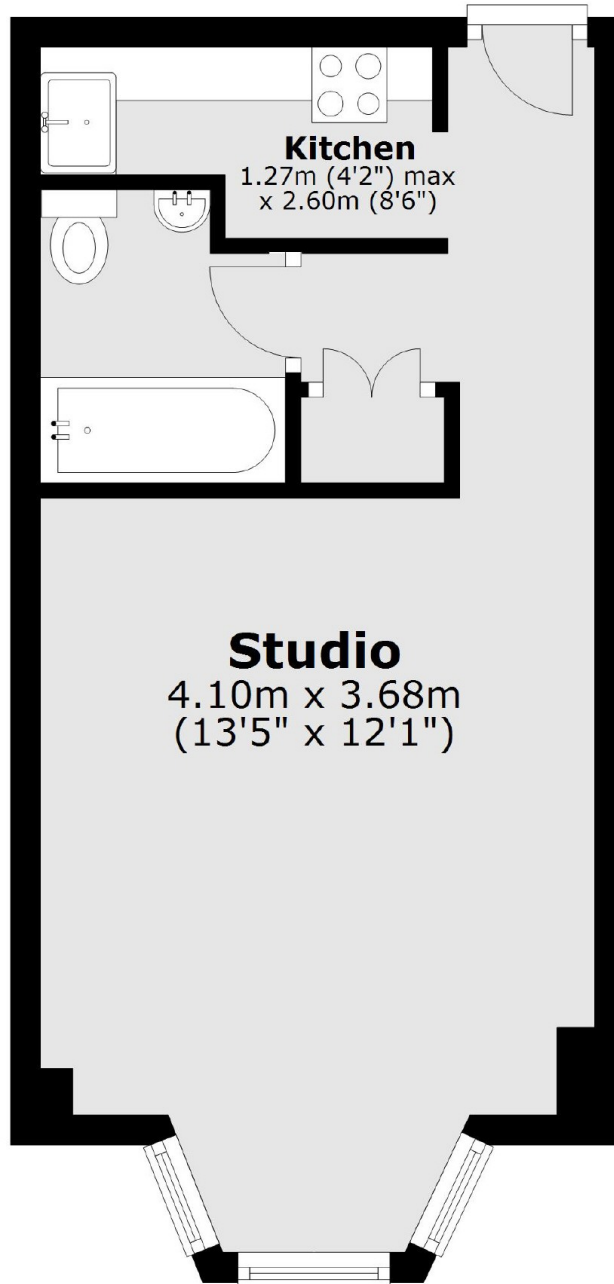

Total area: approx. 27.5 sq. metres (296.5 sq. feet)