



Chalton Street, NW1

£535,000

Centrally located and in excellent condition throughout, this one double bedroom home has a private, west facing balcony, built in storage, an open plan kitchen/living area and comes to market with no onward chain.

Centrally located and only a few minutes walk to Kings Cross and Euston stations, St Pancras and the Eurostar terminal, Chalton Street is well known for its weekly street market and has several international restaurants and cafes.

Features

- One Double Bedroom
- West Facing Balcony
- Excellent Condition
- Long Lease
- Close To Transport
- No Onward Chain

Chalton Street, London, NW1

Ground Floor

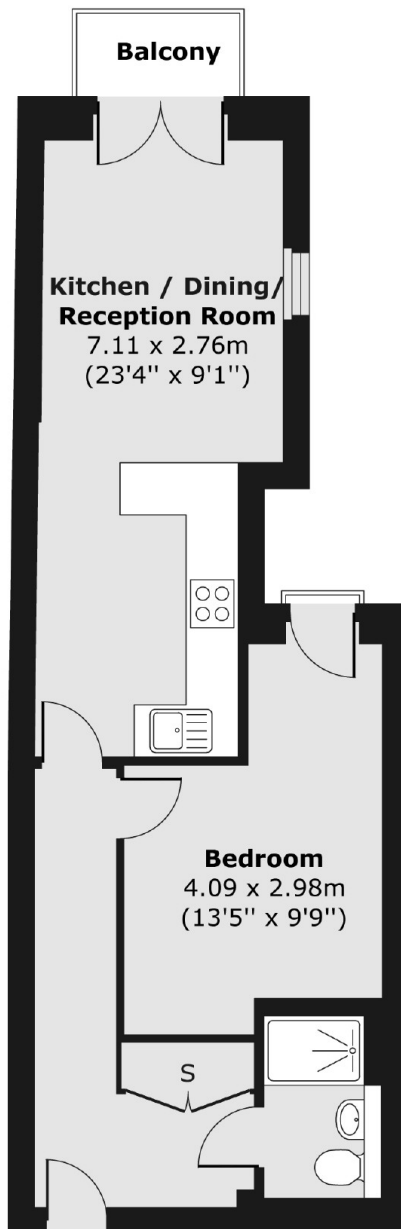

Total area (approx.) 41.74 sq. m (449 sq. ft)
Balcony area (approx.) 1.80 sq. m (19 sq. ft)