



Westking Place, WC1H

£675 Per week

An extremely well presented one bedroom apartment set within this newly built development. The property has a modern open plan kitchen with dining space, wooden flooring throughout and is finished to a very high standard.

Located in the heart of Bloomsbury just moments from the popular Brunswick shopping centre which has many shops and restaurants including a Waitrose supermarket. Just a short walk from Russell Square, Kings Cross and Euston stations.

Features

- Newly Built Development
- Open Plan Living
- High Quality Finish
- Wooden Flooring
- Modern Kitchen
- Excellent Location

Westking Place, London, WC1H

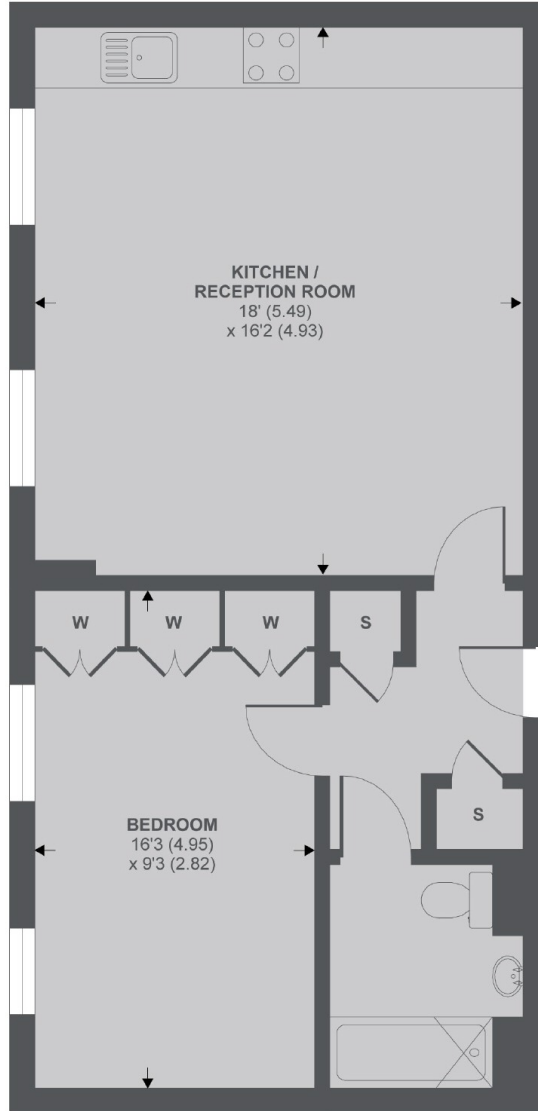

3rd Floor

Westking Place, WC1H

APPROX FLOOR AREA 558 SQ.FT 51.8 SQ.M

Copyright nichecom.co.uk 2018 REF : 314128

Dexters

Bloomsbury
55-56 Coram Street
London
WC1N 1HB

Lettings
020 7833 4488

Energy Rating: B. We aim to make our particulars both accurate and reliable. However they are not guaranteed; nor do they form part of an offer or contract. If you require clarification on any points then please contact us, especially if you're traveling some distance to view. Please note that appliances and heating systems have not been tested and therefore no warranties can be given as to their good working order.

 **RICS** | Regulated
Estate Agent
and Letting Agent

dexters.co.uk