



## Woburn Place, WC1H

£310,000

A newly refurbished studio apartment located in a 1930's development in central Bloomsbury. There is built in storage, a re-fitted shower room and kitchen with built-in appliances as well as a bay window.

Located just moments from Russell Square tube station and the Brunswick Centre with a Waitrose supermarket and many shops and restaurants. The West End and the Eurostar terminal at St Pancras are near by.

### Features

- Newly Refurbished
- Share Of Freehold
- 24 Hr Concierge
- Lift Access
- No Onward Chain
- Opposite Russell Square

# Woburn Place, London, WC1H

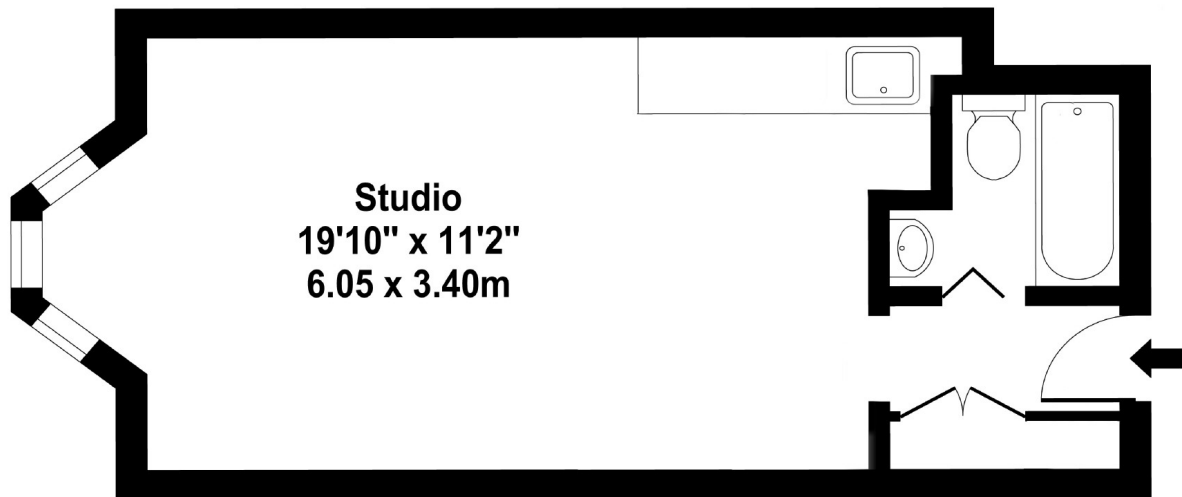

## FOURTH FLOOR

Approx Gross Internal Area **266 Sq Ft - 24.71 Sq M**

Whilst every attempt has been made to ensure the accuracy of the plan shown, all measurements, positioning, fixtures, fittings and any other data shown are an approximate interpretation for illustrative purposes only and are not to scale. No responsibility is taken for any error, omission, miss-statement or use of data shown.