



Woburn Place, WC1H

£265,000

A studio apartment in the well managed Russell Court development in Bloomsbury's Russell Square. The property is in excellent condition throughout and is offered with no onward chain.

Located just moments from Russell Square tube station and the Brunswick Centre with a Waitrose supermarket as well as many shops and restaurants. The West End and the Eurostar terminal at St Pancras are less than half a mile.

Features

- Studio
- 24-Hour Porter
- Share of Freehold
- Central Bloomsbury
- 3 Lifts
- Heating Included

Woburn Place, London, WC1H

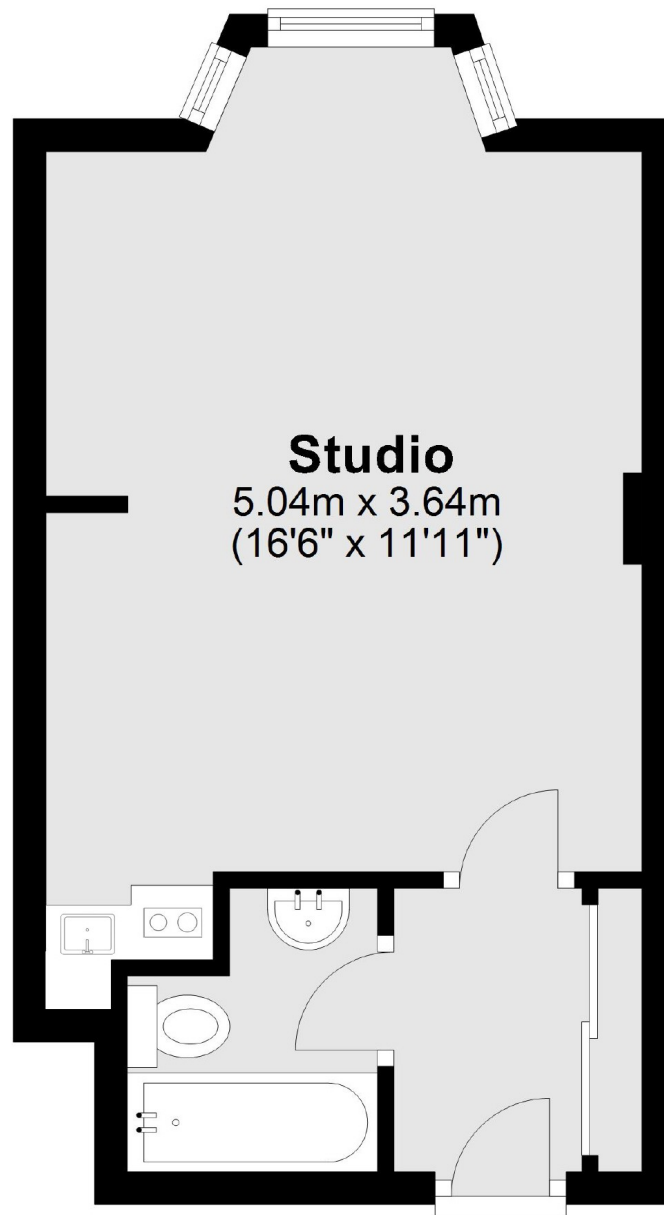

Total area: approx. 23.1 sq. metres (248.7 sq. feet)