



New Wharf Road, N1

£625 Per week

A very well presented two bedroom apartment on the ground floor of this popular waterside gated development. The property has wooden floors running throughout, a spacious living room and direct access to a communal courtyard.

Ice Wharf is within a short walking distance to King's Cross St. Pancras station with access to Metropolitan, Piccadilly, Victoria, Northern, Hammersmith & City, Circle lines and National & International Rail Services.

Features

- 24 Hour Concierge
- Gated Development
- Wooden Floors
- Communal Courtyard
- Natural Light
- Unfurnished

New Wharf Road,
London, N1

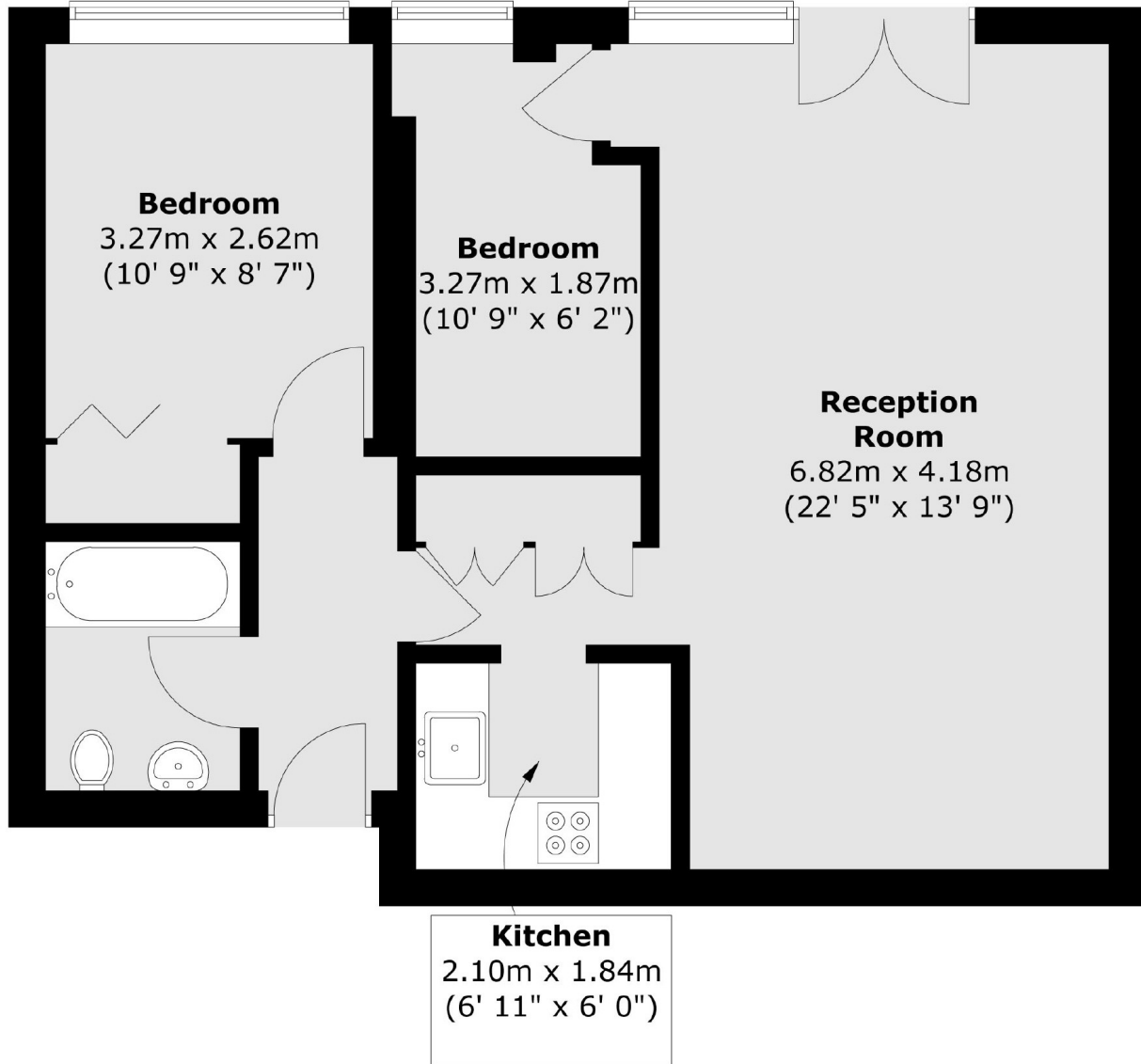

Total area (approx.) : 58 sq. m (624 sq. ft)