



## Sandwich Street, WC1H

£425,000

A one bedroom home within a period mansion block, there is a separate living room, re-fitted kitchen and bathroom, a double bedroom and access to an impressive residents only roof garden.

Sandwich House is a well regarded mansion block in the heart of Bloomsbury, there is an array of amenities including King's Cross to the north and Russell Square to the south.

### Features

- Period Mansion Block
- Separate Living Room
- Lift Access
- Communal Roof Terrace
- Share Of Freehold

Sandwich Street,  
London, WC1H

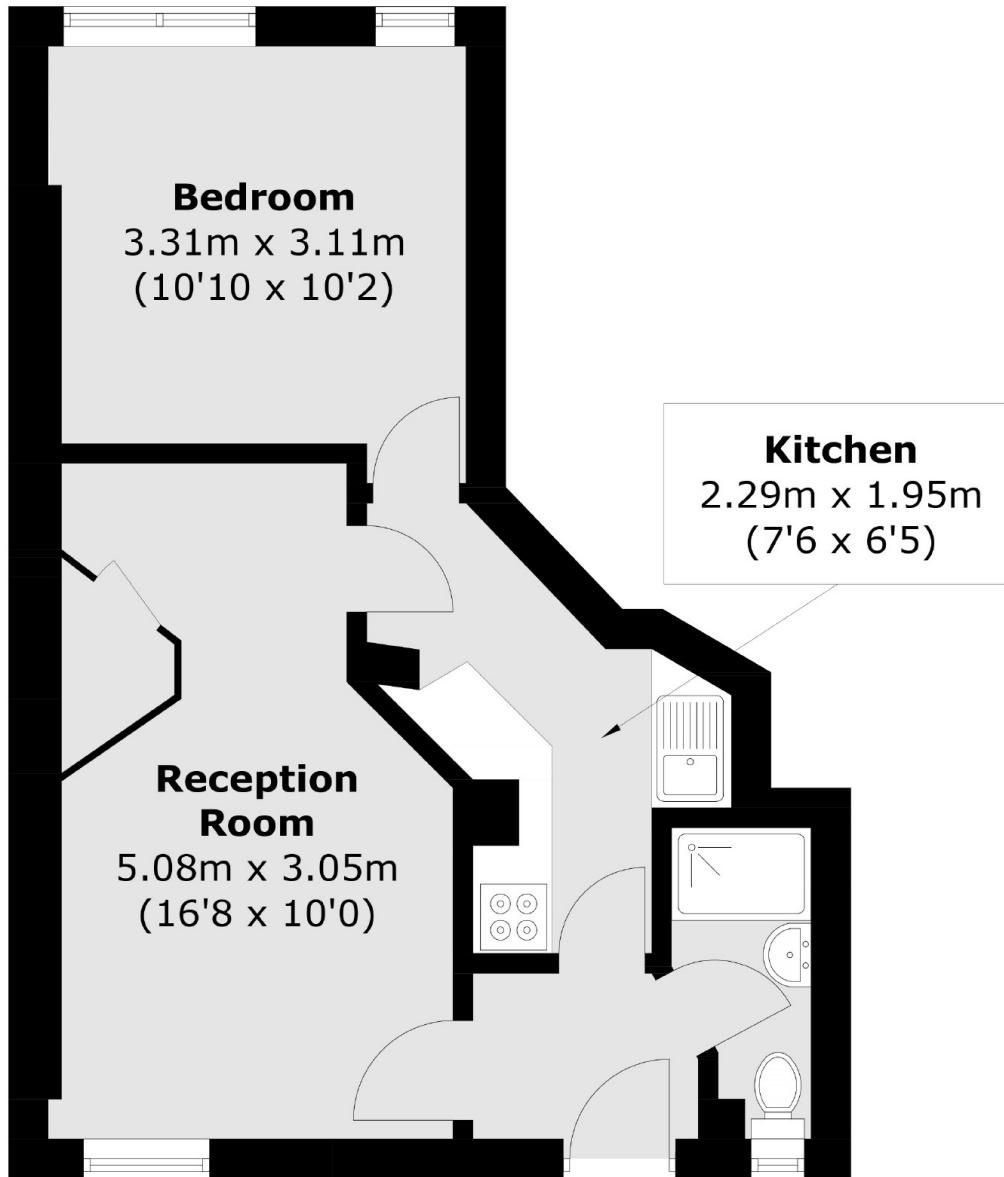

Total area (approx.): 34.7 sq. m (373.5 sq. ft)

**Dexters**

Bloomsbury  
55-56 Coram Street  
London  
WC1N 1HB  
Sales  
020 7833 4466

Energy Rating: C. We aim to make our particulars both accurate and reliable. However they are not guaranteed; nor do they form part of an offer or contract. If you require clarification on any points then please contact us, especially if you're traveling some distance to view. Please note that appliances and heating systems have not been tested and therefore no warranties can be given as to their good working order.

 **RICS** | Regulated  
Estate Agent  
and Letting Agent

dexters.co.uk