



Woburn Place, WC1H

£305,000

Located on the third floor with lift access, this beautifully finished studio apartment has a separate kitchen, built in work station with storage above, bay window and fold down bed. The property would make a perfect London base or main residence.

Located just off Russell Square there is easy access to tube stations the West End, Covent Garden and the Eurostar terminal at St Pancras. Also the Brunswick shopping centre with a Waitrose and many other shops and restaurants is just a moment away.

Features

- Share Of Freehold
- 24 Hr Concierge
- Lift Access
- Built In Furniture
- Excellent Condition
- Offers in Excess of £305,000

Woburn Place, London, WC1H

Third Floor

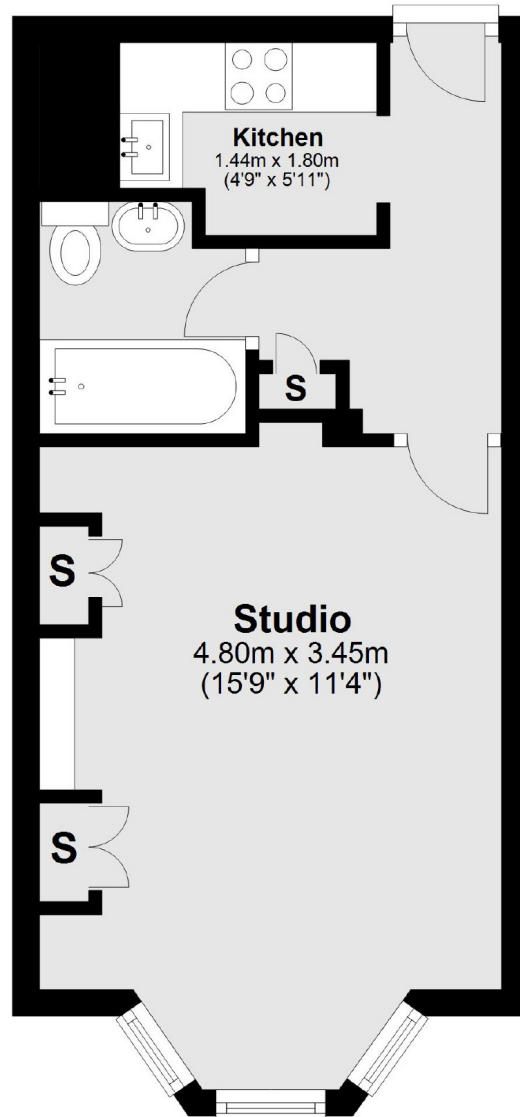

Total area: approx. 25.5 sq. metres (275.0 sq. feet)