



Spencer.

16, Bents Drive, Bents Green, S11 9RP

## Buy —

this beautifully presented four bedroom semi-detached family home in this highly sought after and well located suburb of S11, with excellent school catchment

— from *Spencer.*

- Superb four bedroom semi-detached family home
- Beautifully presented and maintained throughout
- Two reception rooms
- Modern dining kitchen
- Long, enclosed level rear garden
- Detached Single garage and ample driveway parking
- Freehold
- Council Tax Band - F
- EPC - C
- What three  
Words///target.lush.debit



Offers Around

**£630,000**



# Floorplan

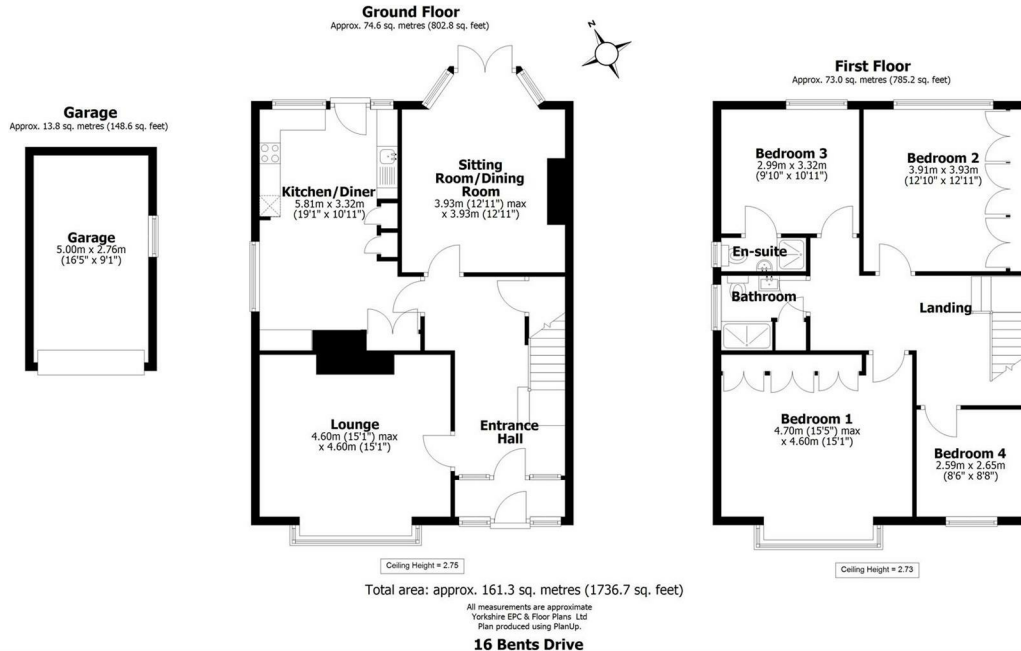

**Spencer.**

+44 (0)114 268 3682  
info@spencersestateagents.co.uk  
469 Ecclesall Road, Sheffield, S11 8PP  
SpencersEstateAgents.co.uk

**SpencersAgents**  
**SpencersAgents**  
**SpencersEstateAgents**

All enquiries and negotiations conducted via the Spencers office. We are obliged under the Estate Agent Act 1991 to qualify all offers and an independent mortgage consultant will speak to you to substantiate your details. The particulars are set out as a general outline only for guidance and do not constitute part of an offer or contract. Measurements are given in good faith and believed to be correct. Any prospective buyer should satisfy themselves as to the correctness of all statements and should not rely on them as representation of fact. no person in the employment of Spencers has any authority to make or give representation or warranty whatever in relation to this property.

Viewing: Via the Agents  
Spencers Agents Ltd, 469 Ecclesall Road, Sheffield S11 8pp | Registered in England No. 7565948