

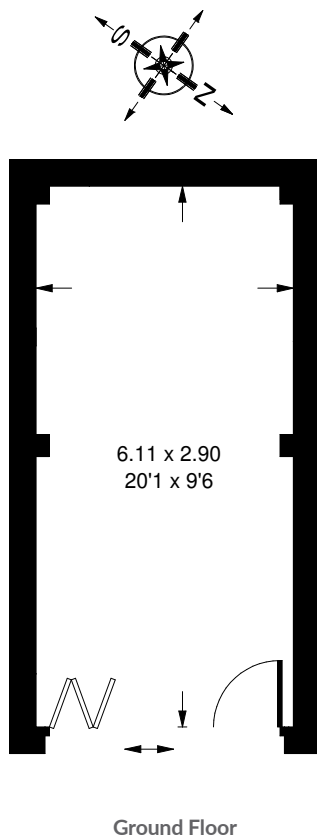

ALLEN MANSIONS

ALLEN MANSIONS





Approx. Gross Internal Area  
= 17.7 sq m / 190 sq ft



## Garage, Allen Mansions, W8 - Leasehold

Local Authority **Royal Borough of Kensington & Chelsea**

A opportunity to purchase secure garage with fob access via electric gates at street level and with further secured doors to the parking space. Situated beneath Allen Mansions, a well run apartment building set on this popular residential road which runs south from Kensington High Street down to Stratford Road.

- Fob entry system
- 190 square foot
- Close to Kensington High Street



Whilst every attempt has been made to ensure the accuracy of the floor plan, measurements are approximate and not to scale. No guarantee is given on the total square footage of the property quoted on the plan. Figures given are for guidance. Plan is for illustration purposes only, not to be used for valuations.

### LONDON OFFICES

Notting Hill • North Kensington • Kensington 020 8960 0181

### COUNTRY OFFICE

Cotswolds 01285 707222

[mountgrangeheritage.co.uk](https://mountgrangeheritage.co.uk)

[hello@mountgrangeheritage.co.uk](mailto:hello@mountgrangeheritage.co.uk)

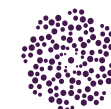

**MOUNTGRANGE**  
HERITAGE