

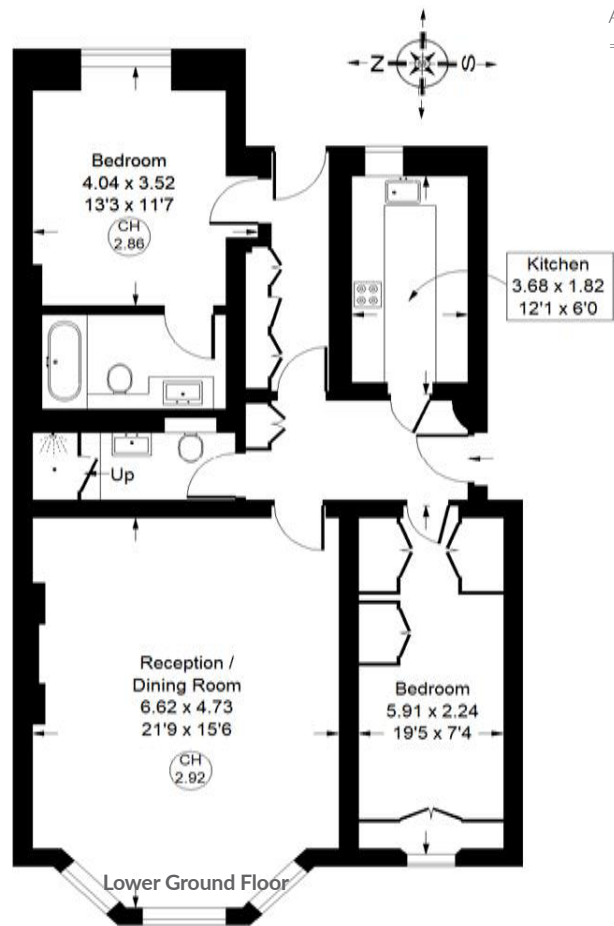

De Vere Gardens, W8



Approx. Gross Internal Area
= 88.2 m² / 949 ft²



De Vere Gardens, W8 Leasehold

Local Authority **Royal Borough of Kensington & Chelsea**

- Fantastic Location
- Portered Building
- Lift
- Well Presented
- Close to Hyde Park
- EPC: D
- Council Tax Band: D



Whilst every attempt has been made to ensure the accuracy of the floor plan, measurements are approximate and not to scale. No guarantee is given on the total square footage of the property quoted on the plan. Figures given are for guidance. Plan is for illustration purposes only, not to be used for valuations.