



LIZMANS TERRACE



Lizmans Terrace, Earls Court Road, W8

Set back from the road, this delightful two bedroom garden flat benefits from side access from Stratford Road and its own private entrance. The 963 sq ft (approx.) property is decorated in a neutral fashion and offers good natural light throughout. Accommodation includes: bright reception room with French doors onto the decked garden; contemporary kitchen; vast master bedroom with built-in wardrobes, a separate walk-in wardrobe and an en suite bathroom; second double bedroom with en suite shower room; guest cloakroom and a 30 ft private garden.



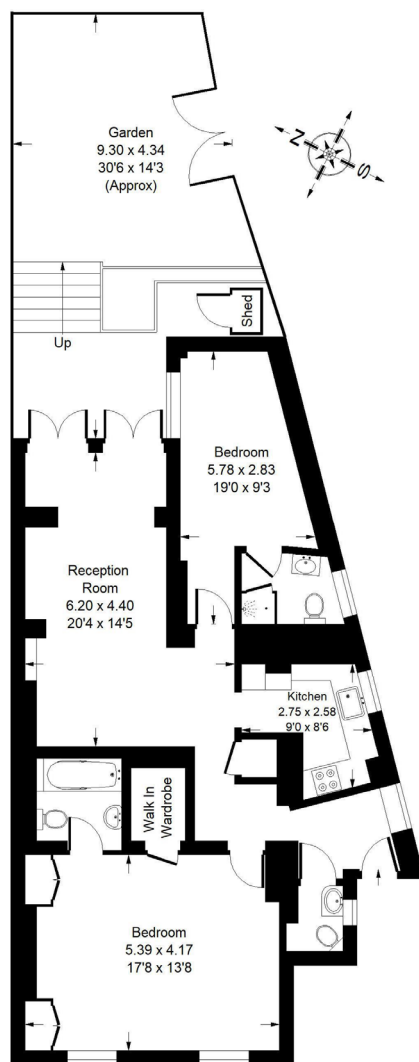

Approx. Gross Internal Area
= 89.5 sq m / 963 sq ft

Lower Ground Floor



Lizmans Terrace, Earls Court Road, W8 - Leasehold

Local Authority **Royal Borough of Kensington & Chelsea**

- Two bedrooms
- Two bathrooms
- Private entrance
- Garden
- EPC Rating: D
- Council Tax Band: F



Whilst every attempt has been made to ensure the accuracy of the floor plan, measurements are approximate and not to scale. No guarantee is given on the total square footage of the property quoted on the plan. Figures given are for guidance. Plan is for illustration purposes only, not to be used for valuations.

LONDON OFFICES

Notting Hill • North Kensington • Kensington 020 7937 9976

COUNTRY OFFICE

Cotswolds 01285 707222

mountgrangeheritage.co.uk

hello@mountgrangeheritage.co.uk



MOUNTGRANGE
HERITAGE